

2003 EAGLE TOWABLES & EAGLE COVE PARK TRAILERS BY JAYCO



263 RKS interior



Jayco® was proud to participate in and serve as the official recreational vehicle of The Park Programs/Summer-Fun Sweepstakes in 2002, involving our nation's National Parks.

Step up to the next level of travel convenience and style

Your family has made quite a few discoveries during your travels. Buying your new favorite hiking boots in Yellowstone after forgetting your old favorites. Taking your first unforgettable mountain getaway in Banff. Finding a marmot hiding under your hood after leaving King's Canyon National Park. Now it's time to find a better way to travel. After 35 years of building family fun, Jayco® delivers the newest Eagle™ travel trailers and fifth wheels ... your family's

next step on the road to even greater discoveries.

Step inside Eagle fifth wheel and take your first look at a new level of comfort, beauty and convenience. Relax in the optional **rocker recliner** or **swivel rocker** (most models) or in the soft **J-Steel™ sofa** and listen to the **bookshelf AM/FM 5-CD/dual cassette stereo with four speakers**. In the kitchen, you'll see beautiful touches right out of the home such as our **Fairfield Oak cabinetry, residential-style mixing faucet, deep**

residential-style sink and color-coordinated countertops. Eat dinner at the **dinette slideout with end wall slider windows** that give you great air flow. In the bathroom, the **wood medicine cabinet with mirror, 12V power vent with frosted lens** and optional **skylight** make home a little closer. At bedtime, rest easy on the **queen bed with innerspring mattress** that **lifts easily on struts** for storage below.



◀ Get your choice of sleeping arrangements with a standard queen bed, optional twin beds (some models) and bunk beds (some models) for your kids.

▲ New sliders on living room slideout end wall windows let in more air for better cross ventilation. And the slideout is flush with the main floor, so you won't have to step or trip over the edge.

▲ Dine in style and spacious comfort at the slideout dinette, which offers convenient optional storage beneath and in the beautiful standard oak overhead cabinets. Freestanding table and chairs are optional.

▶ The bathroom gives you more than just the basics with an ABS shower/tub surround or garden tub and optional bi-fold shower door or optional glass shower door.

▼ In the kitchen, beautiful Fairfield Oak cabinets have the strength to last. We build cabinet doors using traditional, strong mortise-and-tenon joints. And we use real-wood drawers, not plastic tubs. Attractive raised-panel oak doors are standard for kitchen overhead cabinets and optional for the refrigerator and lower cabinets.



305 BHS

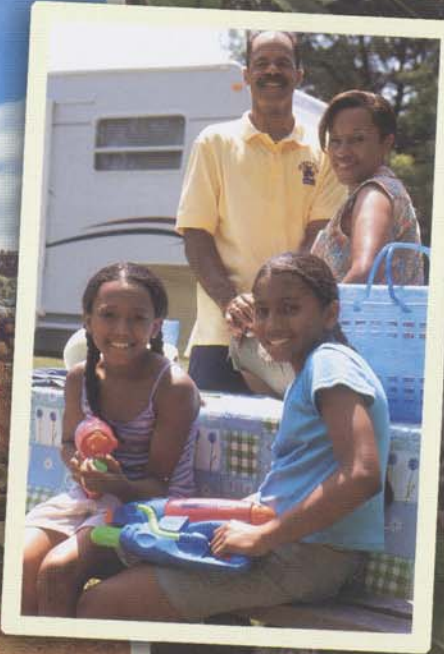

Eagle™ Fifth Wheels

Step up to greater accommodations

We build Eagle™ fifth wheel trailers to accommodate your family's needs no matter where you go or what you bring along. Gain ample storage for all your things in the large **front trunk** and the **lockable side storage trunks with radius corners and grab handles**. You also gain a **side storage** compartment for two LP gas bottles. The **Filon® Plus baggage and entrance doors** are smoother and better looking than regular fiberglass. Our **WideTrak™ front landing gear**

creates even more storage space up front. And our **Jake Plate™ axle hanger plates** accommodate the height of your tow vehicle.

To accommodate you down the road, the optional **high-gloss Gel-Coat fiberglass exterior sidewalls with front cap** and optional **rubber roof** resist dents and the elements. Optional larger **16" tires** give you peace of mind. The optional patio awning lets you rest comfortably and enjoy your newfound freedom.



◀ Store loads of gear such as coolers and lawn chairs in the front trunk so you won't have to expose your things to the elements or take up valuable inside space.

◀ The exterior storage compartments give you plenty of space, and convenient pass-through access on some models makes room for longer items such as fishing poles or water skis. The Filon® Plus baggage doors are super smooth and look great.

▲ Choose from a number of slideout models to expand your living space.



◀ Eagle fifth wheel gives you added storage space and easy access for two LP gas bottles in the side compartment.

▼ No need to worry about the height of your tow vehicle. Eagle fifth wheels feature Jake Plate™ adjustable axle hanger plates, allowing you to adjust the axle height to accommodate different tow vehicles. And the upper deck is high enough to compensate for today's tall 4X4s.

▼ Our WideTrak™ front landing gear moves the jacks outward, giving you extra front storage space and room for a convenient side-mount LP gas tank compartment, as well as more interior floor space. The jack position also creates a more stable and reliable base and makes them easier to reach for inspection and maintenance.

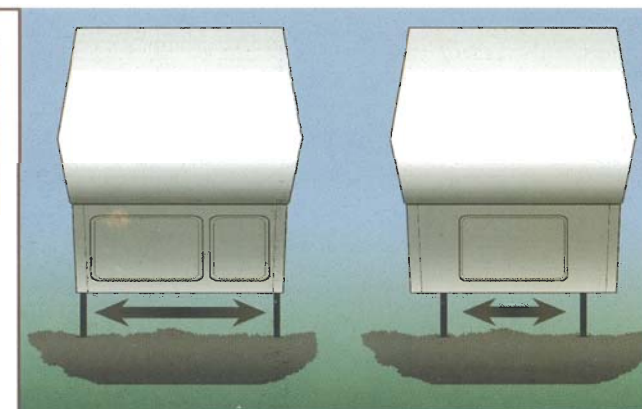
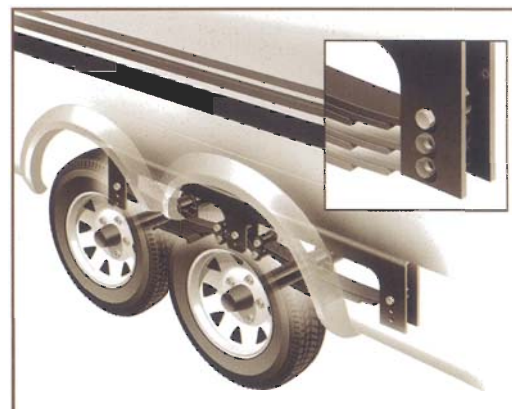

314 BHS interior

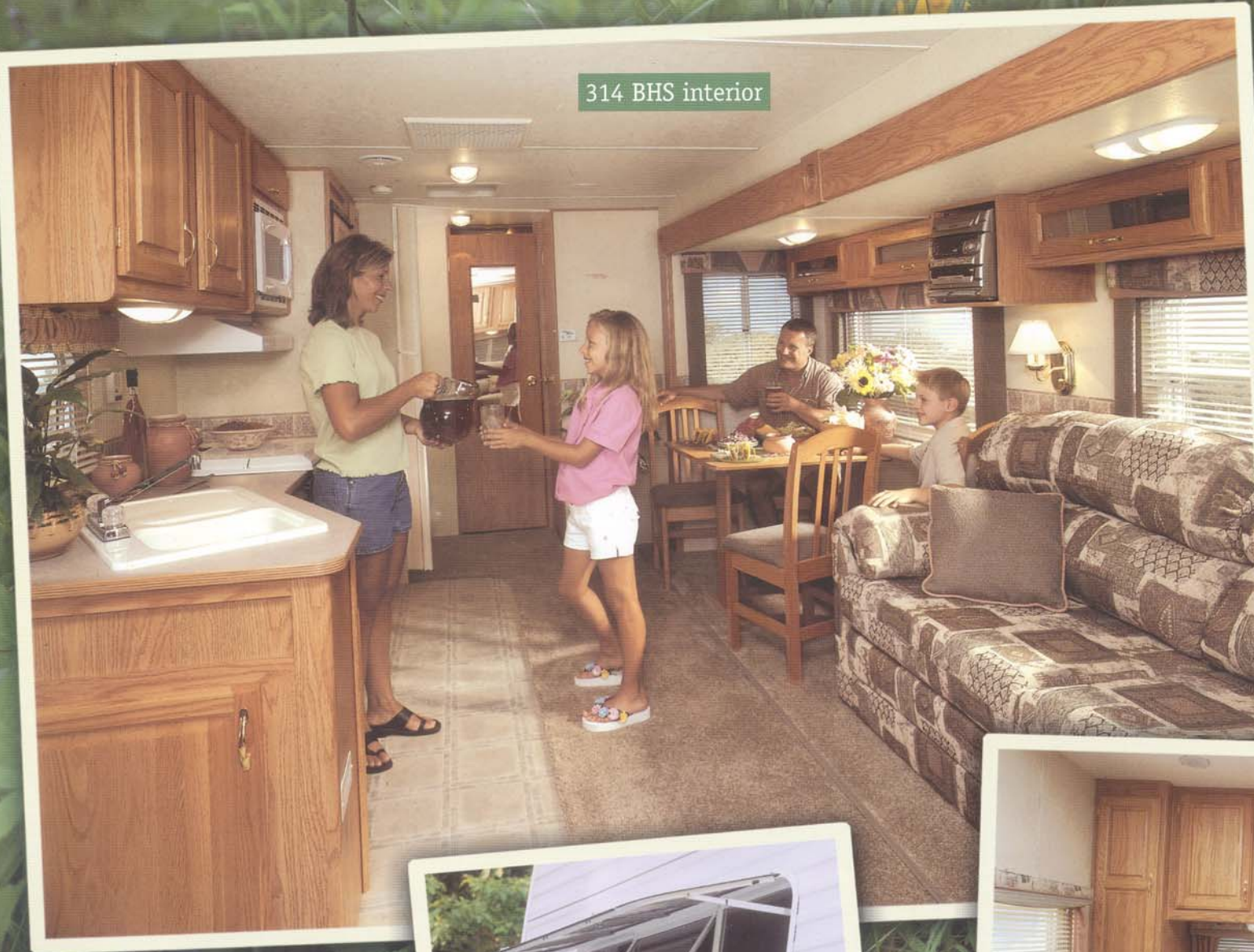

Step up to a travel trailer that blends comfort with toughness

Discover a new level of plush elegance for an affordable price in Eagle™ travel trailer. The interior surrounds you with warm touches such as window treatments with **full-length, color-coordinated box valances with lambrequins** and **mini blinds** that add to its beauty. Our **Fairfield Oak flat-panel doors and drawers with raised-panel overhead cabinet doors** add richness you won't find anywhere else. When it's time to rest, the **J-Steel™ convertible sofa** or optional **hide-a-bed sofa with footrest** cradle you. In the bedroom, the

▶▶ The optional hide-a-bed sofa with dual foot rests lets you stretch out after a long day hiking. When it's time to turn in, the sofa converts to a comfortable bed, perfect for overnight guests. And the sofa sits on a slideout that is flush with the main floor, so you won't have to step or trip over the edge.

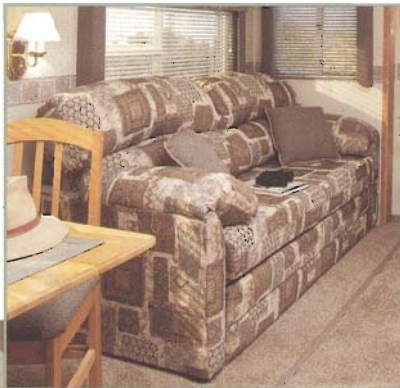

◀ The front window features a stone guard to protect it from road debris during your travels and opens for better ventilation.

◀ Feel at home in the beautifully furnished bedroom, complete with warm oak cabinetry, coordinated, quilted bedspread and carpet with thick padding.

bunk over double bed option (304 BH) gives you and your kids more room.

You'll also discover a new level of durability. Your Eagle travel trailer can withstand tough travels with exterior features such as the **recessed, opening, fiberglass window stone guard** and **ABS double LP gas bottle cover** in the front and optional **rear stone guard window awning** (most models) in the rear. Optional **shock absorbers** smooth out bumps along the way.



▼ Your Eagle travel trailer will look great no matter where you go with features such as white, radius-cornered awning windows, 30" door frame and colored radius skirting.



Step up to a host of extras that make your travels more enjoyable

Whether you choose Eagle™ fifth wheel or travel trailer, you'll discover a new wealth of possibilities in your travels. After a long day on the lake, pan-fry some trout on the **3-burner range with 9,000-BTU SuperBurner™, piezo igniter and range hood with light and fan**. Grill burgers on the optional **outside portable barbecue grill**. Or, cook in the **Panasonic® Inverter microwave** or on the optional **outside stove**. For dessert, bake cookies in the **oversized oven**. Get clean, clear water anytime with the optional **water purifier**. Then store leftovers in the **flush-mounted, double-door refrigerator**, which features electronic

diagnostics so you can monitor its performance.

Open up your destination possibilities with features such as **auto-ignition furnace with thermostat, in-floor ducted heating and 13,500-BTU central air conditioner** that let you stay comfortable when the weather doesn't cooperate. Bring along the whole family with **bunk beds**, available in select Eagle travel trailer and fifth wheel models. Your kids can bring along their stuff in the optional **KidStuff™ bunk organizers**. Wherever you end up, the optional **exterior folding grab handle** makes getting out to enjoy it easier.

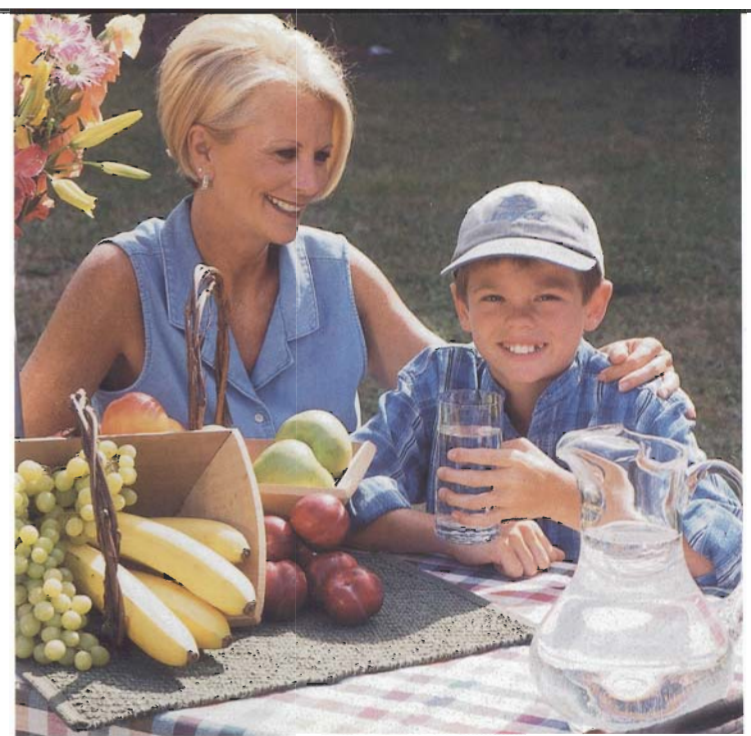

▲ Get consistent-tasting drinking water with the optional water purifier, which is built-in so you won't have to mount one outside.



◀ Our optional portable gas barbecue grill lets you get that great grilled flavor. And it comes with a handy carrying case.

▲ The standard Panasonic® Inverter microwave oven with carousel lets you cook food faster and more evenly than standard microwave ovens.

▶ Simply plug in the optional portable 2-burner stove outside for an outdoor dinner.



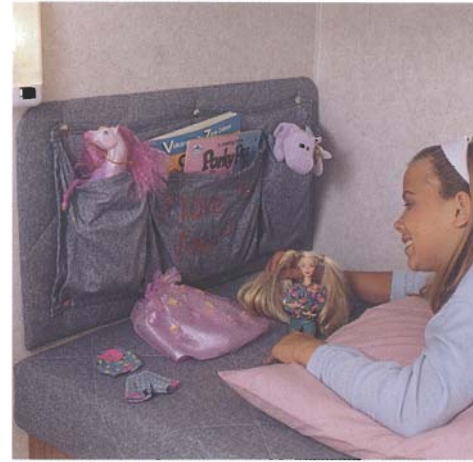

◀ Give your kids their own space without sacrificing interior room with a bunkhouse model (274 BHS, 304 BH and 314 BHS travel trailers and 305 BHS, 325 BHS and 285 BHS fifth wheels).

◀ The optional oversized entrance door exterior grab handle makes stepping in easier, and folds down and out of the way when not in use.

◀ You can also choose optional KidStuf™ bunk organizers to give kids a place for their toys, books and other items.

Components of Eagle™ Premium Upgrade Package Option:



Bedroom AM/FM Clock Radio



Fluorescent Lighting Above Kitchen Sink



Telephone (12-Volt Cell Phone Outlet Also Included)



Bathroom Hair Dryer



Fairfield Oak Knife Holder Behind Range And Fairfield Oak Spice Rack



Fairfield Oak Paper Towel Holder



Upgrade Valances



Fairfield Oak Interior Grab Handle



Fairfield Oak Trim For Entrance Door



Rechargeable Flashlight



Rechargeable Wet/Dry Vacuum



Sofa Brass Lighting



Dinette Brass Lighting



Upgrade Kitchen Faucet

Step up to fewer worries and more freedom

We build Eagle™ travel trailers and fifth wheels tough so you can keep your mind on your vacation and not on maintenance.

Rotocast holding tanks eliminate welds so they don't leak like welded tanks can. **Fresh water tanks are placed below the floor** to add more storage space. The **PolyFlex™ underbelly** is lighter than metal but more puncture- and tear-resistant and guards against the outside elements. Also underneath, the **SuperSlide™ slideout with PowerDrive™ mechanism** is

built stronger than other systems to work smoothly for years. **Snap and electric front jacks** keep everything steady. And **E-Z Lube® axles** let you grease the axles quickly and without fuss.

We also build Eagle travel trailers and fifth wheels to keep you comfortable. Optional **attic fans** give you soothing fresh air or exhaust stale air. The optional **outside shower** lets you clean off after a long day outside, and the **retractable double or triple entrance step** makes getting in and out easy.

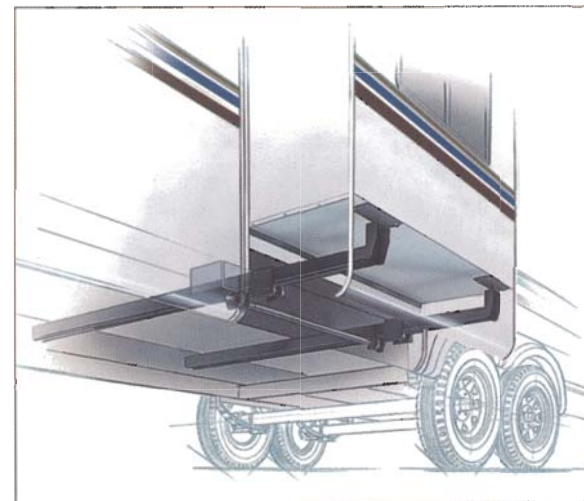

▶ **Front landing gear, moved to the outer corners, provide a stable base.** Eagle fifth wheel offers both electric front jacks and snap jacks.

▶ **New E-Z Lube® axles with removable caps make maintenance simple.**

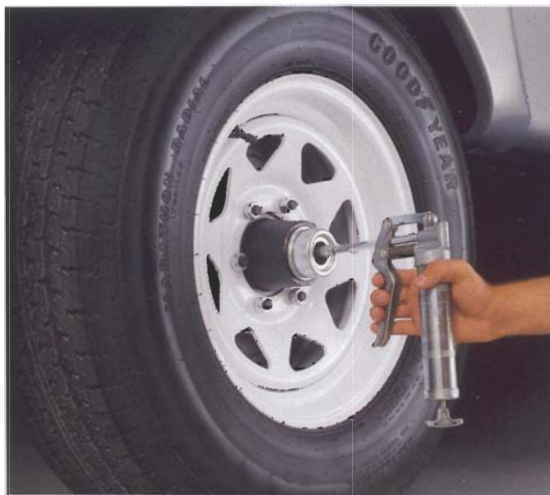

▶ **Simply push a button and the SuperSlide™ slideout expands the living space of your Eagle travel trailer or fifth wheel.** The super-strong system uses a 12" stacked tubular steel frame with a beam header that's three times stronger than any in the industry so it won't warp and hamper the slideout operation. Our PowerDrive™ mechanism consists of a rack-and-pinion drive, low-friction gearing and a high-torque electric motor that uses only 10 amps, so it won't wear down your battery.

▼ **You also get sure footing with the retractable triple entrance step (double step on non-slideout models).**



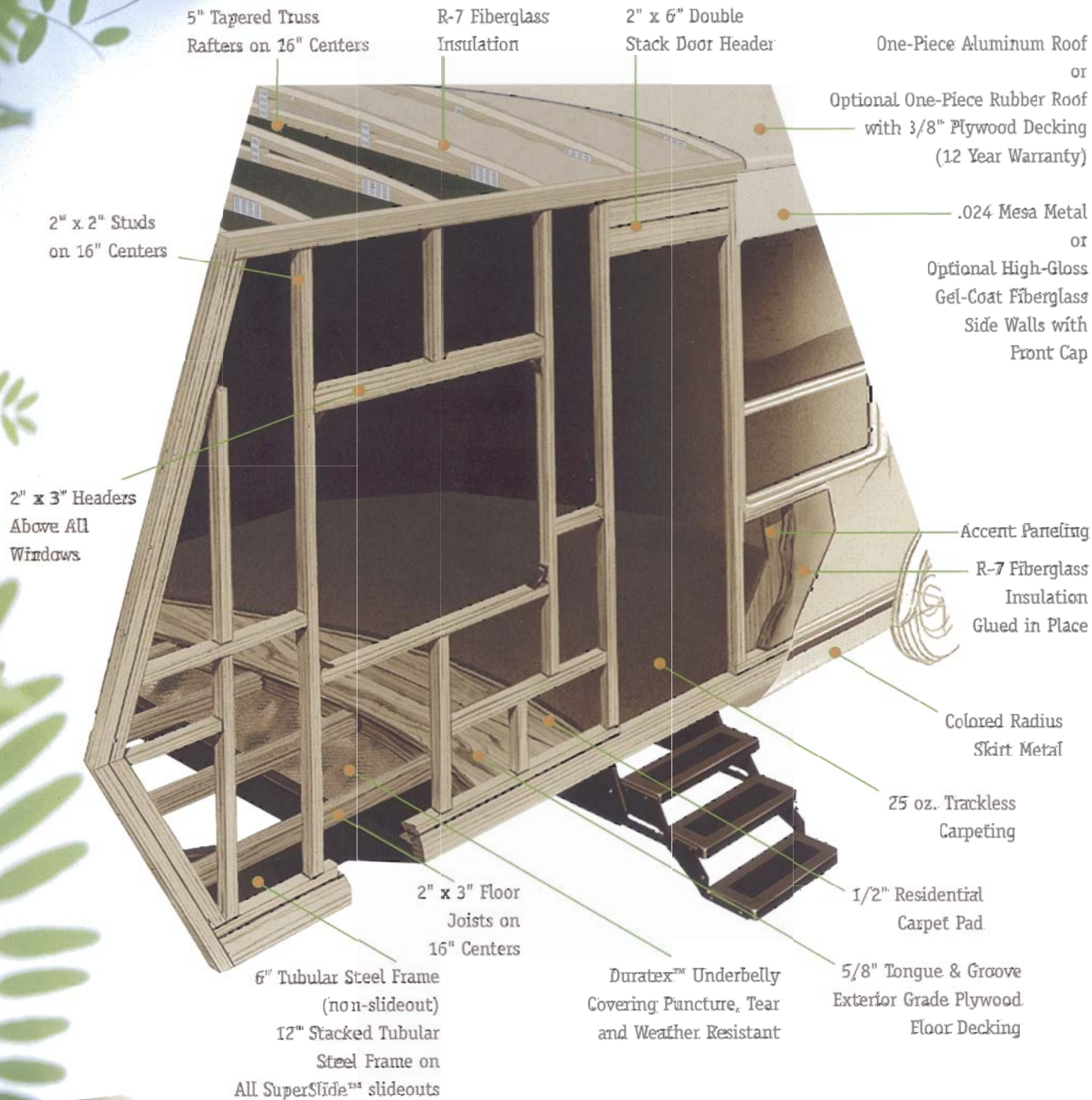

◀ Eagle™ travel trailers and fifth wheels feature stronger, more rigid frames than other manufacturers. That's because we use wall studs set on 16" centers, much closer than the 24" centers used by others. And the walls are anchored on top of the floor rather than the sides to better support the sidewall weight.

▼ Enjoy fresh air using the optional reversible thermostat-controlled Fantastic® attic fan.

▼ The optional outside shower includes hot and cold faucets, rugged ABS plastic hose and shower head.

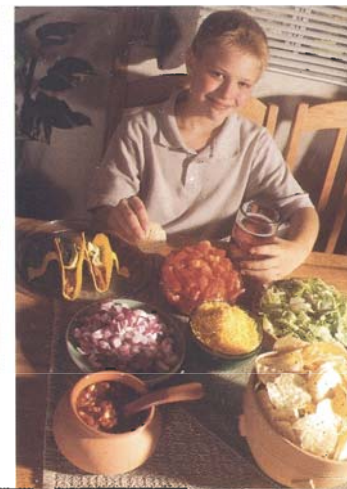

2003 Eagle™ Travel Trailers Floorplans — Continued

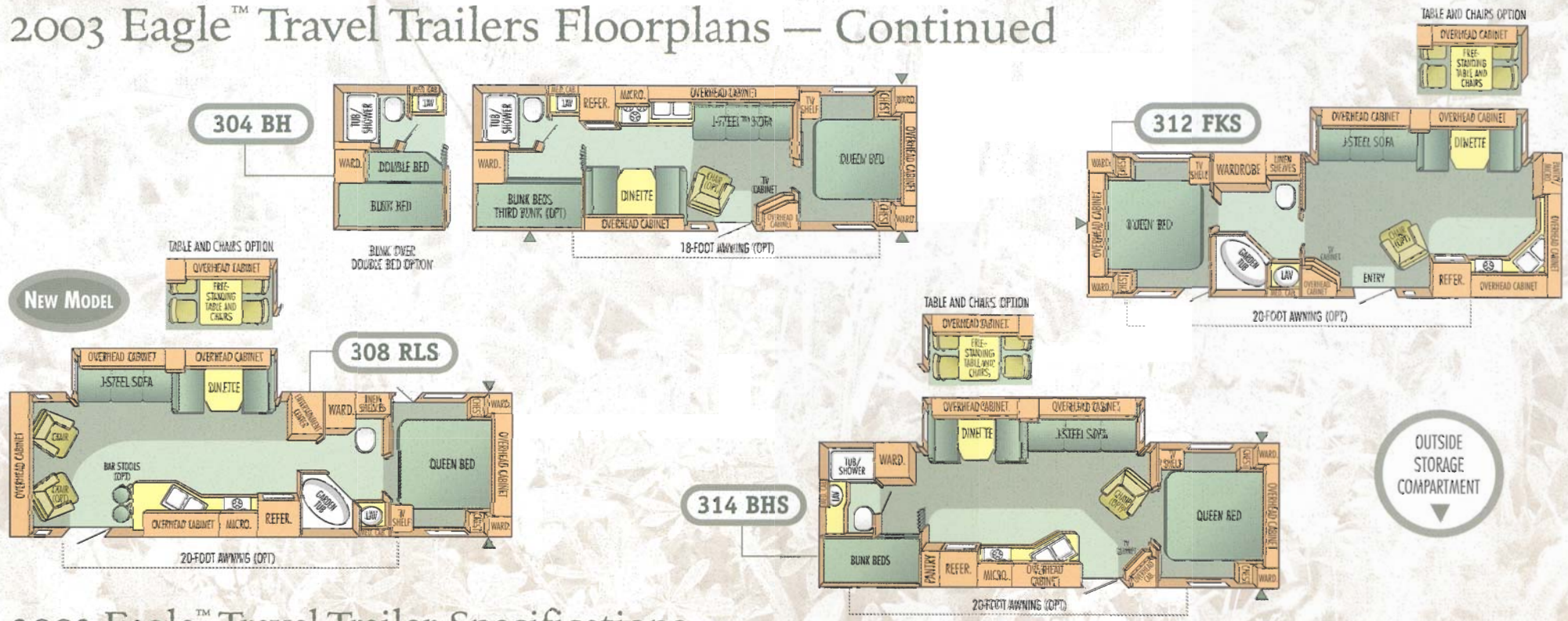

2003 Eagle™ Travel Trailer Specifications

Models	Exterior Length	Exterior Height	Bedroom Interior Height	Unloaded Vehicle Weight (lbs.)	Dry Hitch Weight (lbs.)	Gross Vehicle Weight Rating (lbs.)	Cargo Carrying Capacity (lbs.)	Fresh Water Capacity [^] (gals.)	Gray Wastewater Capacity (gals.)	Toilet/Black Wastewater Capacity (gals.)
266 FBS	28'-4"	135"	81"	6170	725	8500	2330	54	45	45
272 FKS	28'-11"	135"	81"	6710	1120	9000	2290	54	90	51
274 BHS	28'-11"	135"	81"	6270	815	9000	2730	54	45	45
296 FBS	30'-11"	135"	81"	6685	770	9400	2715	54	80	45
300 FSS	32'-6"	135"	81"	7200	760	9900	2700	54	45	45
302 FK	30'-6"	125"	81"	5320	685	7600	2280	58	30	30
304 BH	30'-6"	125"	81"	5155	815	7600	2445	58	30	30
308 RLS	33'-4"	135"	81"	7065	930	9900	2835	54	45	45
312 FKS	31'-11"	135"	81"	7125	885	9900	2775	54	80	45
314 BHS	31'-6"	135"	81"	6745	860	9400	2655	54	45	45

[^]Includes Water Heater

Unloaded Vehicle Weight (UVW): Sometimes referred to as "Dry Weight," UVW means the typical weight of this trailer as built at the factory. The UVW, as used in product literature and other promotional materials, does not include cargo, fresh water, LP gas, options or dealer-installed accessories.

Gross Vehicle Weight Rating (GVWR): GVWR means the maximum permissible weight of the trailer, including the UVW plus passengers, personal items, all cargo, fluids, options and dealer-installed accessories. The GVWR is equal to or greater than the sum of the UVW and the CCC.

Cargo Carrying Capacity (CCC): CCC means the maximum weight of all passengers, personal items, food, fresh water, LP gas, tools, other cargo and dealer-installed accessories that can be carried by the trailer. CCC is equal to or less than GVWR minus UVW. The addition of options will decrease the CCC.

It is important for your safety and enjoyment that your tow vehicle be adequately sized and equipped to tow and handle the GVWR of the RV you select. Review weights and rating of your tow vehicle and consult a competent advisor for questions or advice. Whether you are new to RVing

or a veteran, get a feel for the performance of your tow vehicle and the RV together before heading out on the roadways. **When you tow an RV, you must drive differently than you do when driving a single vehicle.** Practice hooking up, driving, backing up and braking in a safe environment or seek out professional instruction.

See specification chart above. Jayco affixes a weight label to each new RV which lists weight information for that vehicle.

2003 Eagle™ Fifth Wheels Floorplans

TABLE AND CHAIRS OPTION



243 RKS

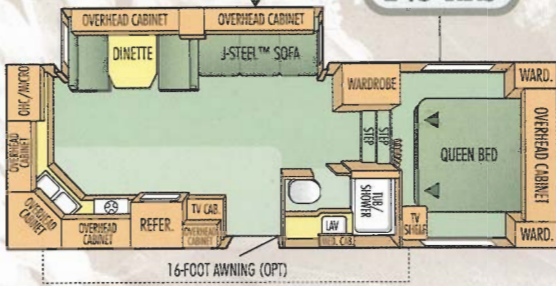

TABLE AND CHAIRS OPTION



251 RLS

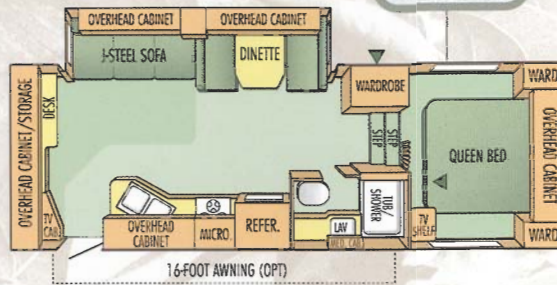

TABLE AND CHAIRS OPTION



263 RKS

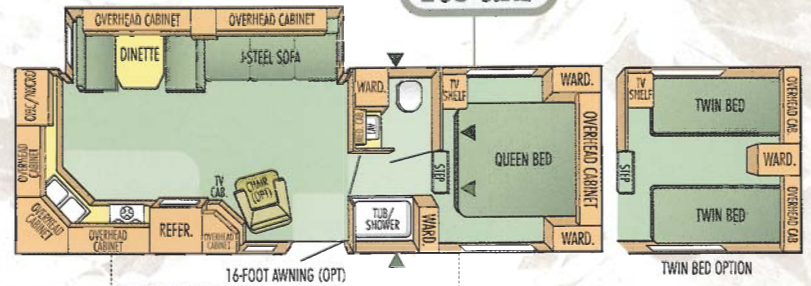
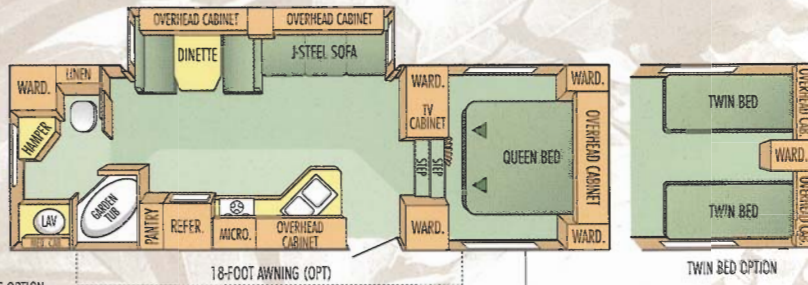

TABLE AND CHAIRS OPTION



277 RBS



OUTSIDE STORAGE COMPARTMENT

285 BHS

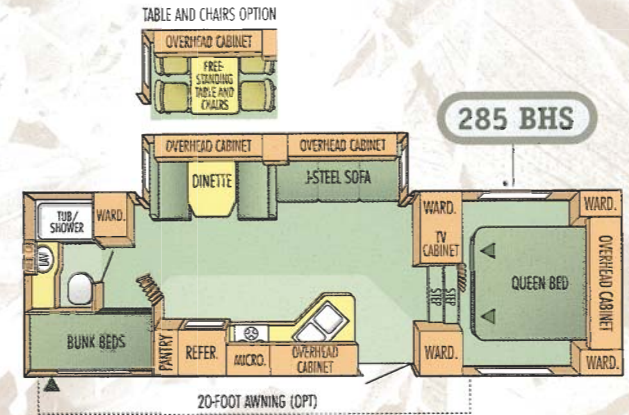
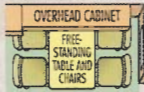

TABLE AND CHAIRS OPTION



281 RLS

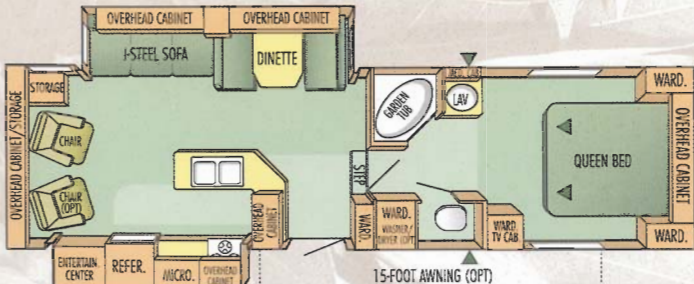
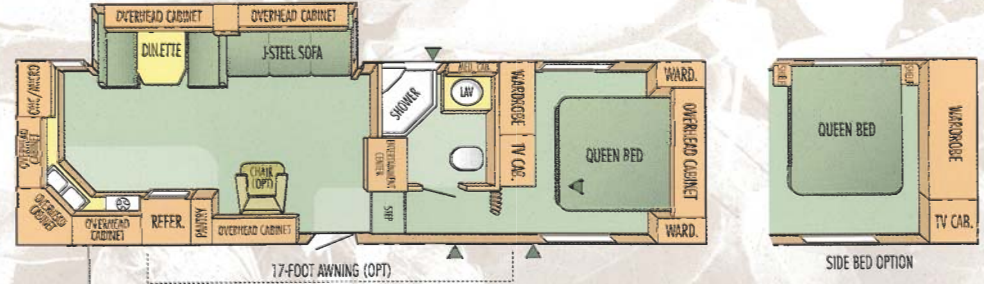

TABLE AND CHAIRS OPTION



303 RKS



NEW MODEL

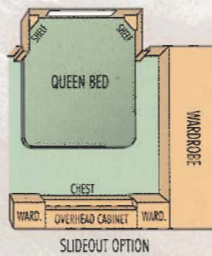

SLIDEOUT OPTION

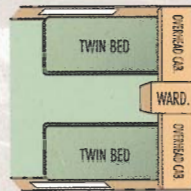

TWIN BED OPTION

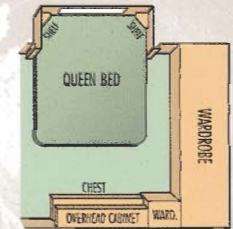

SLIDEOUT OPTION

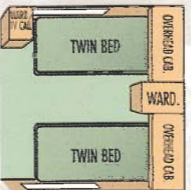

TWIN BED OPTION



2003 Eagle™ Fifth Wheels Floorplans — Continued

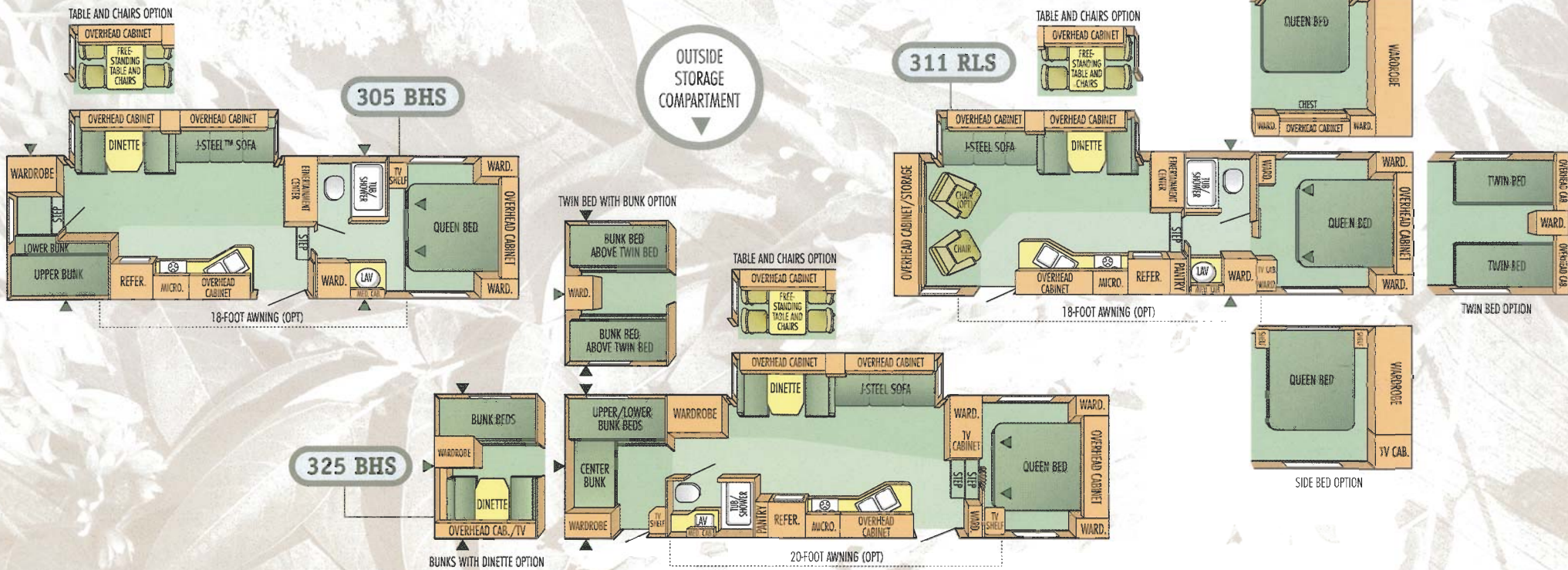

2003 Eagle™ Fifth Wheel Specifications

Models	Exterior Length	Exterior Height	Bedroom Interior Height	Unloaded Vehicle Weight (lbs.)	Dry Hitch Weight (lbs.)	Gross Vehicle Weight Rating (lbs.)	Cargo Carrying Capacity (lbs.)	Fresh Water Capacity [^] (gals.)	Gray Wastewater Capacity (gals.)	Toilet/Black Wastewater Capacity (gals.)
243 RKS	27'-1"	144"	59"	6595	1340	9400	2805	54	80	45
251 RLS	27'-1"	144"	59"	6750	1545	9400	2650	54	45	45
263 RKS	28'-11"	147"	63"	7120	1175	9995	2875	54	64	35
277 RBS	28'-0"	147"	63"	6945	1185	9995	3050	54	35	45
281 RLS	32'-7"	147"	72"	8700	1785	12,000	3300	54	70	35
285 BHS	30'-0"	147"	63"	7280	1215	9995	2715	54	35	35
303 RKS	32'-10"	147"	72"	8090	1620	11,500	3410	54	91	48
305 BHS	32'-5"	147"	77"	8095	1295	11,500	3405	54	80	45
311 RLS	31'-11"	147"	72"	8185	1715	11,500	3315	54	64	35
325 BHS	34'-1"	147"	72"	8315	1710	12,000	3685	54	74	45

[^]Includes Water Heater

Unloaded Vehicle Weight (UVW): Sometimes referred to as "Dry Weight," UVW means the typical weight of this trailer as built at the factory. The UVW, as used in product literature and other promotional materials, does not include cargo, fresh water, LP gas, options or dealer-installed accessories.

Gross Vehicle Weight Rating (GVWR): GVWR means the maximum permissible weight of the trailer, including the UVW plus passengers, personal items, all cargo, fluids, options and dealer-installed accessories. The GVWR is equal to or greater than the sum of the UVW and the CCC.

Cargo Carrying Capacity (CCC): CCC means the maximum weight of all passengers, personal items, food, fresh water, LP gas, tools, other cargo and dealer-installed accessories that can be carried by the trailer. CCC is equal to or less than GVWR minus UVW. The addition of options will decrease the CCC.

It is important for your safety and enjoyment that your tow vehicle be adequately sized and equipped to tow and handle the GVWR of the RV you select. Review weights and rating of your tow vehicle and consult a competent advisor for questions or advice. Whether you are new to RVing

or a veteran, get a feel for the performance of your tow vehicle and the RV together before heading out on the roadways. When you tow an RV, you must drive differently than you do when driving a single vehicle. Practice hooking up, driving, backing up and braking in a safe environment or seek out professional instruction.

See specification chart above. Jayco affixes a weight label to each new RV which lists weight information for that vehicle.

2003 Eagle™ Travel Trailers and Fifth Wheels Standards and Options

STANDARD EXTERIOR FEATURES

Stabilizer jacks (slideout models)
15" Goodyear® radial tires
* E-Z Lube® axles
Radius lockable storage compartments w/grab handles
PolyFlex™ underbelly covering
Recessed fiberglass stone guard on front window (travel trailers)
Retractable triple entrance step (double step on non-slideout models)
12V hitch light
Patio light w/inside switch
30" white-framed radius fiberglass main entry door (most models)
White radius-cornered awning windows
Dead bolt lock on entrance door
Hitch safety chains (travel trailers)
ABS double LP bottle cover (travel trailers)
Bumper w/drain hose carrier
Screened egress bunk windows
Colored radius skirting
* Electric powered front jacks (fifth wheels)
* Snap jacks (fifth wheels)

STANDARD LIVING ROOM FEATURES

Oak flat-panel doors and drawers
Oak raised-panel doors in overhead cabinets
J-Steel™ convertible sofa
Interior entrance door grab handle
High-intensity lighting package
Linoleum entryway
Trackless carpeting w/pad
Coordinated decorator fabrics throughout
Fabric-covered box valances, drapes and tiebacks
Mini blinds
Crank-up TV antenna w/signal booster
Cable TV hookup
Decorative brass light at sofa
* Bookshelf stereo w/4 speakers
Flush floor slideroom
TV overhead cabinet
Overhead cabinets in slideout room
* Slider windows on slideout end walls

STANDARD BEDROOM FEATURES

Innerspring mattress
Bed lifts up easily on struts, storage below
Coordinated, quilted bedspread
TV cabinet or flip-up TV shelf (most models)
Accordion door to bedroom (some models)
Carpet and pad

STANDARD BATHROOM FEATURES

12V power vent w/frosted lens
ABS tub/shower surround
Garden tub (some models)
Wood medicine cabinet w/mirror
Shower curtain
Towel holder
* Switches for all lights

STANDARD KITCHEN FEATURES

Oak raised-panel doors in overhead cabinets
Residential-style mixing faucet
Deep residential-style sink
Sink cover/cutting board
Color-coordinated countertops
Flush-mounted double-door refrigerator
Oversized oven
Range hood w/light and fan
3-burner range w/9,000-BTU SuperBurner™ and piezo igniter
Range cover
Extra-long silverware drawer
Deep, lipped overhead cabinets
Panasonic® Inverter microwave oven w/carousel

STANDARD HEAT, POWER AND WATER FEATURES

Twin 30-lb. LP gas tanks w/regulator
Water heater bypass kit
Winterization kit
City water hookup
Systems monitor panel
Demand water pump
Electrical junction box inside trailer
12V electrical system w/deluxe 110V, 45-amp. converter
6-gal. gas/electric auto-ignition water heater
30-amp. power cord
110V exterior receptacle
Auto-ignition furnace w/thermostat
In-floor ducted heating
LP leak detector
Fire extinguisher
13,500-BTU central air conditioner

* New for 2003

OPTIONAL FEATURES

Raised-panel oak doors ILO oak flat-panel lower doors (inc. refer. doors)
Raised-panel oak refrigerator doors
Dinette door and drawer
Free-standing table and 4 chairs
Swivel rocker (most models)
* Rocker recliner (most models)
Hide-a-bed sofa w/footrest (most slideout models)
Front slideout bedroom (some fifth wheel models)
Bi-fold shower door
* Glass shower door (std. 303 RKS)
Tinted safety glass
High-glass Gelcoat fiberglass exterior sidewalls w/front cap
Rear stone guard window awning (most models)
Outside portable gas barbecue grill with carrying case
Phone jack
Bath skylight
Outside shower
Carefree® patio awning
Large double-door 8-cu.-ft. refrigerator
KidStuf™ bunk organizer(s)
Outside stove
15,000-BTU central air conditioner
Attic fan(s)
Rubber roof
Enclosed insulated holding tanks
Flexfoil™ insulation package
Roof ladder
Extra roof insulation
Spare tire and carrier
Spare tire cover
10-gal. gas/electric auto-ignition water heater (N/A 304 BH)
Stabilizer jacks (non-slideout models)
Shock absorbers
4,000-watt generator (some fifth wheel models)
Bar stools (some models)
Folding exterior grab handle
* Water purifier
* 16" tires in place of 15" tires (fifth wheel)
* Premium upgrade package

2003 Eagle™ Travel Trailers and Fifth Wheels & Eagle™ Cove Park Trailers Fabric Options



Green Meadow



Copper Canyon



Mountain Blue Mist



Sandalwood Rose



Eagle™ Cove Park Trailers

Step up to a better extended stay

You want a recreational vehicle that will keep you comfortable through an entire season at the lake or near the golf course, not just for a quick few days. But staying in a conventional travel trailer can get old after that much time. If you want the perfect second home for your extended stay, take a look at the new Eagle™ Cove park trailer by Jayco®.

In every room, you'll see features geared to make your long stay feel more like you never left home. In the living room, the optional **hide-a-bed sofa** gives you room for guests to stay over. In the bathroom, the **large sink bowl, flat-panel oak doors and wood medicine cabinet with mirror** provide what you're used to. In the bedroom, you can store lots of clothes in the **dresser with drawers** and come and go

easily through the **white, radius-framed, smooth fiberglass entrance door**.

Outside, Eagle Cove is ready for day-to-day activity. **Rain gutters with downspouts** take water away. Turn on the **patio light with inside switch** and sit out in the night air. Choose the optional **foil insulation and extra roof insulation** and extend your stay past summer.

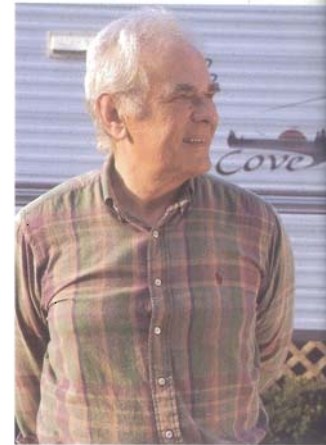

◀ The optional hide-a-bed sofa with dual foot rests converts to a comfortable bed to expand your sleeping arrangements.

▲ Gain plenty of room to rest with the standard bedroom slideout and 80" oversized queen bed with innerspring mattress that gives you 6" more space than a standard queen.

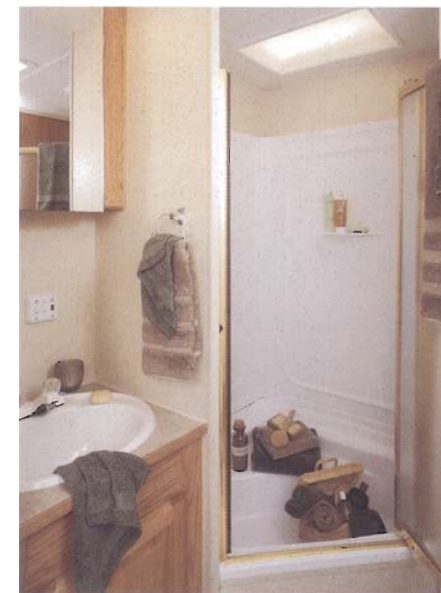

▲ Find beautiful, homelike features such as an ABS 39" garden tub with surround (38 FBS and 38 RLS) and optional glass shower door.



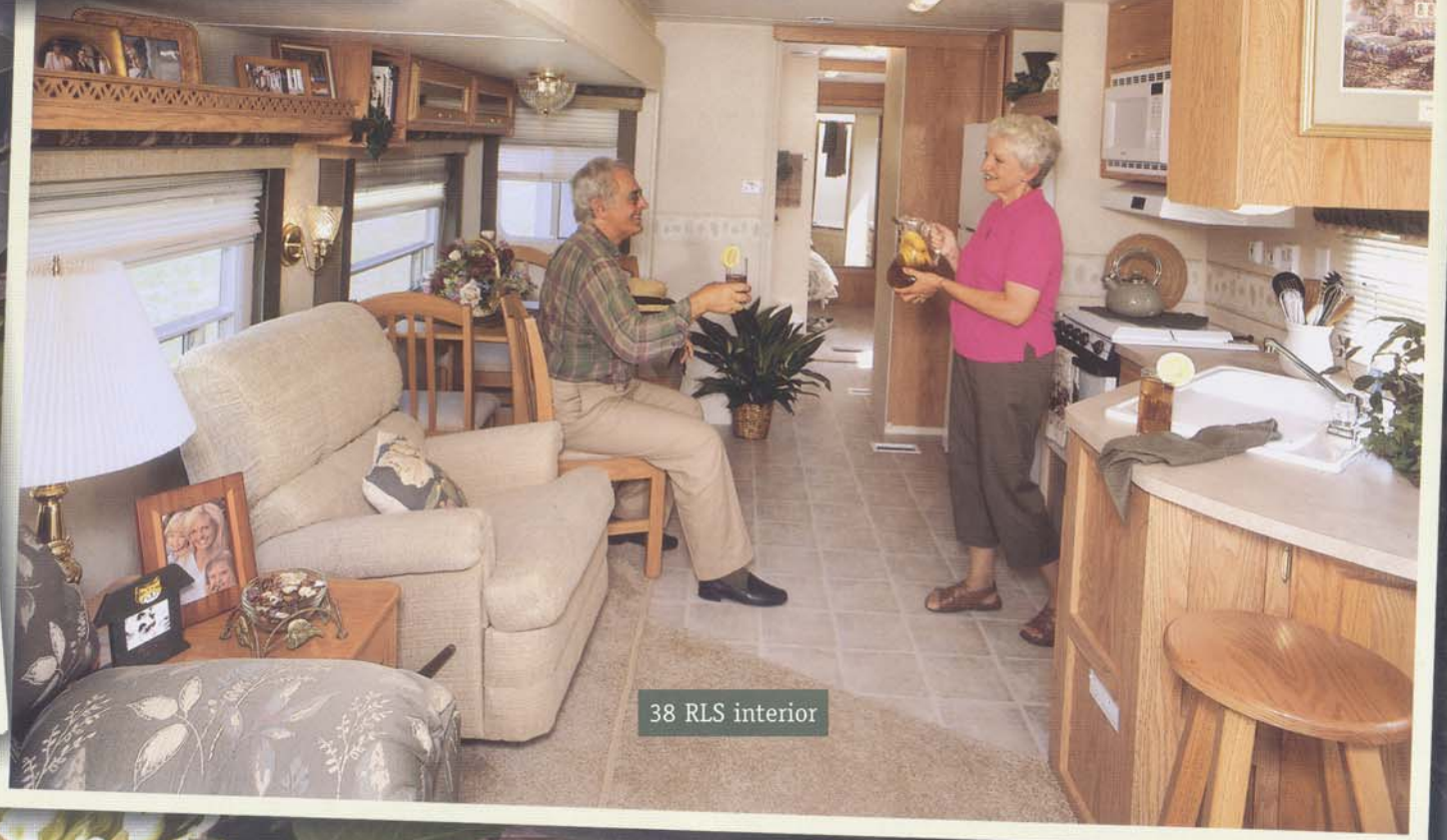

38 RLS interior

Step up to long-term comfort

Eagle™ Cove makes sure you feel just as relaxed and comforted during your seasonal stay as you do every other day of the year. The living area is lined with **deep-pile trackless carpeting with thick pad** and includes an **AM/FM 5-CD bookshelf stereo system with four speakers** to keep you entertained and a standard **sliding patio door** to give you easy entry and a great view. **Bedroom ceilings are a full 84" high** — taller than most travel trailers — so you don't feel cramped.

◀ Being away from home won't deprive you of home cooking. The kitchen comes equipped with a white 3-burner range with 9,000-BTU SuperBurner™ and piezo igniter, 21" oven and Kenmore® residential 16-cu.-ft. refrigerator.

◀ The optional laundry area with vented, stackable Whirlpool® washer/dryer combination cuts drying time and gives you clean clothes whenever you need them.

▶ Eagle™ Cove will remind you of your own living room with a swivel rocker or optional rocker recliner and optional coffee and end tables. Or, pull up a seat on an optional bar stool.



In the kitchen, **color-coordinated self-edged kitchen countertops, extra-tall kitchen cabinets** and a **residential-style mixing faucet and acrylic sink** may convince you you're still at home.

To help you enjoy some fresh air, the **front window stone guard** opens for better ventilation, as do **slideout end windows**. When the air turns cold, the **in-floor ducted heating** and **auto-ignition furnace with thermostat** let you extend your stay into cooler weather.

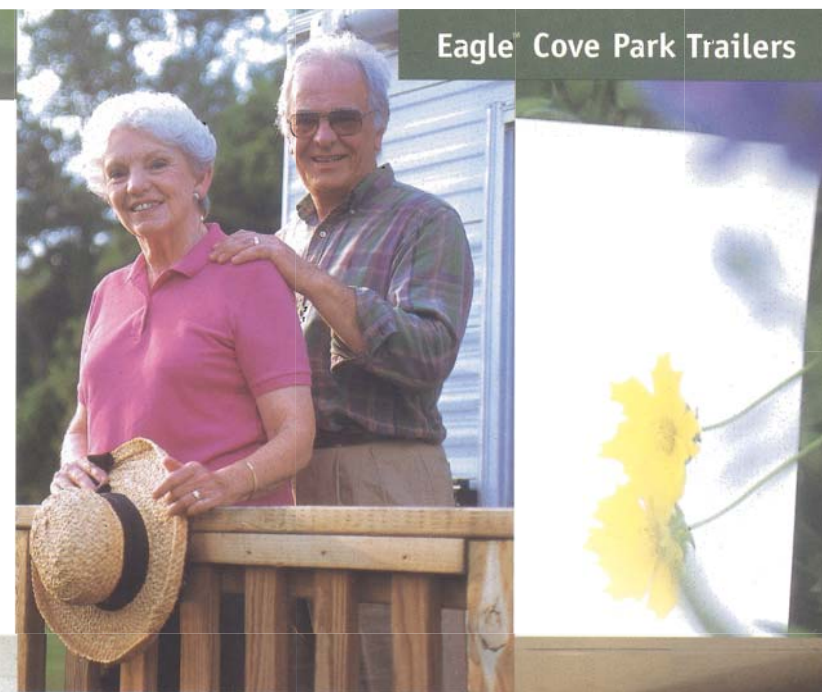

2003 Eagle™ Cove Park Trailers Standards and Options

STANDARD EXTERIOR FEATURES

15" tires
EZ Lube® axles
Battery rack in A-frame
2000-lb. tongue jack with foot pad
5/16" heavy duty chains
Lockable radius storage compartments with grab handles
Duratex™ underbelly covering
Rotocast holding tanks
Retractable triple entrance steps
Patio light with inside switch
60" x 72" patio door
Exterior entry door assist handle
White radius-cornered awning windows
Dead bolt lock on entrance door
ABS double LP bottle cover
Bumper with drain hose carrier
Charcoal-colored radius skirting
Rubber roof w/12-year warranty
Rain gutters with downspouts

STANDARD HEAT, POWER AND WATER FEATURES

Twin 30-lb. LP gas tanks with regulator
Plumb-Pex® water lines
Water heater bypass kit
City water hookup
Systems monitor panel
12V electrical system with 45-amp. 110V converter
IOTA power center
6 gallon gas water heater
30-amp. power cord
110V exterior electrical receptacle (1)
Auto-ignition furnace with thermostat
In-floor ducted heating
LP leak detector
Fire extinguisher
Smoke detector
13,500-BTU central air conditioner

STANDARD BATH FEATURES

12V power bath vent with frosted lens
ABS 39" garden tub with surround (38 FBS, 38 RLS)
Wood medicine cabinet with mirror
Shower curtain
Towel holder
Flat panel oak doors
Large sink bowl
Color-coordinated countertops with T-molding

STANDARD INTERIOR FEATURES

Flat panel oak doors
J-Steel™ convertible sofa
Linoleum entryway
Deep-pile trackless carpeting with thick pad
Coordinated decorator fabric throughout
Fabric-covered box valances, drapes and tiebacks
Mini blinds
Cable TV hookup
Overhead cabinets above sofa & dinette in slideout room w/mirror inserts
Bookshelf stereo AM/FM 5-CD with 4 speakers
Flush floor slideout
Slider windows on slideout end walls
Brass wall lighting

STANDARD BEDROOM FEATURES

Innerspring mattress (60" x 80" queen bed)
Bed lifts up easily on struts with storage below
Coordinated, quilted bedspread
TV overhead cabinet
Bedroom slideout
Flat panel oak doors
Dresser with drawers
22" x 68" white radius-framed smooth fiberglass entrance door
Roof vent
Night stand shelves next to bed in slideout room
Brass wall lighting (2)

STANDARD KITCHEN FEATURES

Residential-style mixing faucet
Residential-style acrylic sink
Sink cover cutting board
Color-coordinated self-edged countertops
Residential refrigerator (16-cu.-ft.)
Microwave with carousel
21" oven
Range hood with light and fan
3-burner range w/9000-BTU SuperBurner™ and piezo igniter
Wallpaper border
Flat panel oak doors and drawers
Trash can
Residential drawer guides

OPTIONAL FEATURES

Front twin beds with bunk (38 FBS)
Side queen bed with bunk (38 FBS)
Triple bunks (38 FKS)
Front living room (38 FBS)

OPTIONAL FEATURES (CONT.)

Oak free-standing table w/4 chairs
Dinette door and drawer
Hide-a-bed sofa with footrest
Rocker recliner ILO swivel rocker
Bar stools (38 FBS, 38 RLS)
Electric slideouts - living room and bedroom
Coffee table
End table
Raised-panel oak doors ILO flat-panel doors
Bi-fold shower door
Glass shower door
Residential-style stool with no holding tanks
Fresh water tank with pump
Day/night shades
Safety glass
Thermal pane tinted safety glass
Bath skylight
Conventional entrance door
Roof ladder
Flexfoil™ insulation package
Insulated holding tanks
Extra roof insulation
Stabilizer jacks
15,000-BTU central air conditioner
Second 13,500-BTU A/C in master bedroom (requires 50-amp. service option)
Attic fan (front, rear or both)
Large double-door refrigerator
Large double-door refrigerator with ice maker
10-gal. gas/electric DSI water heater
Range cover
Outside stove
Outside grill
Washer/dryer prep (requires 50-amp. service option)
Stackable washer/dryer (requires 50-amp. service option)
50-amp. service
Awning
Center tension rafter
Water purifier
Outside shower
Phone jacks (2)
KidStuf™ bunk organizer(s)
Folding exterior grab handle
TV antenna with booster
Spare tire with hinged fire carrier
Vinyl tire cover

2003 Jayco Eagle™ Towables and Eagle™ Cove Park Trailers

Jayco® delivers responsive, reliable after-market customer service

WE BACK WHAT WE BUILD

The Jayco 2+3 **Warranty** is a manufacturer's warranty. It doesn't come from your dealer, and it's not an extended warranty! It comes from the people who build Jayco recreational vehicles to the people who buy them. Each Jayco is warranted to the original purchaser for twenty-four (24) months from the date of purchase against defects in materials and workmanship. This is full hitch-to-bumper coverage on towables and bumper-to-bumper on motorized RVs. The Jayco warranty includes a three-year (3) structural guarantee. In addition, our warranty is transferable within the first two (2) years for a \$100 processing fee. Go ahead and compare the Jayco warranty with other manufacturers' warranties. You'll find it's the best in the business! For a copy of the warranty with full terms and conditions, ask your local Jayco dealer or visit our Web site.



When you purchase a Jayco Recreational Vehicle, you'll also get a support staff dedicated to meeting the needs of you and your dealer. To deliver on this promise, we built a 91,000-square-foot, state-of-the-art facility that seamlessly integrates our Warranty, Customer Service and Service Parts divisions (After Market Services — AMS). Staff from each division can now work more closely together to better provide prompt, accurate service.

For example, the AMS staff can quickly access information on the computer so service representatives can better serve the needs of Jayco dealers and retail customers. Our service area contains 15 bays that feed

into a spacious work area for customers who need assistance during their travels through Indiana. The Parts and Warranty divisions take advantage of our Jayco Xpress online computer network that links Jayco Customer Service to dealers across the country and allows them to place parts orders, check the status of an order and check pricing and availability. Dealers participating in the online system can also register new Jayco owners 24 hours a day, seven days a week. That way, when you pull off the dealer's lot, your new unit is already registered with the factory.

Our parts warehouse, equipped with automated carousels and stocked with a large inventory of parts, can provide our dealers with the parts you need so you can get back on the road to enjoying your vacation.

You won't find a more caring after-market service group in the recreational vehicle industry. That's our goal and commitment to you.

In the heart of the Midwest, old-world craftsmen have handed down tried-and-true construction methods from generation to generation. At our headquarters in Middlebury, Indiana, Jayco continues this tradition when building all of our recreational vehicles. Our rugged designs, solid construction and commitment to quality add up to a well-built vehicle you can depend on for years.



See above dealer for further information and prices.



Jayco, Inc. P.O. Box 460 Middlebury, IN 46540
www.jayco.com



As a Jayco owner, you can be part of the Jayco Jafari International Travel Club. Ask your dealer about the Jafari "flight" in your area, write Jayco direct or visit our Web site.

Please Note: All information in this brochure is the latest available at the time of publication approval. Jayco reserves the right to make changes and to discontinue models without notice or obligation.

Pictures in this brochure may show optional equipment. RVs built for sale in Canada may differ to conform to Canadian codes.

Printed on recycled paper.

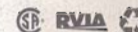

©2002 Jayco, Inc. 1102-125M Litho in U.S.A.