

TALON ZK™

BRING IT ON.

2005 TALON ZK SPORT UTILITY TRAVEL TRAILERS & FIFTH WHEELS BY JAYCO



TALON ZX™

GET OUT AND GO!



Jayco

THE TALON ZX TRAVEL TRAILER

Whether it's offroad or backroad adventure you seek, Jayco's Talon ZX Travel Trailer is set to take you there. With our new extended ramp, increased ramp capacity, and heavy-duty tie-down rings, you can load everything—from bikes to snowmobiles—with confidence.

Once you're done "playing" for the day, just pull down the queen bed, fold out the sofas, and you've converted this sport utility trailer into an awesome living space with all the comforts of home. Custom upholstery by Jayco, a convenient kitchen and a separate bedroom and bathroom offer everything you need for kicking back after letting it rip all day long.



With the optional 25-gallon fuel station, there's little down time. It's just pump and go.



- The Talon ZX T28A floorplan offers everything you'd expect in a 28-foot trailer – and then some!
- Keeping the bugs out and the breeze in is simple with this optional screen wall.
- The pull-down bed, double fold out sofas and separate bedroom offer tons of sleeping space.



Jayco's tie-down rings are each rated for 2,500 lbs. No matter what you're hauling, keeping things in place will NOT be a problem in the Talon ZX.

TALON ZX™

STOP, DROP, AND RIDE!



Jayco

THE TALON ZX FIFTH WHEEL

Looking for a sport utility trailer that's built to bring it on? Then look no further than Jayco's Talon ZX Fifth Wheel. Our 102" wide body frame gives you the cargo space you need to stop, drop and ride. And the 6-inch cambered I-beam frame, 2500 lb. rated ramp door, and Polyflex™ underbelly covering all offer the rugged durability you need for the long haul.

Whether you're spending a day in the duck blind or a day in the dunes, the uses for the Talon ZX are endless. Hunting, collecting antiques, off-road adventures—even transporting pets—are all made easier with the Talon ZX Fifth Wheel.



With the interior wall separating the garage from the living quarters as an option in all Talon ZX models, so is hauling both machine and beast.



- The optional screen room bears up to 1,000 lbs., and provides even more space to spread things out.
- The durable, non-slip flooring makes trips up and down the ramp worry-free.
- The Talon ZX fifth wheel sidewalls feature a premium, long-lasting fiberglass finish.



The new Talon ZX features an extra wide 102-inch exterior, making dual loads like these full size quads no problem at all.

2005 TALON ZX™ FLOORPLANS

T24E

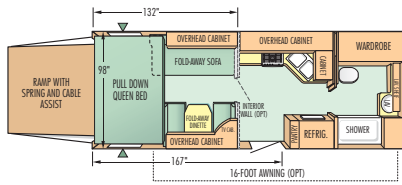

T28A

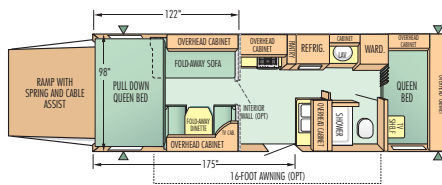

T32D

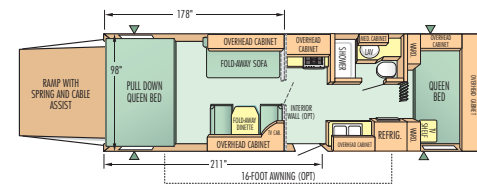

OUTSIDE STORAGE COMPARTMENT

F33K

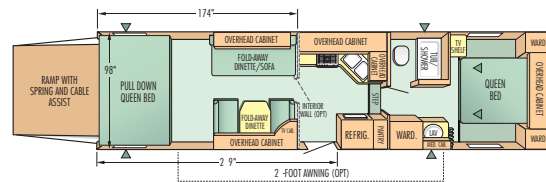

F35Y

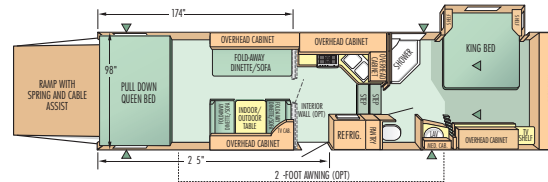

F36Z

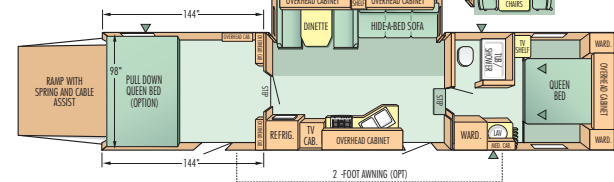

2005 TALON ZX SPECIFICATIONS

* = Estimated Values

TRAVEL TRAILERS	Exterior Length	Exterior Height	Bedroom Interior Height	Unloaded Vehicle Weight (lbs.)	Dry Hitch Weight (lbs.)	Gross Vehicle Weight Rating (lbs.)	Cargo Carrying Capacity (lbs.)	Fresh Water Capacity (gal.) Includes Water Heater	Gray Wastewater Capacity (gal.)	Toilet/Black Wastewater Capacity (gal.)
T24E	25'-11"	131"*	77"-93"	5380	825	10400	5020	112*	51	51
T28A	29'-12"	138"	77"-93"	7435	920	11700	4265	112	51	51
T32D	35'-11"	136"*	77"-93"	7900*	1000*	13000*	5100*	112	51	51
FIFTH WHEELS			Interior Height							
F33K	36'-3"	141"	93-1/2"	9210	2295	14500	5290	102	51	51
F35Y	36'-11"*	148"*	98"*	9718*	2295*	14500*	4782*	102	51	51
F36Z	39'-5"	145"	98"	10500*	2495*	14900*	4400*	81	100	50

Unloaded Vehicle Weight (UVW): Sometimes referred to as "Dry Weight," UVW means the typical weight of this trailer as built at the factory. The UVW, as used in product literature and other promotional materials, does not include cargo, fresh water, LP gas, options or dealer-installed accessories.

Gross Vehicle Weight Rating (GVWR): GVWR means the maximum permissible weight of the trailer, including the UVW plus passengers, personal items, all cargo, fluids, options and dealer-installed accessories. The GVWR is equal to or greater than the sum of the UVW and the CCC.

Cargo Carrying Capacity (CCC): CCC means the maximum weight of all passengers, personal items, food, fresh water, LP gas, tools, other cargo and dealer-installed accessories* that can be carried by the trailer. CCC is equal to or less than GVWR minus UVW.

*The addition of options will decrease the CCC.

It is important for your safety and enjoyment that your tow vehicle be adequately sized and equipped to tow and handle the GVWR of the RV you select. Review weights and rating of your tow vehicle and consult a competent advisor for questions or advice. Whether you are new to RVing or a veteran, get a feel for the performance of your tow vehicle and the RV together before heading out on the roadways. When you tow an RV, you must drive differently than you do when driving a single vehicle. Practice hooking up, driving, backing up and braking in a safe environment or seek out professional instruction.

See specification chart above. Jayco affixes a weight label to each RV which lists weight information for that vehicle.



- A. The F36Z's master bed/bath combo features lots of storage space and a comfy queen bed to boot.
- B. Triple battery storage area offers a perfect place for powering up.
- C. Huge storage areas make it easy to throw your gear in and go.
- D. Give your toys a good cleaning before you load with this handy pressure nozzle hose.

2005 TALON ZX STANDARDS & OPTIONS

TT=Travel Trailer FW=Fifth Wheel

STANDARD CONSTRUCTION	TT	FW
3/8" decking on roof	✓	✓
2"x2" longitudinal floor joists, on 10" centers	✓	✓
Electric-powered slideout (F36Z)	✓	✓
Cabinetry crafted w/screwed stile construction	✓	✓
PolyFlex™ one-piece underbelly cover	✓	✓
5/8" Seamless Structurwood® main floor decking	✓	✓
Tubular-aluminum sidewall framework	✓	✓
Filon® fiberglass sidewall exteriors	✓	✓
Roof rafters, constructed of residential-style tapered 4-1/2" trusses	✓	✓
One piece, seamless, rubber roof	✓	✓
TuffShell™ vacuum-bond laminated sidewalls	✓	✓
R-11 insulation in roof, R-9 in sidewalls	✓	✓
Frame made of 6" cambered I-beam steel w/ 2"x2" reinforced tubing (non-Slideouts)	✓	✓
Frame made of double stacked 12" tubular, cambered steel (Slideouts) (F36Z)	✓	✓

STANDARD POWER, WATER & HEAT	TT	FW
110V G.F.C.I. protected exterior receptacle (2)	✓	✓
12V electrical system with deluxe 110V 45-amp power converter	✓	✓
50-amp quick-connect power cord	✓	✓
50-amp electric service	✓	✓
Furnace with wall thermostat, auto-ignition	✓	✓
Battery disconnect switch	✓	✓
Hook-up for city water	✓	✓
12V demand water pump	✓	✓
Prep for solar power	✓	✓
Monitor panel for all systems	✓	✓
Double 30-lb. LP gas bottles, w/regulator	✓	✓
Sewer hose storage compartment	✓	✓
Water heater bypass system	✓	✓
Water system winterization kit	✓	✓
Outside shower	✓	✓

STANDARD SAFETY EQUIPMENT	TT	FW
Break-away switch	✓	✓
Lock and dead bolt on entrance door	✓	✓
Fire extinguisher	✓	✓
Dual hitch safety chains	✓	✓
Safety glass windows	✓	✓
LP/gas leak detector	✓	✓
Multiple egress windows	✓	✓
Smoke detector	✓	✓

STANDARD EXTERIOR EQUIPMENT	TT	FW
16" radial tires	✓	✓
2000 lbs. capacity tongue jack	✓	✓
Entrance door is fiberglass and radius cornered with screen door	✓	✓
12V light for hitch	✓	✓
ABS fender skirts	✓	✓
Cable TV hookup with RG6 coax cabling	✓	✓
Carefree® patio awning	✓	✓
Chrome racing wheels	✓	✓
Diamond-plated bottom radius skirting	✓	✓
Diamond-plated panel on front	✓	✓
Durafloor liner on garage floor	✓	✓
Electric-powered front jacks	✓	✓
E-Z Lube® axles	✓	✓
Battery box for three batteries	✓	✓
Lockable, radius-cornered baggage doors with heavy-duty grab handle	✓	✓
Molded ABS cover for LP gas bottle	✓	✓
Patio light with inside switch	✓	✓
Rain guttering, molded with drip spouts	✓	✓
Rear ramp lights (2)	✓	✓
Shock clips on frame and axles	✓	✓
Front jacks with quick release pins	✓	✓
Triple retractable entrance step	✓	✓

STANDARD INTERIOR EQUIPMENT	TT	FW
Tie-down rings are flush floor-mounted, anchored to frame, 2500 lbs. capacity (8)	✓	✓
Pull-down queen bed with strut-assist and ladder (T28A, F33X)	✓	✓
Deep-lipped overhead cabinetry w/cargo netting	✓	✓
Insulated and diamond-plated wheels wells	✓	✓
Washer with pressurized nozzle for exterior	✓	✓
Indoor/outdoor fiberglass table (T28A, F33X)	✓	✓
Fold-away sleeper/dinette (T28A, F33X)	✓	✓
Hide-a-bed sofa with foot rest (F36Z)	✓	✓
Mini-blinds throughout unit	✓	✓
Cable TV hookup with RG6 coax cabling	✓	✓
Fabric-covered box valances	✓	✓
High-intensity 12V lighting package	✓	✓
Fairfield Oak cabinetry throughout	✓	✓
Crank-up TV antenna with signal booster	✓	✓
Overhead cabinet for 20" TV	✓	✓
Handsome furniture, designed and made by Jayco®	✓	✓
Vinyl flooring throughout	✓	✓

STANDARD RAMP EQUIPMENT	TT	FW
7'-10" Door/Ramp, 2500 lbs. capacity	✓	✓
Concealed spring and cable assist assembly	✓	✓
Non-skid flooring	✓	✓
Cam style locks on ramp door	✓	✓
Beaver tail transition ramp	✓	✓

STANDARD BEDROOM EQUIPMENT	TT	FW
Under bed storage, bed lifts on gas struts	✓	✓
Carpeting with padding (F36Z)	✓	✓
Quilted bedspread	✓	✓
Pass-through storage compartment	✓	✓
Shelf for TV	✓	✓
Queen size innerspring mattress	✓	✓
Storage compartment in headboard	✓	✓
Curtain-pull closure	✓	✓

STANDARD BATHROOM EQUIPMENT	TT	FW
Tub with ABS surround	✓	✓
Large sink in bathroom	✓	✓
Marine toilet	✓	✓
Toilet paper holder	✓	✓
Medicine cabinet with mirror	✓	✓
Switches for all lights	✓	✓
Bar and towel ring	✓	✓

CUSTOMER VALUE PACKAGE	TT	FW
Central A/C, 15,000 BTU	✓	✓
2.5 gal. air compressor w/20' hose & chuck	✓	✓
6 gal. gas/electric DSI auto-ignition water heater	✓	✓
8 cu. ft. flush-mount double door refrigerator	✓	✓
Tub/shower with ABS surround	✓	✓
AM/FM stereo and CD player, wall mounted (with exterior speakers)	✓	✓
Skylight in tub/shower	✓	✓
Insulated holding tanks	✓	✓
Rack for luggage, ladder also included	✓	✓
Microwave oven with carousel	✓	✓
Fairfield oak flat-paneled doors and drawers	✓	✓
Bi-fold cover for range	✓	✓
Security lights (2)	✓	✓
Shock absorbers	✓	✓
Spare tire w/carrier mounted under coach	✓	✓
Stabilizer jacks (1 pair)	✓	✓
Stabilizer jacks (2 pair)	✓	✓
Water purification system	✓	✓

STANDARD KITCHEN EQUIPMENT	TT	FW
3-burner range with 9,000-BTU SuperBurner™ and piezo igniter	✓	✓
Deep residential-style sink	✓	✓
Drawer for silverware, divided for utensils	✓	✓
Oversized oven	✓	✓
Range hood with light and exhaust fan	✓	✓
Mixing high-rise faucet	✓	✓
Wallpaper border	✓	✓
Cover for sink/cutting board (1)	✓	✓
Microwave oven with carousel	✓	✓

OPTIONAL EQUIPMENT	TT	FW
Onan® 5500-watt Microlite generator with auto-changeover and 25 gal. gas tank	✓	✓
Aluminum flip-down table in cargo area	✓	✓
Wall for separation between cargo bay and cab (T28A,F33X)	✓	✓
Electric-powered tongue jack	✓	✓
Fuel station with 25 gal. gas tank	✓	✓
Prep for generator with 30 gal. gas tank	✓	✓
Free-standing oak table w/4 chairs (F36Z)	✓	✓
Portable, outside gas RVQ® grill w/carrying case	✓	✓
Screen room for patio	✓	✓
Powerwinch™ with 2500 lb. capacity	✓	✓
Pull-down queen bed (F36Z)	✓	✓
Screen wall	✓	✓



SPIN CITY BLUE

TABASCO

AT JAYCO, WE'RE IN IT FOR THE LONG HAUL.

Once you own a Talon ZX, you'll find out that Jayco takes the whole "service-after-the-sale" thing seriously. In fact, our 91,000 square-foot, state-of-the-art Jayco Service Center was built for the sole purpose of responding to customer and dealer needs fast and effectively. With the Jayco Service Center, you'll reap the following benefits:



- *With Warranty, Service and Parts all under one roof, we can answer your concerns quickly and efficiently, no matter what the issue.*
- *A completely automated and computerized system registers your Talon ZX the moment you pull off the lot, providing prompt and accurate service down the road.*
- *The Jayco Xpress online network links Jayco Customer Service to dealers across the country, allowing them to order parts, check the status of orders, and check pricing and availability of parts in real time.*
- *15 bays feeding into a spacious work area means when customers are passing through Indiana and they need assistance, we're ready to help.*
- *Automated carousels stocked with a large inventory of parts help dealers keep you moving right along.*

At Jayco, we're in it for the long haul. And with our exclusive Jayco Service Center, we're proving it one customer at a time.

THIS WARRANTY RULES!

The Jayco 2+3 Warranty is a manufacturer's limited warranty. It doesn't come from your dealer and it's not an extended warranty! It comes from the people who build Jayco recreational vehicles to the people who buy them. Each Jayco is warranted to the original purchaser for twenty-four (24) months from the date of purchase against defects in materials and workmanship. The Jayco warranty includes a limited three-year (3) structural guarantee and, in addition, our limited warranty may be transferred one time within the first two (2) years. Go ahead and compare the Jayco warranty with other manufacturers' warranties. You'll find it's the best in the business!



For a copy of the limited warranty with full terms and conditions, ask your local Jayco dealer or visit our web site at www.jayco.com.

A LEGACY OF CRAFTSMANSHIP

Jayco has been blessed with some of America's finest craftsmen who make Middlebury, Indiana and the Jayco plant their home and workplace. Generation after generation, a legacy of tried-and-true construction methods is passed down, continuing the tradition of quality and durability that has helped Jayco grow into a true industry leader.



Jayco, Inc., P.O. Box 460, Middlebury, IN 46540
www.jayco.com

See above dealer for further information and prices.

©2005 Jayco, Inc. 0501049.2005 0604-50M

As a Jayco owner, you can be part of the Jayco Jafari International Travel Club. Ask your dealer about the Jafari "flight" in your area, write Jayco or visit our web site.



Please Note: All information in this brochure is the latest available at the time of publication approval. Jayco reserves the right to make changes and to discontinue models without notice or obligation. Pictures in this brochure may show optional equipment. RVs built for sale in Canada may differ to conform to Canadian codes.



RVQ is a registered trademark of Vitco, Inc. Filon is a registered trademark of Kemlite Company, Inc. E-Z Lube is a registered trademark of the Dexter Axle Company. Carefree is a registered trademark of Carefree of Colorado. Onan is a registered trademark of Onan Corporation.