

RECON ZX

IT'S ON.

2007 Fifth Wheel Toy Haulers by Jayco®



AMERICA'S MOST LIVEABLE RVs.

2007 RECON ZX Fifth Wheel Toy Haulers



AMERICA'S MOST **LIVEABLE** RVs.

"Liveable" may mean what you see, what you feel or even what you trust about a Jayco. But one thing is for certain, "liveable" is the reason why more people across North America are making Jayco their choice in RVs.



Invisible Liveables

Upgrading to Recon ZX means gel-coat fiberglass exterior walls, 96" wide loading ramp and garage space that handles quads, side x sides, right up to full sized sand rails. Recon ZX also means a 1,000 watt Xantrex® inverter plus a 25 gallon generator fuel tank ...all standard.



F36V model shown



- 1** Toys need tools, so we've included mill-finished aluminum shelves and a handy workspace (select models).
- 2** The radius-cornered ramp door has a weight capacity of 2500 lbs. and is designed for safety.
- 3** Outside storage compartments are generously sized for large items like sports gear.
- 4** It's easy to keep your toys securely stowed away with this cam-style ramp door latch with built-in lock.
- 5** Our tie-down rings are each rated for 2,500 pounds and keep your ATVs, motorcycles and other toys stationary during travel.

- 6** Durable non-slip Gripstar™ flooring makes for worry-free trips up and down the ramp.
- 7** 3/16" luan board adds strength to the roof, sidewalls and floor.
- 8** Foam insulation in floors and sidewalls (R-9 in roof and R-7 in sidewalls) helps keep the interior comfortable.
- 9** Roof rafters are constructed of strong, residential-style 4-1/2" trusses.
- 10** 3/8" plywood in roof construction
- 11** One-piece, seamless rubber roof shrugs off the hardest rains, reflects heat and reduces noise.
- 12** Easy-care carpet is included in select areas.
- 13** Carpet pad enhances the comfort and durability of the carpet.

- 14** 2" laminate floor contains 3/8" seamless Structurwood® main floor decking creating a firm foundation for flooring materials.
- 15** Welded tubular aluminum sidewall framework offers lightweight durability.
- 16** Like the sidewall framework, the floor frame is built of aluminum.
- 17** TuffShell™ vacuum-bond laminated gel-coat fiberglass sidewalls are sleek and aerodynamic.
- 18** One-piece underbelly covering greatly reduces drag for better fuel economy and protects from grime and road debris.
- 19** We simplified the "ins and outs" with the Big Easy™ triple retractable main entrance steps.
- 20** Enjoy smoother rides with the optional MOR/ryde® pin box and suspension package.
- 21** Fiberglass insulation in underbelly and roof construction (R-11)
- 22** Aluminum welded wheel wells

Incredible Liveables.

Anybody that packs this much adventure into travel deserves a toy hauler that's designed to handle it all with gusto. Recon ZX has plenty of cargo space for your toys plus plenty of sleeping space for your friends and family. Fully equipped and easy to load, you're ready to roll at the drop of a hat.





The generous cargo space easily accommodates two full-size ATVs or motorcycles.



Gas up and get going with this optional 25-gallon fuel station.

treadlightly!
OFFICIAL SPONSOR



Jayco proudly sponsors Tread Lightly!®, a nonprofit organization whose mission is to empower generations to enjoy the outdoors responsibly through education and restoration.

Available Liveables.

Recon ZX upgrades keep coming, with optional electric overhead queen bed in the rear and Kicker® speakers with AM/FM/CD/DVD system that's iPod® ready. Full kitchen, plenty of storage and trend setting interiors mean only Recon ZX combines upgraded garage and living amenities as standard into one toy hauler.

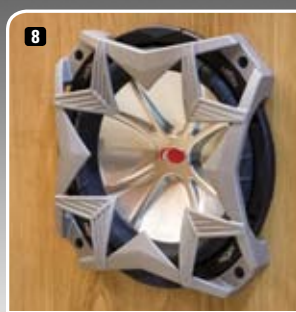

- 1 Cooking's a snap in the fully equipped kitchen with deep recessed residential-style sink, high-rise faucet, recessed 3-burner range and microwave with carousel.
- 2 The bedroom offers relaxing comfort with a queen size pillow-top mattress, quilted bedspread, carpeting and accordion-style door.
- 3 Additional sleeping space is provided by a cozy queen bunk.
- 4 Fill up your tires anywhere, even in remote locations, with the 2.5-gal. air compressor that's part of the optional Power Package.
- 5 After playing hard, take it easy inside — you'll find everything you need to gather the gang together and share a meal or movie.
- 6 Spacious and loaded with storage, the kitchen features handcrafted Manchester Oak cabinetry with raised panel doors and drawers.
- 7 An optional retractable screen wall pulls down in seconds, creating an extra space to have a seat and enjoy the breeze.
- 8 Turn up the volume with the optional Kicker® subwoofer and amplifier. The Customer Value Package includes an AM/FM stereo, CD/DVD player, Kicker® speakers, iPod® adapter/charger and Sony® outdoor water-proof stereo control.
- 9 The Jayco ZX command center lets you control all power functions from one spot.
- 10 With the power jump pack, part of the optional Power Package, you'll have battery power wherever you go.
- 11 Wash off the dirt from a rugged afternoon with the handy pressure nozzle hose which comes as part of the optional Power Package.



Measurable Liveables.

2007 Recon ZX by Jayco®

Standard Interior Equipment

- 20" TV
- Brushed nickel hardware
- Crank up TV antenna with signal booster
- Deep-lipped overhead cabinetry w/cargo netting
- Double electric queen beds in rear (F37T)
- Fabric-covered box valances with lambrequin legs
- Fold-away sleeper/dinette (F37T)
- Garage vent ports
- High-intensity 12V lighting package
- Indoor/outdoor fiberglass table (F37T)
- Jayco ZX furniture
- Multi-directional louvered central A/C vents
- Night shades throughout
- One-piece welded diamond plate wheel wells
- Overhead cabinet for 20" TV (F37T)
- Satellite TV hookup with RG6 cable
- Six panel passage doors throughout
- Tie-down rings are flush floor-mounted, anchored to frame, 2500 lbs. capacity each
- Vinyl flooring in living and bath areas

Standard Bedroom Equipment

- Accordion-style bedroom door
- Carpeting with padding
- Queen size pillow-top mattress (60x80)
- Quilted fitted bedspread
- Shelf for TV
- Shoe shelf in closet
- Under bed storage, bed lifts on gas struts

Standard Bathroom Equipment

- Bar and towel ring
- Large sink in bathroom
- Magazine Rack

- Marine toilet w/foot flush
- Medicine cabinet with mirror
- Switches for all lights
- Toilet paper holder

Standard Kitchen Equipment

- Brushed nickel mixing high-rise faucet
- Cover for sink/cutting board (2)
- Deep recessed residential-style sink
- Drawer for silverware, divided for utensils
- J-Stone™ solid surface countertops
- Overhead range hood with light and exhaust fan
- Oversized oven
- Recessed 3-burner range with 9,000 BTU SuperBurner™ and piezo igniter

Standard Exterior Equipment

- 12V light for hitch
- 16" radial tires
- Battery box for three batteries
- Big Easy™ triple retractable main entrance step
- Carefree® patio awning
- Diamond-plated panel on front
- Electric-powered front jacks
- Entrance door is fiberglass and radius cornered with screen door
- Jayco ZX exterior speakers
- Jayco ZX step faceplate
- Lockable, radius-cornered baggage doors
- Mill-finished aluminum fender skirts
- Patio light with inside switch
- Rain gutturing, molded with drip spouts
- Rear ramp lights (2)
- Satellite hookup with RG6 cable
- Shock clips on frame and axles
- Triple axles with E-Z Lube® features
- Tuff-ply™, rubberized liner on garage floor

Standard Construction Features

- 3/8" decking on roof
- 10-1/2" solid steel outriggers
- 102" wide body
- Cabinetry crafted w/screwed stile construction
- Electric-powered slideout
- Frame made of 10" cambered I-beam steel w/ 2" x 2" reinforced tubing (F37T)
- Frame made of double stacked 12" tubular, cambered steel (F36V & F37U)
- Gel-Coat fiberglass sidewalls
- One piece, seamless, rubber roof
- PolyFlex™ one-piece underbelly cover
- Roof rafters, constructed of residential-style tapered 4-1/2" trusses
- R-11 insulation in roof, R-9 in sidewalls, R-7 in floors
- Structurwood® main floor decking
- TuffShell™ vacuum-bond laminated sidewalls
- Seamless, 2" laminated construction of floor
- Welded tubular-aluminum sidewall and floor framework
- Wired and framed for second A/C

Standard Ramp Equipment

- 7' 10" door/ramp, 2,500 lbs. capacity
- 96" wide ramp door opening
- Beaver tail transition ramp
- Cam style locks on ramp door
- Hinge spring assist
- Non-skid flooring

Standard Power, Water and Heat

- 12V demand water pump
- 12V electrical system with deluxe 110V 75-amp power converter
- 50-amp quick-connect power cord and storage bracket

- 50-amp electric service
- 110V G.C.F.I. protected exterior receptacle (4)
- 135 gallon fresh water capacity
- 1,000 watt Xantrex® inverter
- A/C chill grill
- Automatic transfer switch with generator or generator prep
- Battery disconnect switch
- Black holding tank sprayer
- Concealed black and gray tank valves
- Double 30-lb. propane gas bottles, w/ regulator
- Furnace with wall thermostat, auto-ignition
- Generator prep with 25 gallon fuel tank
- Hook-up for city water
- Jayco ZX command center
- Outside shower
- Prep for solar panel
- Sewer hose storage compartment
- Water heater bypass system
- Water system winterization kit

Standard Safety Equipment

- Break-away switch
- Carbon monoxide detector
- Fire extinguisher
- Lock and dead bolt on entrance doors
- Multiple egress windows
- Propane/gas leak detector
- Smoke detector
- Tinted safety glass windows

Optional Equipment

- 32" LCD TV
- Cargo area powered roof vent
- Customer Value Package
- Double electric queen beds (Std. F37T)
- Electric rear stabilizer jacks

- Free standing table w/ 2 chairs and 2nd sofa
- Fuel station with 25-gal. gas tank
- Jayco ZX retractable screen wall
- Kicker® subwoofer and amplifier w/waterproof exterior remote
- MOR/ryde pin box and suspension package
- Onan® 5,500-watt Microlite generator with auto-changeover and 25 gal. gas tank
- Patio screen room and rear awning
- Portable, outside gas RVC® grill w/ carrying case and steak plate
- Power Package
- Roll up carpet
- Second A/C in cargo area
- U-shaped dinette & sofa combo (N/A F37T)

Customer Value Package

- 8 cu. ft. flush-mount double door refrigerator
- 12V AM/FM/CD/DVD stereo, iPod adapter/charger and 4 Kicker® speakers
- 16 gal. gas/electric DSI auto-ignition water heater
- 16" spare tire w/ carrier mounted under cargo area
- Central A/C 15,000 BTU
- Deluxe pillowtop mattress
- Flush-mount bi-fold cover for range
- Insulated holding tanks
- Manchester Oak raised paneled doors & drawers
- Microwave oven with carousel
- Neo-angle tub/shower with ABS surround
- Rack for luggage, ladder also included
- Rear stabilizer jacks (2)
- Security lights (2)
- Shock absorbers
- Skylight in tub/shower
- Water purification system

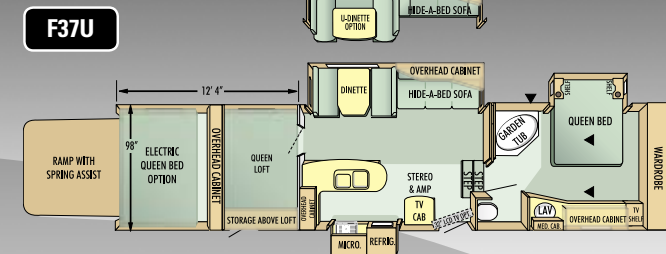
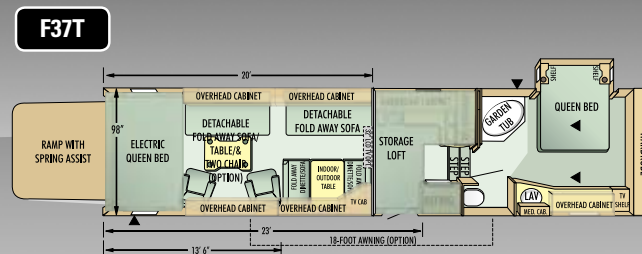
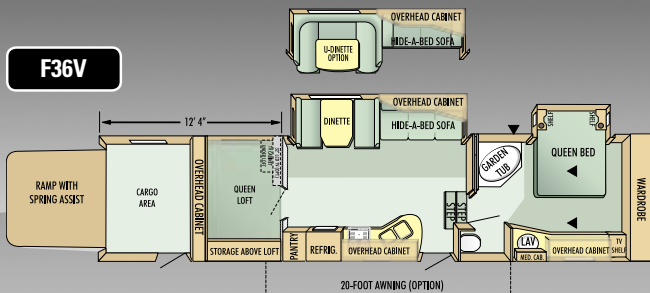

2007 Specifications and Measurements

Fifth Wheels	Exterior Length	Exterior Height w/ AC	Interior Height	Unloaded Vehicle Weight (lbs.)	Dry Hitch Weight (lbs.)	Gross Vehicle Weight Rating (lbs.)	Cargo Carrying Capacity (lbs.)	Fresh Water Capacity* (gal.)	Gray Wastewater Capacity (gal.)	Toilet/Black Wastewater Capacity (gal.)
F36V	40'	157"	102"	13,030	3,500	18,000	4,970	142	98	51
F37T	40' 7"	157"	108"	11,700	3,220	18,000	6,300	142	51	51
F37U	TBD	157"	TBD	TBD	TBD	18,000	TBD	TBD	TBD	TBD

*Includes water heater capacity

It is important for your safety and enjoyment that your tow vehicle be adequately sized and equipped to tow and handle the GVWR of the RV you select. Review weights and rating of your tow vehicle and consult a competent advisor for questions or advice. Whether you are new to RVing or a veteran, get a feel for the performance of your tow vehicle and the RV together before heading out on the roadways. When you tow an RV, you must drive differently than you do when driving a single vehicle. Practice hooking up, driving, backing up, and braking in a safe environment or seek out professional instruction. Jayco affixes a weight label to each RV which lists weight information for that vehicle. See specification chart to the left.

Unloaded Vehicle Weight (UUV):

Sometimes referred to as "Dry Weight," UUV means the typical weight of this trailer as built at the factory. The UUV, as used in product literature and other promotional materials, does not include cargo, fresh water, propane, options, or dealer-installed accessories.

Gross Vehicle Weight Rating (GVWR):

GVWR means the maximum permissible weight of the trailer, including the UUV plus passengers, personal items, all cargo, fluids, options, and dealer-installed accessories. The GVWR is equal to or greater than the sum of the UUV and the CCC.

Cargo Carrying Capacity (CCC):

CCC means the maximum weight of all passengers, personal items, food, fresh water, propane, tools, other cargo, and dealer-installed accessories that can be carried by the trailer. CCC is equal to or less than GVWR minus UUV. The addition of options will decrease the CCC.

Hitch Weight (HW):

The hitch weight, as used in product literature and other promotional materials, does not include cargo, fresh water, propane gas, options or dealer-installed accessories. The addition of these types of items will either add to or subtract from the stated hitch weight.

Interior Color Options



Graphite



Fire Stick

1. Drapery 2. Bedspread 3. Coordinate 4. Main 5. Carpet 6. Vinyl floor 7. Counter top 8. Wood



Customer First Roadside Assistance

Travel worry-free in your Recon ZX with Jayco's Customer First Roadside Assistance program, yours at no cost during your first year of ownership. This program is offered through Coach-Net®, the largest RV emergency road service in the country, and gives you immediate access to dependable roadside assistance and support services with a simple phone call.

- 24-hour toll-free emergency message service
- Toll-free nationwide service appointment assistance
- Free custom trip routing and full color map service
- Free dispatch of on-site mechanical service
- \$1,000 auto theft or hit-and run reward
- \$2,000 trip interruption reimbursement
- Free jump starts
- Free tire changes
- Free fuel delivery
- Free lockout service
- Free travelers checks

We Back What We Build.



The Jayco Co-Pilot Warranty is a manufacturer's limited warranty. It comes from the people who build Jayco recreation vehicles to the people who buy them. Each Jayco is warranted to the original purchaser for twenty-four (24) months or twenty-four thousand (24,000) miles (mileage limitation applies to motorized products only), whichever occurs first, from the original date of purchase against defects in materials and workmanship. In addition, our limited warranty may be transferred one time within the warranty period. Go ahead and compare the Jayco warranty with other manufacturers' warranties. You'll find it's the best in the business!

For a copy of the limited warranty with full terms and conditions, ask your local Jayco dealer or visit our website at www.jayco.com.



AMERICA'S MOST LIVEABLE RVs.

Jayco, Inc., P.O. Box 460, Middlebury, IN 46540 www.jayco.com

See dealer for further information and prices. All information in this brochure is the latest available at the time of publication approval. Jayco reserves the right to make changes and to discontinue models without notice or obligation. Photos in this brochure may show optional equipment or props used for photography purposes. RVs built for sale in Canada may differ to conform to Canadian codes. RVQ is a registered trademark of Vitco, Inc. E-Z Lube is a registered trademark of the Dexter Axle Company. Carefree is a registered trademark of Carefree of Colorado. Dolby and the double-D symbol are registered trademarks of Dolby Laboratories. ©2007 Jayco, Inc. 07-RECN-PL 0806-100K Printed in U.S.A.

Your Jayco Dealer

JayPlus

Protect your RV investment. Ask your Jayco dealer about our exclusive JayPlus program today.



As a Jayco owner, you can be part of the Jayco Jafari International Travel Club. Ask your dealer about the Jafari "flight" in your area, write Jayco, or visit our website.