



Designer

2008 Designer Fifth Wheels by Jayco®



Relax in Luxury

2008 DESIGNER Fifth Wheels by Jayco®



AMERICA'S MOST LIVEABLE RVS.



This is Your Time to Relax in Luxury

Designer

2008 FIFTH WHEELS

This is the perfect time to treat yourself to the luxury of the Designer fifth wheel. The Designer lets you bring all the comforts of home with you while enjoying your favorite scenic destinations. There are premium materials and upscale touches throughout the spacious interior, creating an elegant second home. Whether you're gone for a week or a winter, the Designer enhances each day with style.

Best of all, this extraordinary luxury is available for an ordinary price. Jayco has mastered the art of building values, and the Designer is a beautiful example that you can feel like a million bucks without spending a fortune.



Jayco proudly sponsors Tread Lightly!, a nonprofit organization whose mission is to empower generations to enjoy the outdoors responsibly through education and restoration.



Step Up to the Finest



Designer

- » Variety of floorplans that sleep 4 to 6
- » Designed like a luxury suite on wheels
- » Ideal for extended stays

10 Reasons You'll Keep Loving It

- » Durable TuffShell™ vacuum-bond laminated construction
- » Lightweight, welded aluminum-framed sidewalls for easier towing
- » Enclosed, insulated and heated underbelly protects from road debris
- » Welded aluminum floor studs for increased stability
- » 5/8" tongue-and-groove plywood floor stays secure
- » Trouble-free 5" laminated roof with aluminum framing
- » Aerodynamic gelcoat fiberglass caps in front and rear
- » Wide-Trac™ landing gear reduces wobbling when parked
- » Jake Plate™ adjustable axle hangers for more level towing
- » Unparalleled 2-year Co-Pilot Warranty gives peace of mind



Celebrating 40 Years of Liveability

The Jayco story began in 1968 with a humble desire to build more comfortable and practical ways for families to explore the world together. Jayco has grown to become the largest privately owned manufacturer of recreation vehicles in North America. While our product line is more diverse than ever before, every unit we build shares a common attribute— liveability. Because we believe every journey should be easy to enjoy.

Designer



» Surround Yourself With Splendor

About the only thing more impressive than the inside of the Designer might be the spectacular views outside its windows. The open living room is filled with tasteful touches including multi-angled overhead cabinetry with decorative-etched glass inserts, elegant window treatments and richly upholstered furniture. And in the dining area, the free-standing table and chairs add classic charm to every meal.





You'll be well equipped for movie night with this optional deluxe entertainment center featuring a 42" LCD TV and home theater system with Dolby® Digital 5.1 Surround Sound and DVD player. Add ambiance with the optional 5,100 BTU fireplace.



Selected Designer floorplans include a convenient desk area for using your computer, writing letters or paying bills.



A Great Year to Buy

In honor of Jayco's 40th Anniversary, we've added special features to selected 2008 Designer models including an electric awning, flat screen LCDTV and adjustable dream dinette table. Ask your Jayco dealer for complete details.





Designer



» Cook Up Daily Adventures

As any good cook knows, it's all in the ingredients. The Designer's kitchen serves up a scrumptious blend of handcrafted cabinetry in Provincial Glazed Maple or Manchester Oak, first-class appliances, solid J-Stone® countertops and oil-rubbed bronze lighting and fixtures. You'll enjoy the warmth of this thoughtfully designed space regardless of what's on the menu that day.





There's plenty of room to relax in the richly appointed bedroom featuring Jayco's Cloud Ten™ mattress, decorative headboard, reading lights and ample clothing storage.



Take in the view through the newly enlarged picture window in the dining area. You'll also appreciate the sleek, expandable table and comfortable chairs.



The bathroom includes a 34" fiberglass radius shower with a skylight, glass shower door and residential-style medicine cabinet with mirror.



polarBARRIER
four season camping by Jayco®

INTRODUCING JAYCO'S POLAR BARRIER™ 4-SEASON THERMAL PACKAGE

Extend your camping season with Jayco's 4-season thermal package—Polar Barrier™. Designed for efficient heating and cooling, Polar Barrier protects against freezing—even when temperatures drop as low as 0° Fahrenheit. Available now on select 2008 models. Please see back page for more details.

Jayco Builds Lasting Value

Designer fifth wheels are constructed with high quality materials using production techniques perfected over the past 40 years. Count on yours to look good, perform well for years and provide excellent resale value.



1. FRP smooth fiberglass sidewalls provide a sleek, aerodynamic look.
2. 1/8" plywood board adds strength to the sidewalls.
3. Bead-foam insulation (R-9) in sidewalls helps keep the living space more comfortable.
4. Welded tubular-aluminum sidewall framing offers light weight durability.
5. The seamless one-piece rubber roof shrugs off the hardest rains, reflects heat and reduces noise.
6. One-piece, TuffShell™ vacuum-bonded laminated roof is 5" thick.
7. R-7 fiberglass blanket insulation adds to the interior comfort.
8. Foil bubble insulation provides an additional R-15 value of insulation.
9. The welded aluminum floor frame is built to provide lasting stability.
10. Our Poly Flex™ one-piece underbelly covering is designed for continuous protection.
11. Strong 5/8" plywood flooring features tongue-and-groove construction to keep seams firmly attached.
12. Carpet pad included to maximize carpet comfort and durability.
13. Attractive, easy-care carpet makes the Designer feel like home.
14. Underbelly "skin" of the gooseneck is made of aluminum.



The Carefree® Travel'r 12 volt electric patio awning creates a comfortable outdoor area that's perfect for enjoying the breeze.

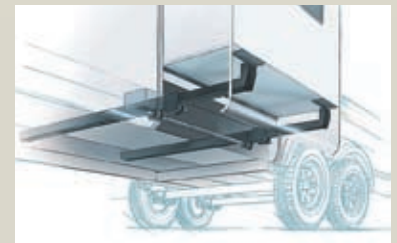

Expand your living space easily with the PowerDrive™ slideout, built with a strong 12" stacked tubular steel frame that allows for 6'3" of headroom.



A LEGACY OF CRAFTSMANSHIP.

Jayco's dedicated production team includes Amish craftsmen who build with well-honed woodworking techniques passed down for generations, and skilled seamstresses who produce our upholstery, bedding and draperies with great attention to detail.



Jake Plate™ adjustable axle hanger plates let you adjust the height of your fifth wheel up to 2 inches for more level towing.



Our rugged, double-stacked 12" tubular steel frame won't flex as much as the typical C-channel frame used on most RVs, so the Designer is more rigid and stable.

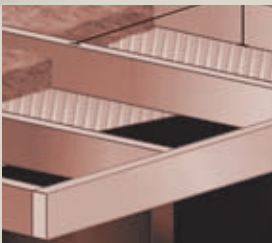

The floor is built on a 3" tall aluminum frame with joists welded on 16" centers, making the Designer lighter to tow and more durable.

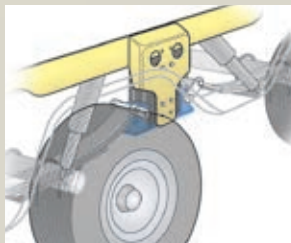

The optional MOR/ryde® suspension system adds rubber shear springs that absorb damaging road shock for smoother towing and better handling.



Cabinet drawers are built with ball bearing glides for easy movement.

Standard Bedroom Equipment

Accordian-style bedroom door
Decorative headboard
Decorative pillows for bed
Dresser drawers, residential style
Laundry hamper
Nightstand shelves with tissue box holders next to bed
Phone jack
Pleated day/night shades
Quilted bedspread with 2 pillow shams
TV cabinet with satellite and cable jacks
Under bed storage, bed lifts easily on gas struts

Standard Construction Features

5/8" tongue and groove plywood main floor decking
Bead-foam insulation (R-9 in sidewalls, R-25 in roof)
Cabinetry crafted with screwed stile construction
Electric-powered slideout
Enclosed, insulated and heated underbelly
Frame made of double stacked 12" tubular, cambered steel
FRP smooth fiberglass sidewall exteriors
One piece, seamless, rubber roof
Pin box, long
Poly Flex™ one-piece underbelly covering
Reflective foil insulation in main and bedroom floor and all slideout floors
TuffShell™ vacuum-bonded laminated sidewalls
Vacuum-bonded 5" laminated roof
Welded aluminum floor studs on 16" centers
Welded tubular-aluminum sidewall framework

Standard Bathroom Equipment

6-panel residential style passage doors
36" Fiberglass tub/shower with tile pattern surround
Cup holders, hooks for hanging items and soap dish
Ducted heating
Glass shower door
Oil rubbed bronze fixtures
Residential medicine cabinet with mirror
Skylight in tub/shower
Theftford porcelain stool with foot pedal
Toilet paper holder
Towel holder
Wall switches for all lights
Window in commode area

Standard Interior Equipment

Cable TV hookup with RG6 coax cabling
Carpeting with padding throughout unit
Ceiling fan with light
Crank-up TV antenna with signal booster
Decorative oil-rubbed bronze lighting throughout
Decorative throw pillows for Hide-a-bed
End table with built-in magazine rack
Entertainment center
Grandfather clock (select models)
Halogen lighting under overhead cabinets
Hide-a-bed sofa
High-intensity 12V lighting package
Inlaid hardwood entrance door header
Linoleum floor in entryway

Manchester Oak raised-paneled doors and drawers throughout
Message center
Overhead cabinetry in slideout room with decorative glass inserts
Phone jack
Prep for satellite dish for roof and sidewall
Pleated day/night shades
Residential-style trim and molding
Rocker recliner(s)
Sliding windows in slideout end walls
Solid hardwood interior entry grab handle
SuperSlide™ with flush-floor design

Standard Exterior Equipment

12V hitch light
16" radial tires
ABS fender skirts
Baggage doors, lockable, insulated and radius-cornered with heavy-duty grab handles
Battery box for two batteries
Black-framed, radius-cornered, awning style windows with tinted safety glass
Bracketry for 50 amp power cord in front basement
Caps on front and rear made of fiberglass with radius corners
Electric-powered front jacks
Entrance door is fiberglass and radius cornered with screen door
E-Z Lube® axles
Front jacks with quick release pins
Galvanized steel wheel wells
Jake Plate™ adjustable axle hangers
Ladder to roof
Outstanding exterior pass-through storage
Painted bottom radius skirting
Patio light with inside switch
Rain guttering, molded with drip spouts
Safety glass
Shock absorbers
Sidewall corners radiused at top and bottom
Street-side utility light
Triple retractable main entrance step

Standard Kitchen Equipment

3-burner range with 9000-BTU SuperBurner™ and piezo igniter
8 cu.ft. refrigerator with double door
Bi-fold, recessed cover for stove
Cover for sink/cutting board (2)
Drawer guides, ball bearing with full extension
Extendable free-standing table with 4 chairs
Fluorescent lighting under cabinet
High-rise single lever faucet with pull-out sprayer
Microwave oven with carousel
One piece hard surface countertop with integrated deep bowls
Oversized 21" oven
Paper towel holder
Raised hardwood refrigerator fronts
Silverware drawer, divided for utensils
Toe kicks on all base kitchen cabinets
Wallpaper border

Standard Heat, Power and Water Equipment

12V demand water pump
12V electrical system with 110V, 80-amp power converter
16 gal. equivalent gas/electric auto-ignition water heater
50-amp quick-connect power cord
50-amp electric service
110V G.F.C.I. protected exterior receptacle
A/C chill grill
Battery disconnect switch
Double 30-lb. propane gas bottles, with regulator (in side compartment on sliding tray)
Furnace with wall thermostat, auto-ignition
Holding and fresh water tanks made of rotocast design
Hook-up for city water
In-floor ducted heat
Interior Command Center®
Monitor panel for all systems
Outside utility center in front basement area
Prep for washer/dryer
Vents are pre-wired for attic fan in bedroom and living room
Water heater bypass system
Water lines by Uponor®
Water system winterization kit

Standard Safety Equipment

Breakaway switch
Carbon monoxide alarm
Fire extinguisher
Lock and dead bolt on entrance door
Multiple egress windows
Propane alarm
Smoke alarm
Tinted safety glass windows

Optional Equipment

10 cu. ft. refrigerator
2 Euro chairs ILO rocker recliners
2nd 13,500 BTU A/C in bedroom
Bike rack, with receiver
Booth dinette with 2 drawers (select models)
Carefree® SideOut Cover II awnings for slideouts
Convection microwave
CSA standards
Customer Value Package
Deluxe entertainment center with 42" HD LCD TV (select models)
Exterior entertainment center
Fiberglass shower in lieu of garden tub
Fireplace, 5100 BTU
Front & rear powered roof vent
Front powered roof vent
Generator prep
High-gloss Gel-coat fiberglass sidewall exteriors
MOR/ryde® Suspension & Pin Box Package
Onan® 5500-watt Microlite generator, with auto changeover
Portable, outside gas grill
Provincial Glazed Maple cabinetry
Rear powered roof vent
Remote control front landing gear
Thermal pane tinted safety glass windows
Washer/dryer combination

Standard Equipment



Roomy 8 cu. ft. refrigerator with raised wood-paneled doors



Interior Command Center® that controls generator and slideout functions



Triple entrance step for secure footing



Entrance closet that doubles as a grandfather-style clock



Convenient washer/dryer in bedroom



Exterior entertainment center for outside music

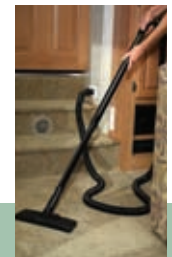

Central vacuum system for quick clean-ups

Optional Equipment

Customer Value Package

The Customer Value Package enhances the comfort and convenience of your Designer fifth wheel with this equipment:

- 20" HD LCD TV in bedroom
- 26" HD LCD TV with pull-out swivel base, Living area
- A** 8-lug polished aluminum wheels
- Bathroom power vent
- Black holding tank sprayer
- Central A/C (15,000 BTU) with quick cool feature & lowered directional ceiling vents
- Central vacuum system
- Decorative fascia boards
- B** Deluxe Cloud Ten™ pillow-top mattress (72" x 80")
- Electric patio awning
- Electric rear stabilizer jacks (2)
- C** Floor-mounted safe
- Foldable, exterior grab handle
- D** Home theater system with Dolby® Digital 5.1
- Outside shower
- Security lights (2)
- Spare tire with carrier
- Water purification system

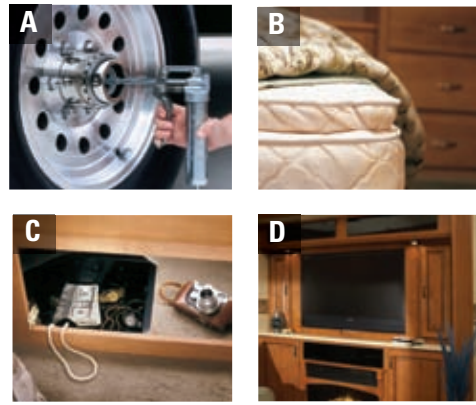

Designer Floorplans

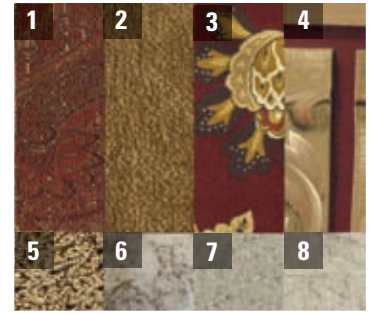
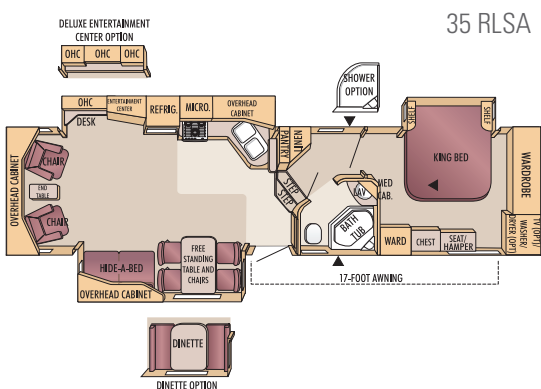
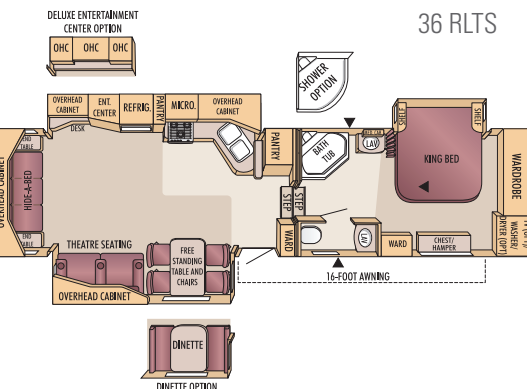
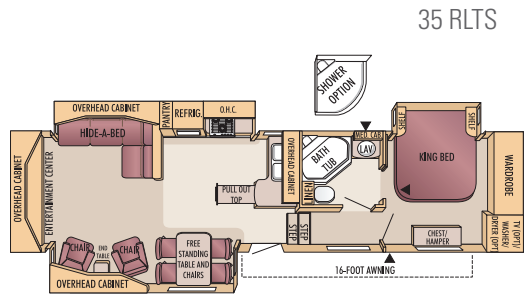
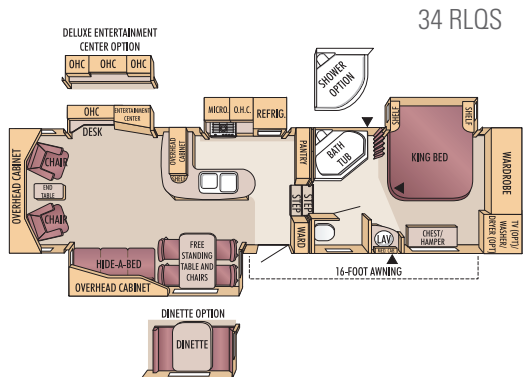
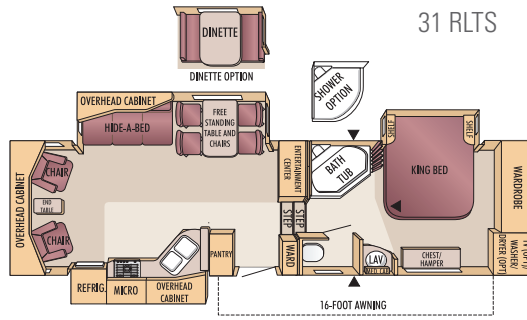

Bravado Brick

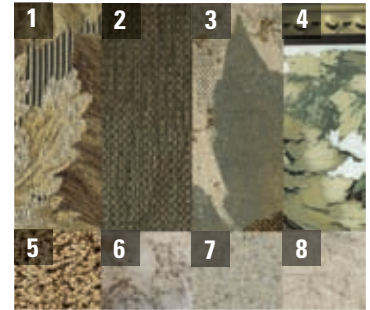

Cape Verde

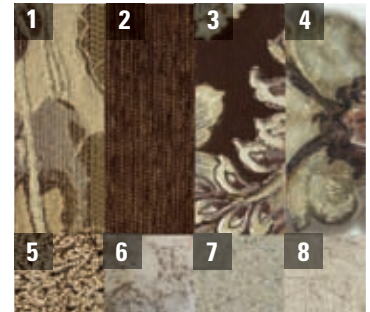

Creme Brule



Grand Cayman Cordovan

1. Main
2. Chair Fabric
3. Bedspread
4. Wallpaper
5. Carpet
6. Vinyl floor
7. Counter top
8. Accent

Floorplans	Exterior Length	Exterior Height (with A/C)	Interior Height	Unloaded Vehicle Weight (lbs.)	Dry Hitch Weight (lbs.)	Gross Vehicle Weight Rating (lbs.)	Cargo Carrying Capacity (lbs.)	Fresh Water Capacity (gal) <small>Includes Water Heater</small>	Gray Wastewater Capacity (gal)	Toilet/Black Wastewater Capacity (gal)
31 RLTS	35' 4"	157"	77"	10,885	2,500	14,500	3,615	85	70	35
34 RLQS	37' 5"	157"	77"	11,445	2,255	15,800	4,355	85	70	35
35 RLSA	38' 2"	157"	77"	11,825	2,200	15,800	3,975	85	70	35
35 RLTS	38' 9"	157"	77"	11,540	2,460	15,800	4,260	85	70	35
36 RLTS	38' 9"	157"	77"	11,490	2,405	15,800	4,310	85	70	35

It is important for your safety and enjoyment that your tow vehicle be adequately sized and equipped to tow and handle the GVWR of the RV you select. Review weights and rating of your tow vehicle and consult a competent advisor for questions or advice. Whether you are new to RVing or a veteran, get a feel for the performance of your tow vehicle and the RV together before heading out on the roadways. When you tow an RV, you must drive differently than you do when driving a single vehicle. Practice hooking up, driving, backing up, and braking in a safe environment or seek out professional instruction. Jayco affixes a weight label to each RV which lists weight information for that vehicle. See specification chart to the left.

Unloaded Vehicle Weight (UVW): Sometimes referred to as "Dry Weight," UVW means the typical weight of this trailer as built at the factory. The UVW, as used in product literature and other promotional materials, does not include cargo, fresh water, propane, options or dealer-installed accessories.

Gross Vehicle Weight Rating (GVWR): GVWR means the maximum permissible weight of the trailer, including the UVW plus passengers, personal items, all cargo, fluids, options and dealer-installed accessories. The GVWR is equal to or greater than the sum of the UVW and the CCC.

Cargo Carrying Capacity (CCC): CCC means the maximum weight of all passengers, personal items, food, fresh water, propane, tools, other cargo and dealer-installed accessories that can be carried by the trailer. CCC is equal to or less than GVWR minus UVW. The addition of options will decrease the CCC.

Hitch Weight (HW): The hitch weight, as used in product literature and other promotional materials, does not include cargo, fresh water, propane gas, options or dealer-installed accessories. The addition of these types of items will either add to or subtract from the stated hitch weight.

Customer First Roadside Assistance

Travel worry-free in your Designer with Jayco's Customer First Roadside Assistance program, yours at no cost during your first year of ownership. This program is offered through Coach-Net®, the largest RV emergency road service in the country, and gives you immediate access to dependable roadside assistance and support services with a simple phone call.

- Free jump starts
- Free tire changes
- Free fuel delivery
- Free lockout service
- Free travelers checks
- 24-hour toll-free emergency message service
- Toll-free nationwide service appointment assistance
- Free custom trip routing and full color map service
- Free dispatch of on-site mechanical service
- \$1,000 auto theft or hit-and-run reward
- \$2,000 trip interruption reimbursement

We Back What We Build.

The Jayco Co-Pilot Warranty is a manufacturer's limited warranty. It comes from the people who build Jayco recreation vehicles to the people who buy them. Each Jayco is warranted to the original purchaser for twenty-four (24) months or twenty-four thousand (24,000) miles (mileage limitation applies to motorized products only), whichever occurs first, from the original date of purchase against defects in materials and workmanship. Jayco's limited warranty is not transferable. Go ahead and compare the Jayco warranty with other manufacturers' warranties. You'll find it's the best in the business!

For a copy of the limited warranty with full terms and conditions, ask your local Jayco dealer.



Your Jayco Dealer

JayPlus

Protect your RV investment. Ask your Jayco dealer about our exclusive JayPlus program today.

Jafari Discover America

As a Jayco owner, you can be part of the Jayco Jafari International Travel Club. Ask your dealer about the Jafari "flight" in your area, write Jayco or visit our website.

polarBARRIER
four season camping by Jayco®

The Jayco Designer was tested in 0 degree Fahrenheit (-17°C) weather over an extended period of time in a controlled environment and all functions of the coach were fully operational. Testing cannot account for natural elements such as wind or moisture. In actual use, unit may not perform as well. In addition, outside components are subject to freezing and require steps to properly insulate. Jayco's warranty does not cover damage caused by freezing.



AMERICA'S MOST LIVEABLE RVs.

Jayco, Inc., P.O. Box 460, Middlebury, IN 46540 www.jayco.com

See dealer for further information and prices. All information in this brochure is the latest available at the time of publication approval. Jayco reserves the right to make changes and to discontinue models without notice or obligation. Photos in this brochure may show optional equipment or props used for photography purposes. RVs built for sale in Canada may differ to conform to Canadian codes. E-Z Lube is a registered trademark of the Dexter Axle Company. Carefree is a registered trademark of Carefree of Colorado. Dolby and the double-D symbol are registered trademarks of Dolby Laboratories. ©2007 Jayco, Inc. 08-DSGN-PL 1207-50K Printed in U.S.A.