

**RECON**  
**ZX**



TOY HAULING  
**WONDER**

FREAKISHLY LIVEABLE

COME ONE, COME ALL  
WITNESS A TOY HISTORY  
WORLD  
ITS ABILITY TO SWALLOW FOUR QUADS  
YOU'LL MARVEL AT ITS ULTRA-  
WHILE ITS AUDIO CAPABILITIES WILL BE  
LADIES AND GENTLEMEN  
HERE RECON



THE ALL  
HAULING  
ER  
WILL ASTOUND  
WIDE BODY  
LOW YOU AWAY  
ELMEN  
ZX

Nothing gets riders more jazzed than cranking up the music. Recon ZX is iPod®-ready and Kicker® speakers-equipped, as it pounds out sound both inside and outside the unit. So whether you're partyin' outdoors or chillin' in the living room, with Recon ZX you'll be surrounded with sound where you want it, when you want it.

AN ABSURDITY OF  
**SOUND**  
INTERNAL & EXTERNAL MELODIES!  
IPOD READY ODDBALL!

*listen outside*

*listen inside*



## THE TRIPLE WONDER

FUEL, AIR, & POWER  
WASH STATIONS AT  
YOUR FINGERTIPS!

Fuel, Air and Power Wash stations are at your fingertips in the Recon ZX. The 25 gallon dedicated fuel tank refuels your toys, the on-board air compressor helps you avoid down-time, and after a dirty day of riding, use the power washer to keep your machine looking buffed. With Recon ZX dialed in to all the gear you need, you're always ready to ride.





**Top:** Things like the fully adjustable Norcold® refrigerator, solid-surface countertops and the recessed sink and range make for an extremely liveable kitchen in the Recon ZX.

**Above:** With features like the neo-angle shower with glass door and the high-capacity fan in the bathroom, Recon ZX offers plenty of space and amenities for reviving yourself.



ENORMOUS  
**WIDE  
 BODY**  
 102 INCHES ACROSS

Combine Recon ZX's 102 inch-wide girth and its multiple mega slideout rooms, and you end up with nearly 400 square feet of living and garage space. Whether it's sleeping, working, playing or just hanging out, Recon ZX has the elbow room you need to do it all.

**Above:** Recon ZX's space-saving U-Dinette/sofa combo, tile-look flooring and Sony® Stereo and DVD system with game system prep provide a comfortable place to kick back after a long day of play.

**Right:** The optional flat panel LCD TV, convenient bedroom laundry hamper and pillow-top mattresses make the Recon ZX bedroom a perfect place for a little R&R.



### **A GREAT YEAR TO BUY**

In honor of Jayco's 40th Anniversary, we've added special features to the 2008 Recon ZX models including an electric awning, flat screen LCD TV and adjustable dream dinette. Ask your Jayco dealer for complete details.



THE AMAZING

# QUAD SWALLOWER

GOBBLES UP TO  
FOUR ATVS AT A TIME!

Recon ZX gobbles up quads like no other toy hauler, easily taking in up to four quads, numerous bikes or a side x side. No matter what you've got, you can rest assured that with Recon ZX you can "bring it." Its no-skid cargo ramps are 8 feet wide, and the heavy-duty tie-downs keep your toys safe and sound 'til you're ready to ride.

**Below:** Recon ZX's 8-foot wide ramp and side-entry door gives easy access to the innovative cargo area, designed with you and your toys in mind.

**Right:** Dual electric queen beds are easy to lower and raise in the cargo area, helping provide comfortable sleeping space for a total of up to 12 people in the Recon ZX.





**Above:** The bunk over the cargo area is perfect as an extra storage space or a nice little getaway spot to catch some quick zzz's.

**Middle left:** The handy U-dinette/sofa combo folds down and out into twin beds when it's time to crash.

# WALLS & STRENGTH

The rigors of the road make Recon ZX's longer lasting TuffShell™ vacuum-bonded laminated sidewalls a must. The welded aluminum framing, high density foam block insulation, backer plates for the cabinets, and easily maintained gel-coat fiberglass walls offer a rugged alternative for serious RVers. If these walls could talk, they'd talk tough—exactly what you'd expect from a toy hauler that's built to last.



## CONSTRUCTION AND DESIGN

- 1** The radius-cornered ramp door has a weight capacity of 2500 lbs. and is designed for safety.
- 2** Durable non-slip flooring makes for worry-free trips up and down the ramp.
- 3** 3/16" plywood board adds strength to the sidewalls.
- 4** Foam insulation in floors and sidewalls (R-11 in roof and R-9 in sidewalls) helps keep the interior comfortable.
- 5** 3/8" plywood in roof construction
- 6** One-piece, seamless rubber roof shrugs off the hardest rains, reflects heat and reduces noise.
- 7** Roof rafters are constructed of strong, residential-style 4-1/2" trusses.
- 8** Easy-care carpet is included in select areas.
- 9** Carpet pad enhances the comfort and durability of the carpet.
- 10** 2" laminate floor contains 3/8" seamless Structurwood® main floor decking and provides a firm foundation.
- 11** Welded tubular aluminium sidewall framework offers lightweight durability.
- 12** Like the sidewall framework, the floor frame is built of aluminum.
- 13** Driveable aluminum welded wheel wells.
- 14** Fiberglass insulation in underbelly (R-7) and roof construction (R-11).
- 15** One-piece underbelly covering greatly reduces drag for better fuel economy and protects from grime and road debris.
- 16** TuffShell™ vacuum-bonded laminated high gloss sidewalls are sleek and aerodynamic.
- 17** We simplified the "ins and outs" with the Big Easy™ triple retractable main entrance steps.
- 18** Enjoy smoother rides with the optional MOR/ryde® pin box and suspension package.
- 19** The central command center gives you control of all power functions from a convenient single location.
- 20** Outside compartments are large enough for all your sport or travel gear.
- 21** Our tie-down rings are each rated for 2,500 pounds and keep your ATVs, motorcycles and other toys stationary during travel.
- 22** Recon ZX includes several handy storage spaces including an easy access tool compartment located in the floor of the garage.
- 23** Mill-finished aluminum shelves and work-space keep your tools close at hand.
- 24** It's easy to keep your toys securely stowed away with this cam-style ramp door latch with built-in lock.
- 25** With the optional power jump pack, you'll have battery power wherever you go.





## FLOORPLANS



**F36V**

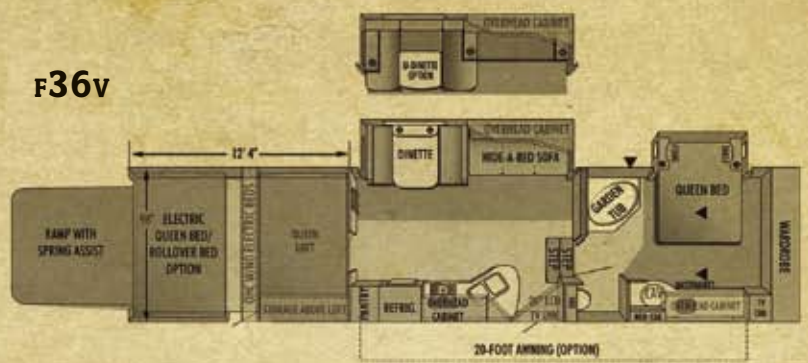

**F37U**

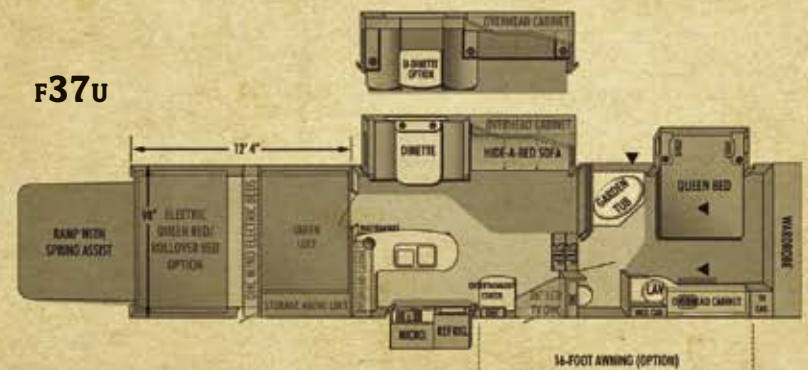

## STANDARDS AND OPTIONS

### Standard Bathroom Equipment

- Bar and towel ring
- Large sink in bathroom
- Marine toilet w/foot flush
- Medicine cabinet with mirror and key hooks
- Switches for all lights
- Toilet paper holder
- Magazine Rack

### Standard Bedroom Equipment

- Accordian-style bedroom door
- Ball-bearing drawer guides
- Below countertop waste basket location
- Under bed storage, bed lifts on gas struts
- Queen size pillow-top mattress (60x80)
- Quilted fitted bedspread
- Carpeting with padding
- Shoe shelf in closet

### Standard Construction Features

- 2" laminated construction of floor
- 10-1/2" solid steel outriggers
- 102" wide body
- 3/8" decking on roof
- Electric-powered slideout
- Cabinetry crafted w/screwed stile construction
- Frame made of double stacked 12" tubular, cambered steel (F36V & F37U)
- High-Gloss Lamilux 4000 fiberglass sidewalls
- One piece, seamless, rubber roof
- PolyFlex™ one-piece underbelly cover
- R-11 insulation in roof, R-9 in sidewalls, R-9 in floors, R-15 in slide-out floors
- Roof rafters, constructed of residential-style tapered 4-1/2" trusses
- Structurwood™ main floor decking
- TuffShell™ vacuum-bonded laminated sidewalls
- Welded tubular-aluminum sidewall and floor framework
- Wired and framed for second A/C

### Standard Exterior Equipment

- 12V light for hitch
- 16" radial tires
- Battery box for three batteries
- Big Easy™ double retractable garage entrance step
- Big Easy™ triple retractable main entrance step
- Entrance door is fiberglass and radius cornered with screen door
- Diamond-plated panel on front
- Electric-powered front jacks
- Jayco ZX exterior speakers
- Jayco ZX step faceplate
- Lockable, radius-cornered baggage doors
- Mill-finished aluminum fender skirts
- Rain guttering, molded with drip spouts
- Patio light with inside switch
- Rear ramp lights (2)
- Satellite hookup with RG6 connection
- Shock clips on frame and axles
- Triple axles with E-Z Lube feature
- Tuff-ply™, rubberized floor liner on garage floor

### Standard Interior Equipment

- 26" LCD TV
- Brushed nickel hardware
- Cupholders in dinette
- Crank up TV antenna with signal booster
- Deep-lipped overhead cabinetry
- Drawer storage below dinette seats

- Dream dinette mechanism, raises and lowers dinette table top
- Driveable welded wheel wells
- Game system prep
- Garage vent ports
- Jayco ZX furniture
- Night shades throughout
- High-intensity 12V lighting package
- Multi-directional louvered central A/C vents
- Satellite TV hookup with RG6 connection
- Six panel passage doors throughout
- Fabric-covered box valances with lambrequin legs
- Tie-down rings are flush floor-mounted, anchored to frame, 2500 lbs. capacity each
- Vinyl flooring in living and bath areas
- Wall-mounted ladder (F36V)

### Standard Kitchen Equipment

- Ball-bearing drawer guides
- Below countertop waste basket location (F37U)
- Brushed nickel mixing high-rise faucet
- Cover for sink/cutting board (2)
- Deep recessed residential-style sink
- Drawer for silverware, divided for utensils
- J-Stone™ solid surface countertops
- Overhead range hood with light and exhaust fan
- Recessed 3-burner range with 9000 BTU SuperBurner™ and piezo igniter
- Oversized oven

### Standard Power, Water and Heat

- 110V G.F.C.I. protected exterior receptacle (4)
- 12V electrical system with deluxe 110V 75-amp power converter
- 135 gallon fresh water capacity
- 1800 watt Xantrex inverter
- 12V demand water pump
- 50-amp electric service
- 50-amp quick-connect power cord and storage bracket
- 5500W Onan® generator with 25 gallon fuel tank
- Automatic transfer switch with generator or generator prep
- A/C chill grill
- Battery disconnect switch
- Black holding tank sprayer
- Concealed black and gray tank valves
- Double 30-lb. propane gas bottles, w/ regulator
- Furnace with wall thermostat, auto-ignition
- Fuel station with 25 gallon fuel tank
- Hook-up for city water
- Outside shower
- Prep for solar panel
- Recessed Jayco ZX command center with sliding glass door
- Sewer hose storage compartment
- Water heater bypass system
- Water system winterization kit

### Standard Ramp & Cargo Equipment

- 7' 10" door/ramp, 2500 lbs. capacity
- 96" wide ramp door opening
- Beaver tail transition ramp
- Cam style locks on ramp door
- Hinge spring assist
- No-skid flooring
- Rear retractable screen wall
- Welded steel storage compartment in garage floor

### Standard Safety Equipment

- Break-away switch
- Carbon monoxide alarm
- Fire extinguisher
- Lock and dead bolt on entrance doors
- Multiple egress windows
- Propane alarm
- Tinted safety glass windows
- Smoke alarm

### Customer Value Package

- 12V AM/FM/CD/DVD stereo, iPod adapter/charger and 4 Kicker® speakers
- 10/16 XLT gal. gas/electric DSI auto-ignition water heater
- 15,000 BTU central A/C
- 16" spare tire w/ carrier mounted under cargo area
- 8 cu. ft. flush-mount double door refrigerator
- Carefree® Travl'r 12 volt electric patio awning
- Manchester Oak raised paneled doors and drawers
- Deluxe pillowtop mattress
- Insulated holding tanks
- Microwave oven with carousel
- Flush-mount bi-fold cover for range
- Neo-angle tub/shower with ABS surround
- Rack for luggage, ladder also included
- Rear stabilizer jacks (2)
- Security lights (2)
- Shock absorbers
- Skylight in tub/shower
- Water purification system

### Optional Equipment

- 20" LCD TV (s)
- 37" LCD TV
- 2nd A/C in cargo area
- Aluminum rims
- Cargo area powered roof vent
- Customer Value Package
- Electric rear stabilizer jacks
- Electric queen bunk bed w/ rollover sofa
- Kicker® subwoofer and amplifier w/ exterior remote
- MOR/ryde pin box and suspension package
- Patio screen room and rear awning
- Portable, outside gas grill
- Power Package
- Roll up carpet
- Thermal pane windows
- ToyLok® retractable security cable
- U-shaped dinette & sofa combo

tread lightly!®  
OFFICIAL SPONSOR



Jayco proudly sponsors Tread Lightly!®, a nonprofit organization whose mission is to empower generations to enjoy the outdoors responsibly through education and restoration.

## SPECIFICATIONS AND MEASUREMENTS

FLOORPLANS	F36V	F37U
EXTERIOR LENGTH	40'	40'
EXTERIOR HEIGHT (W./A./C)	157"	157"
INTERIOR HEIGHT	77"	77"
UNLOADED VEHICLE WEIGHT	13,555	13,220
DRY HITCH WEIGHT (LBS.)	3,500	3,365
GROSS VEHICLE WEIGHT RATING (LBS.)	18,000	18,000
CARGO CARRYING CAPACITY	4,445	4,780
FRESH WATER (GAL.) INCLUDES WATER	143	143
GRAY WASTEWATER (GAL.)	97	85
TOILET/BLACK WASTEWATER (GAL.)	47	47

It is important for your safety and enjoyment that your tow vehicle be adequately sized and equipped to tow and handle the GVWR of the RV you select. Review weights and rating of your tow vehicle and consult a competent advisor for questions or advice. Whether you are new to RVing or a veteran, get a feel for the performance of your tow vehicle and the RV together before heading out on the roadways. When you tow an RV, you must drive differently than you do when driving a single vehicle. Practice hooking up, driving, backing up, and braking in a safe environment or seek out professional instruction. Jayco affixes a weight label to each RV which lists weight information for that vehicle. See specification chart above.

### Unloaded Vehicle Weight (UVW)

Sometimes referred to as "Dry Weight," UVW means the typical weight of this trailer as built at the factory. The UVW, as used in product literature and other promotional materials, does not include cargo, fresh water, propane, options, or dealer-installed accessories.

### Gross Vehicle Weight Rating (GVWR)

GVWR means the maximum permissible weight of the trailer, including the UVW plus passengers, personal items, all cargo, fluids, options, and dealer-installed accessories. The GVWR is equal to or greater than the sum of the UVW and the CCC.

### Cargo Carrying Capacity (CCC)

CCC means the maximum weight of all passengers, personal items, food, fresh water, propane, tools, other cargo, and dealer-installed accessories that can be carried by the trailer. CCC is equal to or less than GVWR minus UVW. The addition of options will decrease the CCC.

### Hitch Weight (HW)

The hitch weight, as used in product literature and other promotional materials, does not include cargo, fresh water, propane gas, options or dealer-installed accessories. The addition of these types of items will either add to or subtract from the stated hitch weight.

# BRIAN DEEGAN

AND JAYCO

As the originator of numerous motocross tricks and winner of ten X-Games medals, Brian Deegan uses only the best—Jayco ZX—to haul his family and his Honda 250 to his next event. Jayco wishes Brian the best in his efforts to continue radicalizing the sport of motocross freestyle and appreciates his endorsement of the Jayco ZX products.



## INTERIOR COLOR OPTIONS



### GRAPHITE



### OASIS



### DUNES

- 1 Main Upholstery
- 2 Chair Upholstery
- 3 Bedspread
- 4 Drapery
- 5 Carpet
- 6 Accent Panel
- 7 Countertop
- 8 Wood

## CUSTOMER FIRST ROADSIDE ASSISTANCE

Travel worry-free in your Recon ZX with Jayco's Customer First Roadside Assistance program, yours at no cost during your first year of ownership. This program is offered through Coach-Net®, the largest RV emergency road service in the country, and gives you immediate access to dependable roadside assistance and support services with a simple phone call.

### Emergency Roadside Assistance

- 24-hour toll-free emergency message service
- \$2,000 trip interruption reimbursement
- Toll-free nationwide service appointment assistance
- **Free** custom trip routing and full color map service
- **Free** dispatch of on-site mechanical service
- \$1,000 auto theft or hit-and-run reward
- **Free** jump starts
- **Free** tire changes
- **Free** fuel delivery
- **Free** lockout service
- **Free** travelers checks



## WE BACK WHAT WE BUILD

The Jayco Co-Pilot Warranty is a manufacturer's limited warranty. It comes from the people who build Jayco recreation vehicles to the people who buy them. Each Jayco is warranted to the original purchaser for twenty-four (24) months or twenty-four thousand (24,000) miles (mileage limitation applies to motorized products only), whichever occurs first, from the original date of purchase against defects in materials and workmanship. Jayco's limited warranty is not transferable. Go ahead and compare the Jayco warranty with other manufacturers' warranties. You'll find it's the best in the business!

For a copy of the limited warranty with full terms and conditions, ask your local Jayco dealer.

As a Jayco owner, you can be part of the Jayco Jafari International Travel Club. Ask your dealer about the Jafari "flight" in your area, write Jayco or visit our website.



Please Note: All information in this brochure is the latest available at the time of publication approval. Jayco reserves the right to make changes and to discontinue models without notice or obligation. Photos in this brochure may show optional equipment or props used for photography purposes. RVs built for sale in Canada may differ to conform to Canadian codes.

©2007 Jayco, Inc. 08-REC-PL 0707-100K Printed in U.S.A.



AMERICA'S MOST **LIVEABLE** RVs.

Jayco, Inc., P.O. Box 460, Middlebury, IN 46540 [www.jayco.com](http://www.jayco.com)