

Designer™

2009 Fifth Wheels by Jayco®

2009 Designer Fifth Wheels by Jayco®



Jayco

AMERICA'S MOST LIVEABLE RVS.



DESIGNER

Designer™
2009 Fifth Wheels by Jayco®

Luxury Done the Affordable Way

You've worked hard to get to this point in your life. Savor the moment. Enjoy the finer things and relish the little details. Jayco has redesigned the 2009 Designer with you in mind—from the decorative drawer-pulls to the Provincial Glazed Maple hardwood cabinetry to the Store-Galore™ basement. The 2009 Designer features premium materials and upscale touches, providing a luxurious environment for just the week or perhaps the winter. Whatever your RV lifestyle, Jayco believes the best things in life don't always have to cost a lot.



DESIGNER

The 2009 Designer offers many high-quality amenities in a variety of floorplans that sleep 4 to 6 people. Designed to be a luxury suite on wheels, the Designer is ideal for extended stays, long trips or winters in sunnier climates.



Built For Liveability

Durable Construction

Designer fifth wheels are constructed with high quality materials using production techniques perfected over the past 40 years. The seamless one-piece rubber roof with a 5" thick, TuffShell™ vacuum-bonded laminated roof **1** along with a heated and enclosed underbelly **2** provide comfort in all seasons.

Designed For Convenience

Many features on the Designer are designed to make travel more enjoyable and liveable such as attractive easy-care carpet **3**, high-quality carpet pads which provide enhanced durability and comfort, and the Store Galore basement storage **4**.

Built for Comfort

Jayco's welded tubular-aluminum sidewall framing and bead-foam insulation (R-9) **5** in the Designer's sidewalls help keep the living space comfortable. The FRP smooth fiberglass sidewalls **6** provide a sleek, aerodynamic look.



Value Defined

The Designer Customer Value Package offers amenities such as 15,000 BTU central air conditioning **7**, deluxe Cloud Ten™ pillow-top mattress, Multi-Media Premium Sound System™ AM/FM/CD/DVD stereo with an MP3 and iPod® input jack, outside shower, a 19" HD LCD TV in the bedroom and a 32" HD LCD TV.



Protection from the Elements

Extend the camping season with Jayco's Polar Barrier™ 4-season thermal package. Designed for efficient heating and cooling, Polar Barrier™ protects against freezing, even when temperatures drop as low as 0° F (-17° C).



Take the Road Less Traveled

No matter which way the wind blows, you'll find that towing your 2009 Designer is easier and more reliable than other comparable fifth wheels. With the MOR/ryde® suspension and the light weight, welded aluminum-framed sidewalls, towing the Designer can be as luxurious as staying in one. Once you arrive, the Wide-Trac™ landing gear increases stability wherever you decide to park.



Take in the view through the enlarged picture window in the living and dining areas. Relax on the oversized sofa or entertain at the sleek, expandable table and chairs.

Designer™

2009 Fifth Wheels by Jayco®



Designer™

2009 Fifth Wheels by Jayco®



Create Culinary Memories

Perfect for the recreational chef, the Designer's kitchen serves up a scrumptious blend of handcrafted cabinetry in Provincial Glazed Maple hardwood, first-class appliances, solid J-Stone® countertops and oil-rubbed bronze lighting and fixtures. The warmth of this well-designed space is sure to be one of your guests' favorite items on the menu.





34RLQS | MOCHA



You'll be well-equipped for movie night with this optional deluxe entertainment center featuring a 42" LCD TV and Multi-Media Premium Sound System™ AM/FM/CD/DVD stereo with an MP3 and iPod® input jack.



Convenience and comfort are key with the queen size bed in this bedroom that features plenty of wardrobe space and adjoining bathroom amenities.



There's plenty of room to relax in the richly appointed bedroom featuring Jayco's Cloud Ten™ mattress, decorative headboard, reading lights and ample storage.

Designer™

2009 Fifth Wheels by Jayco®



Find Your Home on the Road

It's said that home is where you hang your hat. The 2009 Designer not only allows you to hang your hat, but to bring all the comforts of home with you while you're out enjoying your favorite destination.

The luxurious seating options, well-designed living space, and finer touches such as the optional 5,100 BTU fireplace, 42" LCD TV and Multi-Media Premium Sound System™ will make you feel comfortable and at home no matter which gorgeous view can be seen out the picture windows.





35RLTS | SLATE



All the conveniences of a modern kitchen are within reach and easy to find along with plenty of pantry space and storage.



The bathroom includes a 34" fiberglass radius shower with a skylight, glass shower door and residential style medicine cabinet with mirror.



Dream sweet dreams on the queen-size bed or watch the late night shows after a fun-filled day of adventures. The bedroom area is designed for relaxing and unwinding.



A LEGACY OF CRAFTSMANSHIP.

Jayco's dedicated production team includes Amish craftsmen who build with well-honed woodworking techniques passed down for generations and skilled seamstresses who produce our upholstery, bedding and draperies with great attention to detail.



STANDARDS AND OPTIONS

STANDARD BATHROOM EQUIPMENT

6-panel residential style passage doors
Adjustable shower head
Ducted heating
Fiberglass radius shower
Oil-rubbed bronze fixtures
Radius glass shower door
Residential medicine cabinet w/mirror
Skylight in tub/shower
Thetford porcelain stool with foot pedal
Toilet paper holder
Towel holder
Wall switches for all lights
Window in commode area

STANDARD BEDROOM EQUIPMENT

Accordian-style bedroom door (select models)
Bed lifts up easily on struts, 2 ABS storage bins below
Decorative headboard
Decorative pillows for bed
Dresser drawers, residential style
Dresser lamp
Laundry hamper
Nightstands next to bed
Queen Bed
Quilted bedspread with 2 pillow shams
TV cabinet with satellite and cable jacks

STANDARD CONSTRUCTION FEATURES

5/8" tongue and groove plywood main floor decking
Bead-foam insulation (R-9 in sidewalls, R-25 in roof)
Electric-powered slideout
Enclosed, insulated and heated underbelly
FRP smooth fiberglass sidewall exteriors
Hardwood cabinetry crafted w/ screwed stile construction
I-Class® cambered structural steel I-Beam frames
Long pin box
One piece, seamless rubber roof
Poly-Flex™ one piece underbelly covering
Reflective foil insulation in main and bedroom floor and all slideout floors
TuffShell™ vacuum-bonded laminated sidewalls
Vacuum-bonded 5" crowned laminated roof
Welded aluminum floor studs on 16" centers
Welded tubular aluminum sidewall framework

STANDARD EXTERIOR EQUIPMENT

12V hitch light
16" radial tires
ABS fender skirts
Battery box for two batteries
Black-framed, radius-cornered, awning style windows w/tinted safety glass
Bracketry for 50 amp power cord in front basement
Caps on front and rear made of fiberglass w/radius corners
Electric-powered front jacks
E-Z Lube® axles
Fiberglass, radius cornered entrance door w/screen door
Front jacks w/quick release pins
Galvanized steel wheel wells
Ladder to roof
L.E.D. taillights
Lockable, insulated and radius-cornered baggage doors w/heavy-duty grab handles
Outdoor Media Center
Painted bottom radius skirting

Patio light w/inside switch
Rain guttering, molded w/drip spouts
Sidewall corners radiused at top and bottom
Store-Galore™ basement storage
Street-side utility light
Triple retractable main entrance step

STANDARD HEAT, POWER AND WATER EQUIPMENT

110V G.F.C.I. protected exterior receptacle
12 gal. gas/electric DSI auto-ignition water heater
12V demand water pump
12V electrical system with 110V, 80 amp power converter
50 amp electric service
50 amp quick-connect power cord
A/C chill grill
Battery disconnect switch
Double 30 lb. propane gas bottles, w/regulator (in side compartment on sliding tray)
Furnace with wall thermostat, auto-ignition
Holding and fresh water tanks made with rotocast design
Hookup for city water
In-floor ducted heat
Interior Command Center®
Monitor panel for all systems
Prep for solar panel
Prep for washer/dryer
Uni-Dock™ utility center, heated and enclosed
Vents pre-wired for attic fan in bedroom and living room
Water heater bypass system
Water system winterization kit

STANDARD INTERIOR EQUIPMENT

Ball bearing drawer guides throughout
Cable TV hookup w/RG6 coax cabling
Carpeting w/padding throughout unit
Ceiling fan w/light
Crank-up digital TV antenna with signal booster
Decorative oil rubbed bronze lighting throughout
Decorative throw pillows for hide-a-bed
End table with built-in magazine rack
Entertainment center
Hardwood cabinet stiles
Hide-a-bed sofa (air mattress)
High-intensity 12V lighting package
Linoleum floor in entryway
Message center
Overhead cabinetry in slideout room with raised panel doors
Pleated day/night shades
Prep for satellite dish for roof and sidewall
Provincial Glazed Maple raised-paneled doors and drawers
Residential-style trim and molding
Rocker recliner(s)
Sliding windows in slideout end walls
Solid hardwood interior entry grab handle
SuperSlide™ w/flush-floor design

STANDARD KITCHEN EQUIPMENT

3-burner range w/9,000 BTU SuperBurner™ and piezo igniter
8 cu. ft. refrigerator w/double door
Bi-fold, recessed cover for stove
Extendable free-standing table with 4 chairs
Fluorescent lighting under cabinet
High-rise single lever faucet w/pull-out sprayer
J-Stone™ cover for sink/cutting board (2)
Microwave oven w/carousel
One piece J-Stone™ surface countertop w/integrated deep bowls
Oversized 21" oven

Paper towel holder
Raised hardwood refrigerator fronts
Silverware drawer, divided for utensils
Sponge holder under sink
Wallpaper border

STANDARD SAFETY EQUIPMENT

Breakaway switch
Carbon monoxide alarm
Fire extinguisher
Lock and dead bolt on entrance door
Multiple egress windows
Propane alarm
Smoke alarm
Tinted safety glass windows

OPTIONS

10 cu. ft. refrigerator
2 euro chairs ILO rocker recliners (select models)
2 leather recliners ILO fabric recliners (select models)
2nd 13,500 BTU A/C in bedroom w/ wall thermostat
Bike rack
Booth dinette w/2 drawers (select models)
Carefree® SideOut Cover II awnings for slideouts
Convection microwave
CSA standards
Customer Value Package
Deluxe entertainment center w/42" HD LCD TV
Electric stabilizer jacks
Fiberglass garden tub in lieu of fiberglass shower
Fireplace, 5,100 BTU
Front & rear powered roof vent
Front powered roof vent
Generator prep
High-gloss Gel-coat fiberglass sidewall exteriors
King bed
MOR/ryde® pin box
Onan® 5,500 watt Microlite generator w/auto changeover (generator prep included)
Portable outside gas grill
Rear powered roof vent
Remote control front landing gear
Satellite kit
Thermal pane tinted safety glass windows
Washer/dryer combination

CUSTOMER VALUE PACKAGE

19" digital LCD TV in bedroom
32" digital LCD TV in living area
8 lug polished aluminum wheels
15,000 BTU central A/C with quick cool feature, louvered directional ceiling vents
Bathroom power vent
Black holding tank sprayer
Carefree® Travl'r 12 volt electric patio awning
Central vacuum system
Decorative fascia board
Deluxe Cloud Ten™ pillow-top mattress (60" x 80")
Floor mounted safe
Foldable, exterior grab handle
MOR/ryde® hub suspension
Multi-Media Premium Sound System™ AM/FM/CD/DVD stereo with MP3 and iPod® input jack
Outside shower
Security lights (2)
Spare tire with carrier
Water purification system

SPECIFICATIONS		Exterior Height	Bedroom Interior Height	Unloaded Vehicle Weight	Dry Hitch Weight (lbs.)	Gross Vehicle Weight Rating (lbs.)	Cargo Carrying Capacity (lbs.)	Fresh Water Capacity (gal.)	Gray Wastewater Capacity (gal.)	Toilet/Black Wastewater Capacity (gal.)	
	Floorplan	Exterior Length	(with A/C)					(Includes water heater)			
Designer Fifth Wheel	34RLQS	37' 5"	159	77"	11,210	2,290	15,800	4,590	87	87	52
	35RLSA	35' 10"	159	77"	11,210	2,455	15,800	4,590	87	87	52
	35RLTS	38' 2"	157	77"	11,410	2,350	15,800	4,390	87	87	52
	36RLTS	37' 9"	159	77"	11,110	2,435	15,800	4,690	87	87	52
	37RLQS	TBD	TBD	TBD	TBD	TBD	TBD	TBD	TBD	TBD	TBD

It is important for your safety and enjoyment that your tow vehicle be adequately sized and equipped to tow and handle the GVWR of the RV you select. Review weights and rating of your tow vehicle and consult a competent advisor for questions or advice. Whether you are new to RVing or a veteran, get a feel for the performance of your tow vehicle and the RV together before heading out on the roadways. When you tow an RV, you must drive differently than you do when driving a single vehicle. Practice hooking up, driving, backing up and braking in a safe environment or seek out professional instruction. Jayco affixes a weight label to each RV which lists weight information for that vehicle. See specification chart above.

Unloaded Vehicle Weight (UUV): Sometimes referred to as "Dry Weight," UUV means the typical weight of this trailer as built at the factory. The UUV, as used in product literature and other promotional materials, does not include cargo, fresh water, propane, options or dealer-installed accessories.

Gross Vehicle Weight Rating (GVWR): GVWR means the maximum permissible weight of the trailer, including the UUV plus passengers, personal items, all cargo, fluids, options, and dealer-installed accessories. The GVWR is equal to or greater than the sum of the UUV and the CCC.

Cargo Carrying Capacity (CCC): CCC means the maximum weight of all passengers, personal items, food, fresh water, propane, tools, other cargo and dealer-installed accessories that can be carried by the trailer. CCC is equal to or less than GVWR minus UUV. The addition of options will decrease the CCC.

Hitch Weight (HW): The hitch weight, as used in product literature and other promotional materials, does not include cargo, fresh water, propane gas, options or dealer-installed accessories. The addition of these types of items will either add to or subtract from the stated hitch weight.

FLOORPLANS

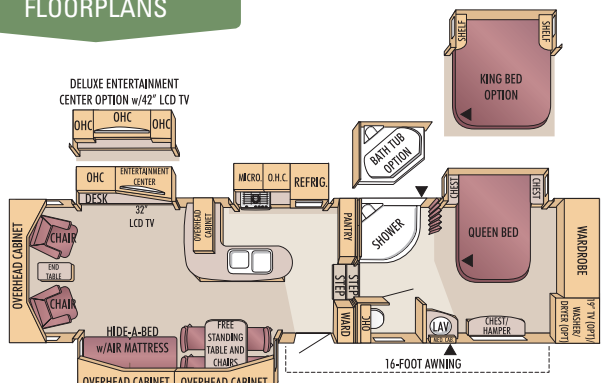

34 RLQS

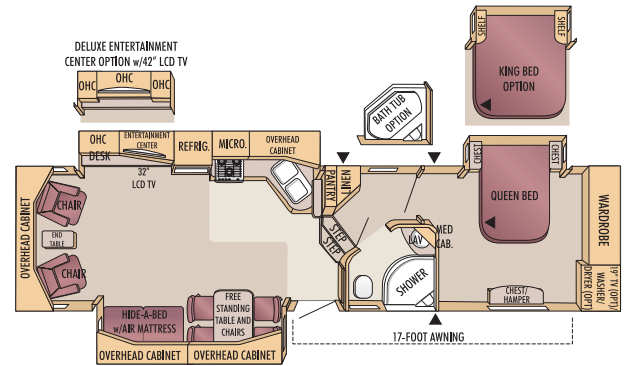
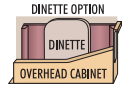

35 RLSA

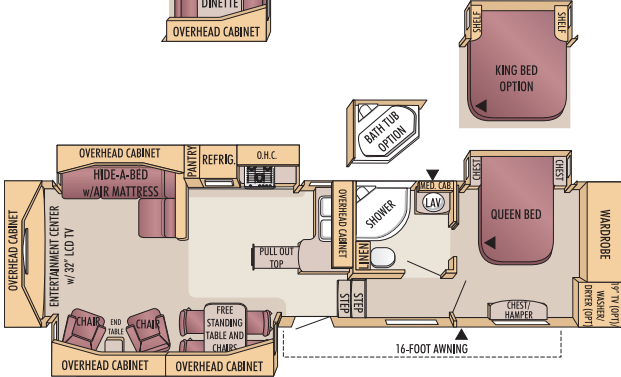
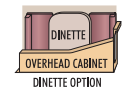

35 RLTS

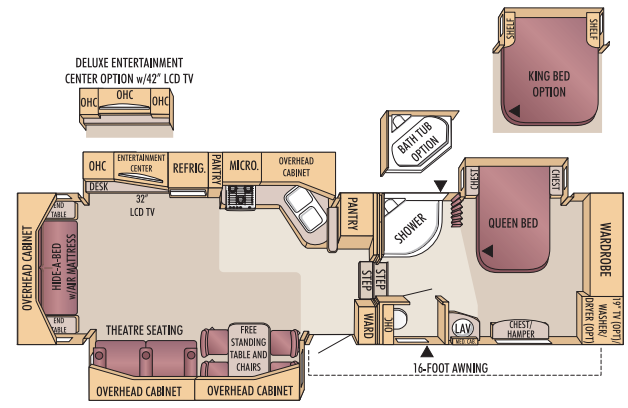

36 RLTS

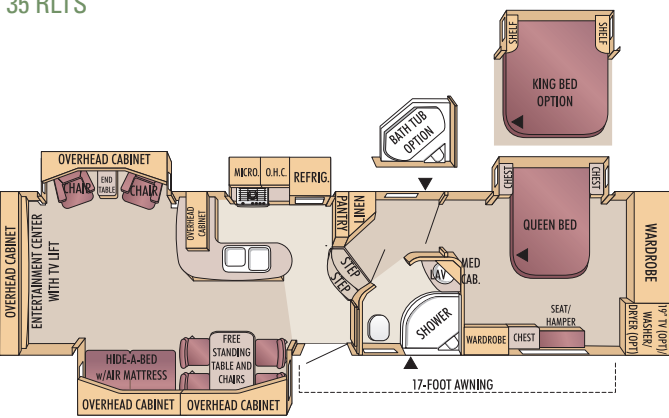
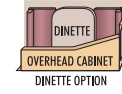

37 RLQS

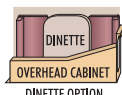

LEGEND

▲ = Outside Storage Compartments LAV. = Bathroom Sink MICRO. = Microwave OHC. = Overhead Cabinets REFRIG. = Refrigerator WARD. = Wardrobe

COLOR OPTIONS



Slate



Mocha



Brick

1. Chair Upholstery 2. Main Upholstery 3. Bedspread 4. Wallpaper 5. Carpet 6. Vinyl Floor 7. Countertop 8. Accent Panel



AMERICA'S MOST **LIVEABLE** RVs.

IT'S ALWAYS BEEN ABOUT "LIVEABILITY"

Lloyd Bontrager went into the RV manufacturing business in 1968 to improve the camping trailer lifter system. He knew that a better lifter system would mean a more "liveable" camping experience for his family and so many others.

More than forty years later, and now the largest family-owned RV manufacturer in the world, this priority still rings true at Jayco. As we work to continue building "America's Most Liveable RVs", we do it with one goal in mind—to improve the RV experience and help make "family time" truly memorable.



We Back What We Build

The Jayco Co-Pilot Warranty is a manufacturer's limited warranty. It comes from the people who build Jayco recreation vehicles to the people who buy them. Each Jayco is warranted to the original purchaser for twenty-four (24) months or twenty-four thousand (24,000) miles (mileage limitation applies to motorized products only), whichever occurs first, from the original date of purchase against defects in materials and workmanship. Jayco's limited warranty is not transferable. Go ahead and compare the Jayco warranty with other manufacturers' warranties. You'll find it's the best in the business!

For a copy of the limited warranty with full terms and conditions, ask your local Jayco dealer.



Why a Local Jayco Dealer is Important to You

Establishing a solid relationship with your local Jayco dealer is a key component in the enjoyment of your new Jayco. By purchasing from a local dealer, you will have a convenient location for sales, parts and service support.

Jayco dealers are required to deliver all products at the site of the sale to ensure a full product orientation and walkthrough at the time of delivery. It's a good way to become familiar with your Jayco and to meet the service, parts and warranty staff members who will be assisting you. If you live in Canada, there are regulations that must be met when buying a Jayco RV. Your local Canadian dealer is a professional at meeting these requirements and regulations. There simply is no substitute for a good relationship with your local Jayco dealer.

Your Jayco Dealer

A large, empty rounded rectangular box intended for a customer to write down the name and address of their local Jayco dealer.

Customer First Roadside Assistance

Travel worry-free in your Designer™ with Jayco's Customer First Roadside Assistance program, yours at no cost during your first year of ownership. This program is offered through Coach-Net®, the largest RV emergency road service in the country, and gives you immediate access to dependable roadside assistance and support services with a simple phone call.

- **Free** jump starts
- **Free** tire changes
- **Free** fuel delivery
- **Free** lockout service
- **Free** travelers checks
- Toll-free nationwide service appointment assistance
- 24-hour toll-free emergency message service
- **Free** custom trip routing and full color map service
- **Free** dispatch of on-site mechanical service
- \$2,000 trip interruption reimbursement



Jayco proudly sponsors Tread Lightly!®, a nonprofit organization whose mission is to empower generations to enjoy the outdoors responsibly through education and restoration.



From RV insurance to extended warranties, JayPlus has it covered. Ask your Jayco dealer about our exclusive JayPlus program today.



As a Jayco owner, you can be part of the Jayco Jafari International Travel Club. Ask your dealer about the Jafari "flight" in your area, write Jayco or visit our website.

Jayco, Inc., P.O. Box 460, Middlebury, IN 46540, www.jayco.com 

See dealer for further information and prices. All information in this brochure is the latest available at the time of publication approval. Jayco reserves the right to make changes and to discontinue models without notice or obligation. Photos in this brochure may show optional equipment and props for photography purposes. RVs built for sale in Canada may differ to conform to Canadian codes. E-Z Lube is a registered trademark of the Dexter Axle Company. Carefree is a registered trademark of Carefree of Colorado. Dolby and the double-D symbol are registered trademarks of Dolby Laboratories. ©2009 Jayco, Inc. 09-DSGN-PL 0708-100K Printed in U.S.A.