

2010 Motorhomes by Jayco



Jayco

AMERICA'S MOST LIVEABLE RVs.

2010 PRECEPT

Free Spirit



The best



PRECEPT®
2010 Motorhomes by Jayco®



FUEL EFFICIENT

Delivering a best-in-class 16-18 miles per gallon*, the Precept is powered by a Mercedes-Benz® 3.0L V6 CRD turbo diesel engine and a five-speed automatic transmission with overdrive.

* Internal testing subject to independent verification.

LIVEABILITY MEETS INGENUITY

of both worlds.

Boasting a previously unheard of 16-18 miles per gallon rating*, the new Precept is designed for people who are as concerned about fuel economy as they are comfort. And it's raising the bar for Class C motorhomes everywhere, combining excellent fuel efficiency with full-featured luxury. Whether you're navigating crowded city streets or narrow mountain passes, Precept's smaller size and nimble nature make every minute behind the wheel an unforgettable adventure, while its Euro-style interior ensures your passengers will have an equally memorable time.



MANEUVERABLE

Built on a Dodge® Sprinter chassis, and featuring rear stabilizer springs and an adaptive electronic stability program (ESP), Precept's responsive handling separates it from conventional Class C motorhomes.

DURABLE

Precept is built to last with our TuffShell™ vacuum-bonded laminated floor and sidewalls, welded aluminum sidewall framework, and a one-piece fiberglass roof.

A TRADITION OF LIVEABILITY

Starting with our first lifter system for fold-down campers in 1968, which made for an easier, more enjoyable camping experience, Jayco has always been about liveability. Today, we're the world's largest family-owned RV manufacturer, yet our priorities remain the same: making RVs more liveable and family time more memorable.



PRECEPT 24SDS | KHAKI



SIMPLY BETTER.

With Precept, there's no trade-off between fuel efficiency and comfort. In fact, Precept's interior design is every bit as ground breaking as its MPG rating. A 22" LCD HDTV, Provincial Glazed Maple curved cabinetry with curved doors and drawers, decorative nickel hardware, Dream Dinette™, and high-intensity recessed halogen lighting are just a few of the stylish features that make traveling in your new Precept as enjoyable as it is economical.

CONTEMPORARY ROOMY

Precept's kitchen features all the comforts of home, with a three-burner stove, convection microwave, range hood and under-cabinet lighting.

ROOMY

The bedroom has plenty of room for your belongings with overhead storage cabinets and an innovative under-bed storage area.

REFRESH

Clean up in Precept's comfortable bathroom, with retractable shower door, stainless-steel sink and a shower skylight.



PRECEPT 24SDS | KHAKI



PRECEPT 24SDS | KHAKI



PRECEPT 24SDS | KHAKI

Jayco construction

At Jayco, we've built a reputation for superior construction and craftsmanship. We always use top-quality materials and production techniques, giving our products **reliable resale value** and our owners peace of mind.

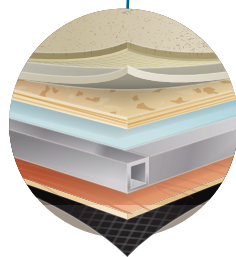

FLOOR

Vacuum bonding joins our welded aluminum frame with a heavy-duty Structurwood® floorboard to create one of the strongest foundations in the industry.

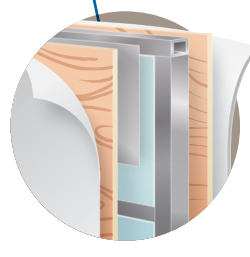

WALLS

TuffShell™ vacuum-bonded lamination combines with welded aluminum frames and metal backers to create a durable structure designed to withstand use and travel.

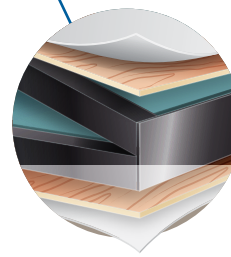

ROOF

The laminated, vacuum-bonded roof is comprised of ¼" plywood decking on 5" arched aluminum trusses with bead-foam insulation (R-23) and a seamless fiberglass shield that protects against moisture and resists aging.

Jayco craftsmanship

Jayco's dedicated production team includes Amish craftsmen who build with well-honed woodworking techniques passed down for generations.



Jayco liveability

DRAWER GUIDES

New ball bearing drawer guides provide smooth operation and full-drawer extension.

STORAGE

Keep bulky gear out of the way in Precept's lockable, lighted exterior storage compartments.

EXTERIOR SPEAKERS

Bring your music and TV outdoors as you entertain with high-output marine-grade exterior speakers.

PATIO AWNING

Extend your living space even farther with our standard Carefree® patio awning.

HIDDEN CABINET DOOR HINGES

Hidden cabinet door hinges add to Precept's Euro-style interior design.

Standards and options

STANDARD BATHROOM EQUIPMENT

ABS shower with one-piece surround
Porcelain stool with foot flush
Radiused interior passage door
Residential medicine cabinet with mirror
Retractable shower door
Robe/towel hooks
Skylight in shower with light
Stainless-steel sink bowl

STANDARD BEDROOM EQUIPMENT

Halogen reading lights
Overhead storage cabinets
Roller shades
Under-bed storage

STANDARD KITCHEN EQUIPMENT

6 cu. ft. refrigerator
Drawer for silverware, divided for utensils
Dream Dinette™ mechanism, raises and lowers dinette table top
High-rise, single-lever faucet with pull-out sprayer
Laminate countertop with round stainless-steel sink
Mini blind
Range hood
Under-counter Apollo® convection microwave with 3-burner top
Water purification system
Wood sink cover

STANDARD CAB EQUIPMENT

3-point lap and shoulder safety belts (driver and passenger)
12V power points (2)
Auxiliary start switch
Cup holders
Document clip
Dome lights
Floor mats
Map pockets
Padded headliner fabric
Power windows and door locks
Privacy drape for lower cab
Remote keyless entry
Sun visors

STANDARD CHASSIS EQUIPMENT

3.92 rear axle ratio
5-speed automatic transmission
16" radial tires
25-gallon fuel tank
180-amp alternator
154 horsepower at 3,400 RPM
280-lb. ft. torque at 1,200-2,400 RPM
3,500-lb. hitch with 7-way plug
4,080-lb. front leaf spring axles
7,200-lb. rear leaf spring axles
A/C and cruise control
Adaptive electronic stability program (ESP)
Dodge® Sprinter chassis
Hellwig® helper springs
Mercedes-Benz® 3.0L V6 CRD turbo diesel engine
Power anti-lock brakes with power steering and skid control
Single 100-amp battery
Tilt and telescoping steering

STANDARD CONSTRUCTION FEATURES

Bead-foam insulation (R-23 max roof, R-9 max floor, R-9 max walls)
Cabinetry crafted with screwed-stile construction
Electric-powered slideouts
High-gloss, gel-coat sidewalls
One-piece fiberglass roof
TuffShell™ vacuum-bonded 5" crowned laminated roof
TuffShell™ vacuum-bonded laminated sidewalls
Welded aluminum sidewall framework

STANDARD EXTERIOR EQUIPMENT

120V G.F.C.I. protected exterior receptacle
Attic fan
Automotive taillights
Carefree® patio awning
Electric single step
Exterior speakers, high-output marine-grade (2)
Fiberglass running boards
Front and rear gel-coat, fiberglass caps
Heated holding tanks, 12V pads
Heavy-duty grab handle for entry assistance
Lockable exterior storage compartments with door pulls

One-piece polyethylene storage compartments
Outdoor media center
Painted skirting
Patio light with inside switch
Radius-cornered entrance door with screen
Rear mud flaps
Side-hinged baggage doors
Slideout topper awnings
Uni-Dock™ utility center, heated and enclosed
Wheel liners

STANDARD INTERIOR EQUIPMENT

22" LCD HDTV
120V outlet and reading lights in cab-over bunk area
Ball bearing drawer guides 100-lb. capacity with full-drawer extension
Cable TV hookup with RG-6 coax
Cab-over bunk ladder
Crank-up digital antenna for TV with signal booster
Curved cabinetry with curved doors and drawers
Deluxe hidden cabinet hinges
Fabric-covered box valances with lambrequin legs
High-intensity halogen recessed 12V lighting package
Padded vinyl ceiling
Padded wings behind cab
Prep for satellite dish for roof and sidewall
Residential linoleum floor throughout

STANDARD HEAT, POWER AND WATER

12V demand water pump
12V electrical system with 120V, 45-amp power converter
30-amp power cord
56-lb. chassis-mounted propane tank
13,500-BTU low-profile A/C
Auto-ignition furnace with wall thermostat
Black holding tank sprayer
Conveniently placed water pump switches
Dual 12V deep-cycle batteries
Hookup for city water
Interior Command Center®
Onan® 3,200-watt Quiet Diesel™ generator with auto-changeover
Water heater bypass system

STANDARD SAFETY EQUIPMENT

Battery disconnect
Deadbolt lock on entrance door
Driver and passenger air bags
Egress window
Fire extinguisher
Lap safety belts in living area
Propane/carbon monoxide alarm
Smoke alarm
Third brake light
Tinted safety-glass windows

OPTIONS

15,000-BTU A/C with heat pump
400-watt inverter
Customer Value Package
Diamond Shield™ paint protection film
Front entertainment center with 32" LCD HDTV
Leather sofa in lieu of dinette
Navigation system
Premium paint package
Privacy night shades in windshield and driver/passenger windows
Satellite kit

CUSTOMER VALUE PACKAGE

6-gal. gas/electric DSI auto-ignition water heater
Bathroom power vent
Deluxe, remote-control, heated, side-view mirrors
Pleated day/night shades in living area
Touch-Screen Premium In-Dash Sound System™ AM/FM/CD/DVD with back-up camera monitor
Upgraded leather driver and passenger seat

Specifications

FLOORPLAN	EXTERIOR LENGTH	EXTERIOR HEIGHT W/AC	INTERIOR HEIGHT	GROSS VEHICLE WEIGHT RATING (LBS.)	GROSS COMBINED WEIGHT RATING (LBS.)	ENGINE/SIZE	WHEEL BASE	FURNACE AUTO-IGNITION (BTUS)	FRESH WATER CAPACITY (GALS.) (INCLUDES WATER HEATER)	GREY WASTE WATER CAPACITY (GALS.)	BLACK WASTE WATER CAPACITY (GALS.)
24DSS	24' 8"	131"	88 1/2"	11,030	14,530	MERCEDES-BENZ 3.0L V6	170 1/2"	25M	37	33	37

Gross Vehicle Weight Rating (GVWR): GVWR means the maximum permissible weight of the motorhome, including the Unloaded Vehicle Weight (UVW) plus passengers, personal items, all cargo, fluids, options and dealer-installed accessories. The GVWR is equal to or greater than the sum of the UVW and the Cargo Carrying Capacity.

Gross Combined Weight Rating (GCWR): The maximum allowable combined weight of the motorhome used as a tow vehicle and the attached towed vehicle.

It is important for your safety and enjoyment that you are aware of the weights and tow ratings of the RV you select. Consult a competent advisor for questions or advice. Whether you are new to RVing or a veteran, get a feel for the performance of your RV before heading out on the roadways. When you tow a vehicle with your RV, you must drive differently than when you drive a single vehicle. Practice hooking up, driving, backing up and braking in a safe environment or seek out professional instruction. Jayco affixes a weight label to each RV which lists weight information for that vehicle. Refer to that label to verify the vehicle will meet your requirements.

Floorplan

◀ = outside storage
 LAV. = bathroom sink
 MICRO. = microwave
 OHC. = overhead cabinets
 REFRIG. = refrigerator
 WARD. = wardrobe

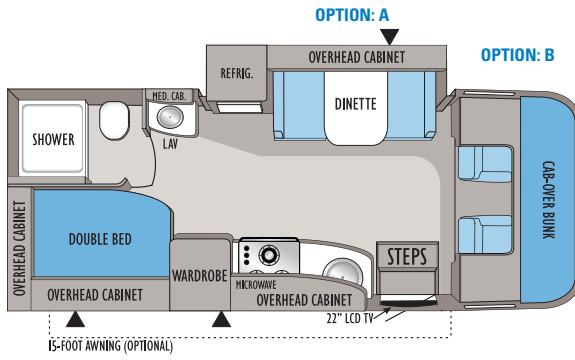

Floorplan options (available on select models only)

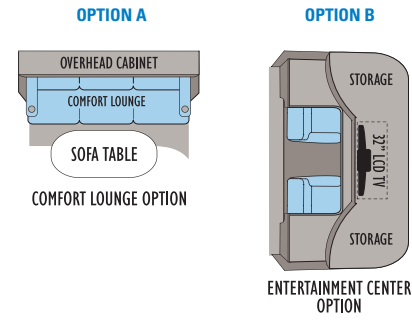

PRECEPT | 24DSS

Ext. Length: 24' 8" Ext. Height: 131"

Interior color options



SABLE

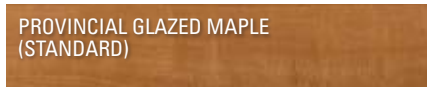

WOOD

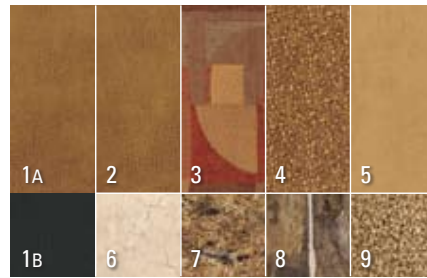

CRIMSON

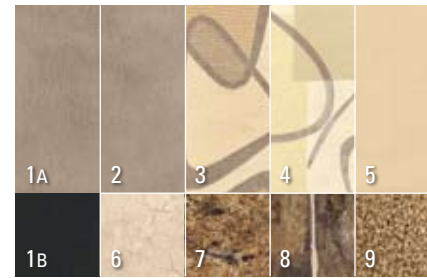

KHAKE

- 1 Driver/passenger chairs (with insert)
- 2 Sofa
- 3 Accent fabric
- 4 Bedroom accent
- 5 Drapery
- 6 Wall panel
- 7 Countertop
- 8 Flooring
- 9 Carpet

Exterior color options



STANDARD PAINT



PREMIUM PAINT



AMERICA'S MOST **LIVEABLE** RVs.

2 YEAR WARRANTY

The Jayco Co-Pilot Warranty is a manufacturer's limited warranty. It comes from the people who build Jayco recreation vehicles to the people who buy them. Each Jayco is warranted to the original purchaser for twenty-four (24) months or twenty-four thousand (24,000) miles (mileage limitation applies to motorized products only), whichever occurs first, from the original date of purchase against defects in materials and workmanship. Jayco's limited warranty is not transferable.

Go ahead and compare the Jayco warranty with other manufacturers' warranties. You'll find it's the best in the business!

For a copy of the limited warranty with full terms and conditions, ask your local Jayco dealer.

Your Jayco Dealer

300 JAYCO DEALERS

Establishing a solid relationship with your local Jayco dealer is a key component in the enjoyment of your new Jayco. By purchasing from a local dealer, you will have a convenient location for sales, parts and service support.

Jayco dealers are required to deliver all products at the site of the sale to provide a full product orientation and walkthrough at the time of delivery. It's a good way to become familiar with your Jayco and to meet the service, parts and warranty staff members who will be assisting you. If you live in Canada, there are regulations that must be met when buying a Jayco RV. Your local Canadian dealer is a professional at meeting these requirements and regulations. There simply is no substitute for a good relationship with your local Jayco dealer.

1 YEAR ROADSIDE ASSISTANCE

Travel worry-free with Jayco's Customer First Roadside Assistance program, yours at no cost during your first year of ownership. This program is offered through Coach-Net®, the largest RV emergency road service in the country, and gives you immediate access to dependable roadside assistance and support services with a simple phone call.

- Free jump starts
- Free tire changes
- Free fuel delivery
- Free lockout service
- Free travelers checks
- Toll-free nationwide service appointment assistance
- 24-hour toll-free emergency message service
- Free custom trip routing and full-color map service
- Free dispatch of on-site mechanical service
- \$2,000 trip-interruption reimbursement
- RV technical assistance hotline
- Free towing to nearest qualified service



Jayco proudly sponsors Tread Lightly!®, a nonprofit organization whose mission is to empower generations to enjoy the outdoors responsibly through education and restoration.



From RV insurance to extended warranties, JayPlus has it covered. Ask your Jayco dealer about our exclusive JayPlus program today.



As a Jayco owner, you can be part of the Jayco Jafari International Travel Club. Ask your dealer about the Jafari "flight" in your area, write Jayco or visit our website.

Jayco, Inc., P.O. Box 460, Middlebury, IN 46540
www.jayco.com 

See dealer for further information and prices. All information in this brochure is the latest available at the time of publication approval. Jayco reserves the right to make changes and to discontinue models without notice or obligation. Photos in this brochure may show optional equipment and props for photography purposes. RVs built for sale in Canada may differ to conform to Canadian codes. ©2010 Jayco, Inc. 10-PCPT-PL 0909-50K Printed in U.S.A.