

LIVE LARGE
TOW SMALL

JAY FEATHER SELECT

2012



JAY FEATHER SELECT® | TRAVEL TRAILERS BY JAYCO®

AMERICA'S MOST LIVEABLE RVs.



JAY FEATHER SELECT 29L | COPPER



JAY FEATHER SELECT 29L | COPPER



JAY FEATHER SELECT 29L | COPPER



SELECT 29L | COPPER

JAY FEATHER SELECT | TRAVEL TRAILERS



COMFORTABLY COMPACT

Live large and tow small with the 2012 Jay Feather Select travel trailer. Hard-wall slideouts ensure you'll have plenty of space to spread out and relax, while an ultra-lite steel frame makes it 10-15% lighter than most conventional trailers, meaning it can be towed by most SUVs, crossovers and minivans.*

STANDARDS AND OPTIONS

STANDARD INTERIOR EQUIPMENT

- 22" LCD HDTV with 180-degree viewing angle
- Ball bearing drawer guides, 50 lb. capacity with full-drawer extension
- Concord Cherry, hardwood cabinet doors
- Diamondflor wall-to-wall vinyl flooring
- High-efficiency Atwood appliance collection (water heater and furnace)
- Large tinted safety-glass windows
- Message Center with hidden switches
- Pleated shades throughout
- Pocket screwed cabinetry
- Residential furniture, cushions and window treatments designed and made by Jayco

STANDARD EXTERIOR EQUIPMENT

- Aerodynamic, rounded front profile
- Electric powered slideouts
- Heavy-duty fiberglass fender skirts with impact-resistant wheel wells
- I-Class cambered structural-steel I-beam frame
- Marine-grade exterior speakers (2)
- MOR/ryde CRE/3000 axle equalizer
- Radiused-cornered, laminated entrance and baggage doors
- TuffShell vacuum-bonded laminated floor, sidewalls, front-end wall and domed roof

OPTIONS

- Aluminum rims
- Customer Value Package
- Customer Value Package with 15,000-BTU A/C
- Electric tongue jack
- Outside grill
- Satellite kit
- Water purification system

CUSTOMER VALUE PACKAGE

- 6-gal. gas/electric DSI water heater
- 13,500-BTU A/C
- ABS propane bottle cover
- ABS tub surround
- Bathroom power vent
- Carefree adjustable pitch electric awning
- Microwave oven
- Multi-Media Premium Sound System
- AM/FM/CD/DVD stereo with iPod hookup
- Outside shower
- Spare tire carrier



FOR A COMPLETE LIST OF
STANDARDS AND OPTIONS, SCAN
HERE WITH YOUR SMARTPHONE
OR VISIT JAYCO.COM.

INTERIOR DÉCOR CHOICES

CHOCOLATE

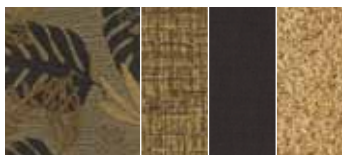

COPPER



WOOD



FLOORPLANS

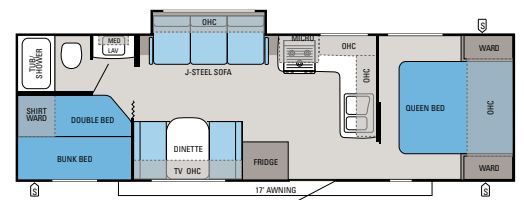

SELECT SERIES | 28R

Ext. Length: 30' 10" Ext. Height: 123" Unloaded Wt. (lbs.): 4,810 Sleeps: 7-9

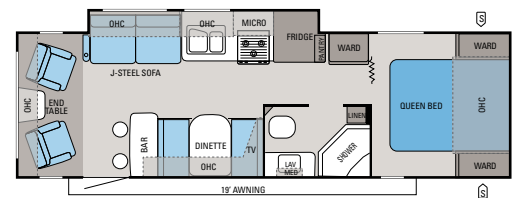

SELECT SERIES | 28U

Ext. Length: 30' 5" Ext. Height: 123" Unloaded Wt. (lbs.): 5,005 Sleeps: 4-6

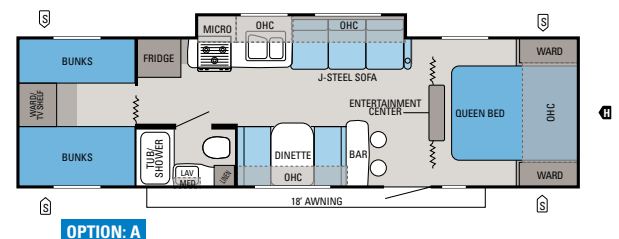

OPTION: A

SELECT SERIES | 29L

Ext. Length: 33' 4" Ext. Height: 123" Unloaded Wt. (lbs.): 5,365 Sleeps: 8-10

OPTION

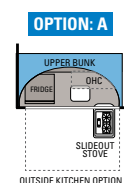

- OUTSIDE STORAGE
- TRAILER HITCH
- BATHROOM SINK
- MICROWAVE
- OVERHEAD CABINETS
- REFRIGERATOR
- WARDROBE

SPECIFICATIONS

FLOORPLAN	EXTERIOR LENGTH	EXTERIOR WIDTH	EXTERIOR HEIGHT (WITH A/C)	INTERIOR HEIGHT	UNLOADED VEHICLE WEIGHT (LBS.)	DRY HITCH WEIGHT (LBS.)	GROSS VEHICLE WEIGHT RATING (LBS.)	CARGO CARRYING CAPACITY (LBS.)	FRESH WATER CAPACITY (GAL.) (WITH WATER HEATER)	GRAY WASTEWATER CAPACITY (GAL.)	TOILET/BLACK WASTEWATER CAPACITY (GAL.)
28R	30' 10"	96"	123"	78"	4,810	665	6,500	1,690	28.5	45	30.5
28U	30' 5"	96"	123"	78"	5,005	780	7,000	1,995	28.5	30.5	30.5
29L	33' 4"	96"	123"	78"	5,365	635	7,500	2,135	28.5	30.5	22.5

A TRADITION OF LIVEABILITY

THE JAYCO STORY BEGAN IN 1968 when Jayco founder Lloyd Bontrager created an innovative, easy-to-use lifter system that led to a better fold-down camper. Loaded with more comforts and conveniences, Lloyd believed his camper would bring people closer together because it was more liveable. A devoted family man, Lloyd's passion extended to his business as well. In fact, our company's success stems from his insistence on treating everyone at Jayco as family — from our factory to our front office, our salespeople to our suppliers, and our customers to our community.

BLENDING OLD WORLD AMISH CRAFTSMANSHIP WITH INNOVATIVE TECHNOLOGY, Jayco is the nation's largest family-owned and operated RV manufacturer today. And while our product line has grown considerably over the years, every unit we build is still guided by Lloyd's vision and a humble desire to help make it easier for families to explore together and relax together. It's what separates us from other RV manufacturers. And it's what continues to make Jayco America's Most Liveable RVs.



AMERICA'S MOST **LIVEABLE** RVs.



Jayco proudly sponsors Tread Lightly!, a nonprofit organization whose mission is to empower generations to enjoy the outdoors responsibly through education and restoration.

Unloaded Vehicle Weight (UVW): Sometimes referred to as "Dry Weight," UVW means the typical weight of this trailer as built at the factory. The UVW, as used in product literature and other promotional materials, does not include cargo, fresh water, propane, options or dealer-installed accessories.

Gross Vehicle Weight Rating (GVWR): GVWR means the maximum permissible weight of the trailer, including the UVW plus passengers, personal items, all cargo, fluids, options, and dealer-installed accessories. The GVWR is equal to or greater than the sum of the UVW and the CCC.



From RV insurance to extended warranties, JayPlus has it covered. Ask your Jayco dealer about our exclusive JayPlus program today.

Cargo Carrying Capacity (CCC): CCC means the maximum weight of all passengers, personal items, food, fresh water, propane, tools, other cargo and dealer-installed accessories that can be carried by the trailer. CCC is equal to or less than GVWR minus UVW. The addition of options will decrease the CCC.

Hitch Weight (HW): The hitch weight, as used in product literature and other promotional materials, does not include cargo, fresh water, propane gas, options or dealer-installed accessories. The addition of these types of items will either add to or subtract from the stated hitch weight.



As a Jayco owner, you can be part of the Jayco Jafari International Travel Club. Ask your dealer about the Jafari "flight" in your area, write Jayco or visit our website.

It is important for your safety and enjoyment that your tow vehicle be adequately sized and equipped to tow and handle the GVWR of the RV you select. Review weights and rating of your tow vehicle and consult a competent advisor for questions or advice. Whether you are new to RVing or a veteran, get a feel for the performance of your tow vehicle before heading out on the roadways. When you tow an RV, you must drive differently than when you drive a single vehicle. Practice hooking up, driving, backing up and braking in a safe environment or seek out professional instruction. Jayco affixes a weight label to each RV which lists weight information for that vehicle. See specifications chart inside.

Jayco, Inc., P.O. Box 460, Middlebury, IN 46540, www.jayco.com

See dealer for further information and prices. All information in this brochure is the latest available at the time of publication approval. Jayco reserves the right to make changes and to discontinue models without notice or obligation. Photos in this brochure may show optional equipment and props for photography purposes. RVs built for sale in Canada may differ to conform to Canadian codes. ©2011 Jayco, Inc. 12-JFSL-PL 0911-20K Printed in U.S.A.