

SEISMIC TOY HAULERS BY JAYCO

seismic



Quality

built for

YOUR ADVENTURE



Jayco®

MIDDLEBURY, IN

PAINT PACKAGES



PARTIAL PAINT



HORIZON



STORM



DESERT

reinvent ...

- ✓ YOUR TOYBOX
- ✓ YOUR GARAGE
- ✓ YOUR BEDROOM
- ✓ YOUR HOBBY
- ✓ YOUR PATIO



YOU WANT PEACE OF MIND

That's why we offer our exclusive 2-year Co-Pilot Warranty, the industry's best and most comprehensive warranty program.



SEISMIC® TOY HAULERS BY JAYCO®

REINVENT YOUR SPACE

Toy haulers, you've seen them. Property of the extreme enthusiast. But who says you have to be extreme to play with the best toys? Get ready for the Jayco Seismic — the toy hauler that redefines the category — and the people who own it. Boasting an ambitious list of extraordinary features, including four optional paint schemes, the Jayco Seismic is designed for more than just the typical off-roading enthusiast. It's designed for you, packed with everything you would expect in a traditional fifth wheel, but in a design that transforms the toy hauler landscape.



WITH YOUR PURCHASE

Every Jayco RV undergoes rigorous quality control testing before it leaves the factory, so you can be confident your new Jayco will continue to provide the ultimate in reliability for years to come.

For a copy of our 2-year limited warranty with full terms and conditions, ask your local Jayco dealer.



TO LEARN MORE ABOUT
OUR QUALITY CONTROL
TESTING, SCAN HERE WITH
YOUR SMARTPHONE.



SEISMIC 3210 | CANYON



SEISMIC TOY HAULERS

CONTEMPORARY COMFORTS

Extra tall slideouts, curved walls and extendable dinettes give you the room you need, while a full-featured kitchen, boasting Glazed Maple cabinetry, high-gloss, solid-surface countertops and 8 cu. ft. double-door refrigerator, equip you with every kitchen comfort.



CARGO SCREEN



FUEL STATION

exterior details



SEISMIC 3914 | STONE



SEISMIC 3914 | STONE

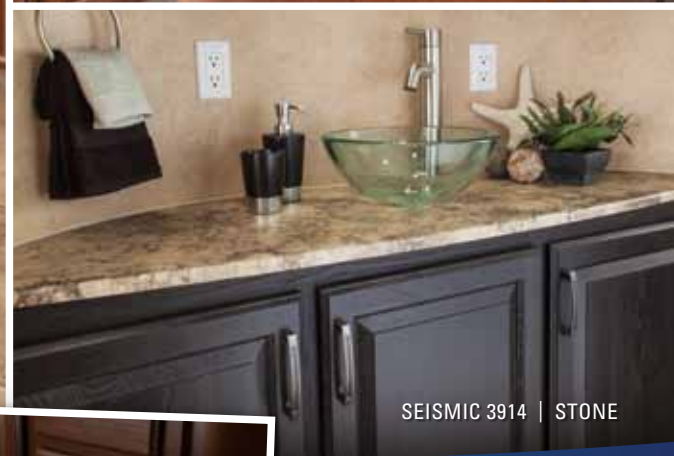

SEISMIC 3914 | STONE

interior details



U-DINETTE WITH EXTENDABLE SEATING



SILENT GLIDE DAY/NIGHT SHADES



TOE-KICK CABINET LIGHTING

jayco CONSTRUCTION

At Jayco, we've built a reputation for superior construction and quality craftsmanship. We pride ourselves on always using top-quality materials and innovative manufacturing techniques. That commitment has led to our latest construction advancement, the all-new exclusive Magnum Roof System, 50 percent stronger than other roofs in the industry, built to outlast everything but your memories.



OUR NEW ROOF FEATURES ...

- 1 4 1/2" crowned wood trusses: Uses 2"x 2" vertical studs to maximize load capacity, while oversized nail plates provide a tighter design
- 2 3/8" roof decking, screwed down at every seam: More durable than typical stapled construction, provides fully walkable roof
- 3 Residential attic-style insulation: Maintains interior temperatures while allowing for room to run wiring, reducing risky electrical shorts
- 4 One-piece, sidewall-wrapped Alpha Ply material: Provides leak protection



INTERIOR DÉCOR CHOICES

ECLIPSE

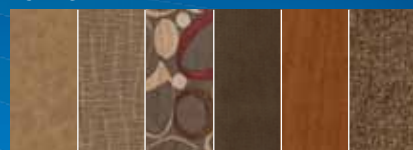

STONE

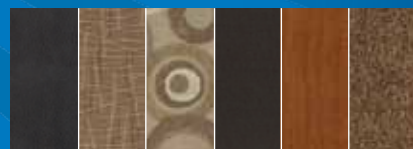

CANYON



PRALINE

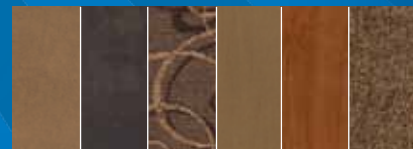

WALL CONSTRUCTION

- 5 Vacuum-bonded layers: Involves 15-18 minutes of 144 tons of pressure to ensure a stronger bond
- 6 Smooth high-gloss fiberglass exterior: Withstands travel—and Mother Nature, too
- 7 Welded aluminum frames with metal backers: Creates long-lasting durability
- 8 Innovative contoured front cap: Protects unit's most vulnerable areas, while making Seismic more aerodynamic

FLOOR CONSTRUCTION

- 9 5/8" tongue-and-groove plywood deck on 2" x 3" aluminum floor joists: More moisture resistant, plywood holds up to the elements
- 10 Floor radiant foil and residential insulation: Keeps heat in and cold out with an impressive R-25 insulation value
- 11 Poly Flex covering and an enclosed, heated underbelly: Increases aerodynamics while protecting the undertanks



eco advantage™ www.jayco.com/ecoadvantage

THE JAYCO ECOADVANTAGE IS OUR COMPANY'S COMMITMENT TO PROTECTING THE ENVIRONMENT. Scan this QR code with your smartphone to watch a video about our efforts and the impact we're having on our world.

SPECIFICATIONS

FLOORPLAN	EXT. LGTH.	EXT. WIDTH.	EXT. HT. WITH A/C	EXT. HT. WITH OPT. BEDROOM A/C	INT. HT.	UNLOADED VEHICLE WT. (LBS.)	DRY HITCH WT. (LBS.)	GROSS VEHICLE WT. RATING (LBS.)	CARGO CARRYING CAPACITY (LBS.)	FRESH WATER CAPACITY (GAL.) (WITH WATER HEATER)	GRAY WASTEWATER CAPACITY (GAL.)	TOILET/BLACK WASTEWATER CAPACITY (GAL.)
3210	37'	102"	161"	161"	103"	11,990	2,795	16,500	4,510	148	87	50
3712	42' 4"	102"	159"	159"	103"	13,835	2,950	19,000	5,165	148	122.5	85.5
3812	43' 2"	102"	159"	159"	103"	15,405	3,520	19,000	3,595	148	122.5	82.6
3902	TBD	102"	TBD	TBD	103"	TBD	TBD	TBD	TBD	148	87	50
3912	44' 2"	102"	159"	159"	103"	14,160	3,245	19,000	4,840	148	122.5	82.6
3914	44' 2"	102"	159"	159"	103"	14,405	3,340	19,000	4,595	148	87	50

The weights of certain options and/or option packages are not included in the UVW listed above.

full-profile FLOORPLANS

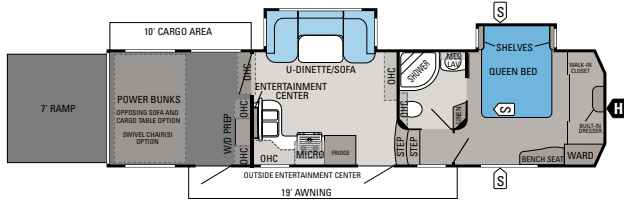

SEISMIC FULL-PROFILE | 3210

Ext. Lgth: 37' Ext. Ht: 161" Unloaded Wt (lbs.): 11,990 Sleeps: 7-8

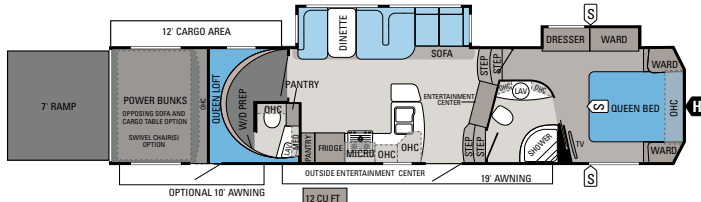

SEISMIC FULL-PROFILE | 3712

Ext. Lgth: 42' 4" Ext. Ht: 159" Unloaded Wt (lbs.): 13,835 Sleeps: 9-11

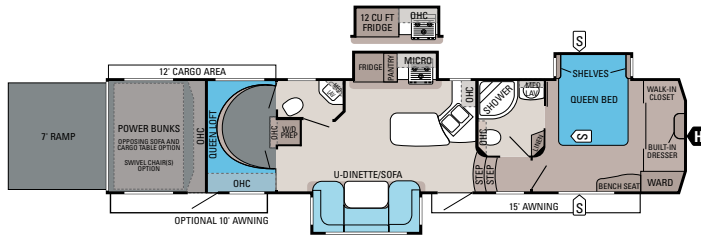

SEISMIC FULL-PROFILE | 3812

Ext. Lgth: 43' 2" Ext. Ht: 159" Unloaded Wt (lbs.): 15,405 Sleeps: 8-10

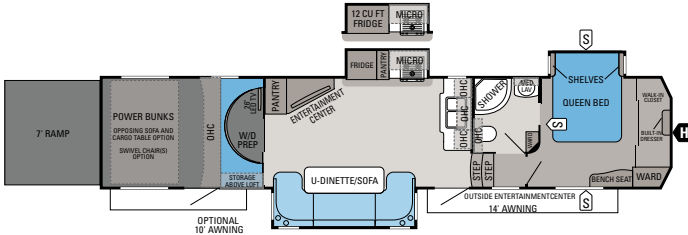

SEISMIC FULL-PROFILE | 3902

Ext. Lgth: TBD Ext. Ht: TBD Unloaded Wt (lbs.): TBD Sleeps: 7-8

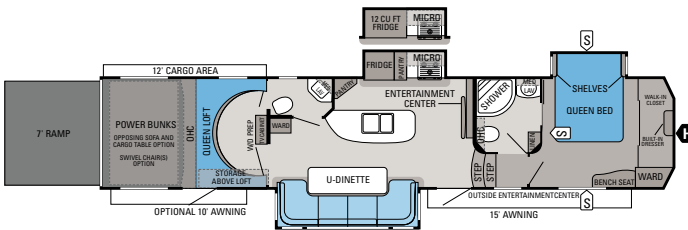

SEISMIC FULL-PROFILE | 3912

Ext. Lgth: 44' 2" Ext. Ht: 159" Unloaded Wt (lbs.): 14,160 Sleeps: 8-10

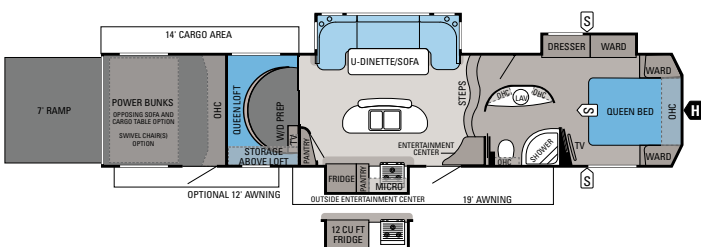

SEISMIC FULL-PROFILE | 3914

Ext. Lgth: 44' 2" Ext. Ht: 159" Unloaded Wt (lbs.): 14,405 Sleeps: 8-10

STANDARDS & OPTIONS

STANDARD EXTERIOR EQUIPMENT

High-gloss fiberglass sidewalls
3/8" wood roof decking on 5" crowned wood truss rafters (R-30)
5/8" tongue-and-groove plywood main floor decking
12" I-Class cambered structural-steel I-beam frame
Heat reflective foil insulation in living area, bedroom, slideout floors
One-piece seamless roof membrane
16" radial tires and spare tire with carrier
8-lug polished aluminum wheels
E-Z Lube axles
MOR/ryde CRE 3000 rubber axle equalizer
Dexter Nev-R-Adjust brakes
Pin box, long
30" x 72" radius-cornered entrance door with step light, oversized window and Epad touch-pad gas-strut door locks
Marine-grade exterior speakers (2)
12V electric patio awning
Hand-held remote for awning, slideouts, jacks and patio lights with remote located in Command Center
Stor-Galore basement storage
Slam-latch lockable baggage doors, insulated and radius-cornered
Integrated LED front cap docking light
Electric-powered front jacks
Uni-Dock utility center, heated and enclosed
5,500-watt generator with auto-changeover switch
Double 30-lb. propane bottles with regulator with additional (1) 30-lb. tank storage
Battery compartment and disconnect switch for two batteries
30-gal. fuel station, dual, with command center gauge
12-gal. gas/electric DSI water heater with auto-ignition
148-gal. fresh water capacity
Black holding tank sprayer and sewer hose compartment
Water system winterization kit
Outside shower
Electric-powered rear stabilizer jacks (2)
Black folding roof ladder
Security lights (2)
LED taillights

STANDARD INTERIOR EQUIPMENT

Residential-style pre-drilled and screwed cabinet construction with hidden hinges
Ball bearing drawer guides, 100-lb. capacity with full-drawer extension
Below-countertop trash receptacle
Deep storage drawers under booth dinette
High-gloss, solid-surface countertops with undermount stainless-steel sink with sink covers (2)
Brushed nickel faucet with pull-out sprayer
3-burner range with 9,000-BTU SuperBurner, piezo igniter and bi-fold metal cover
Mirror feature behind stove
8 cu. ft. flush-mount, double-door refrigerator with high-gloss black inserts
24" microwave oven with carousel
Oversized 21" oven
Water heater bypass system
Water purification system
40,000-BTU furnace, auto-ignition and black digital thermostat
Island/bar area long-stem pendant lights (select models)
Toe-kick kitchen accent lighting

Halogen recessed lighting package
15,000-BTU A/C with Whisper quiet feature and multi-directional, louvered-directional ceiling vents
40" LCD HDTV in living area with dual cable and satellite prep
Samsung 1,000-watt home theatre system
Hide-a-bed sofa with air mattress (select models)
Thermofoil countertops and clear bathroom vessel sink with high-rise nickel faucet
Power bathroom vent with large blades
Radius shower with colored ABS surround and skylight
Flat-panel door with decorative glass insert
Ceiling crown molding in bedroom with LED vibe lighting
60" x 80" deluxe mattress, 312-coil with 2" top-side pad and gas-strut, under-bed storage
Walk-in closet
Bedroom cabinet with 22" LCD HDTV, DVD, satellite, cable jacks
Bedroom wired and framed for second A/C

STANDARD RAMP & CARGO EQUIPMENT

Vacuum-bonded laminated 2" garage floor
7' 10" hinged spring-assist ramp door, 3,000-lb. capacity, 93 3/8" wide opening with anti-slip, non-skid flooring
18"-wide tread plate splash guard
Tuff-ply, rubberized garage floor liner
Welded-steel storage in garage floor/full-width beaver tail
Flush floor-mounted tie-down rings anchored to frame, 2,500-lb. capacity each
30" x 72" cargo bay door with LED step light
Premium coach/cargo passage door with window (select models)
Closeable and directional air conditioning ducts
High-intensity, flush-mounted ramp lights (2)
HappiJac electric bed lift
Black retractable screen wall/cargo bay privacy curtain
Patio door with screen (3914)
3 cu. ft. refrigerator (select models)
Washer/dryer prep, located in cargo area
Cargo area vent ports and powered roof vent

OPTIONS

Customer Value Package
Customer Value Package with 15,000-BTU A/C with heat pump
Partial Paint Package
Premium Paint Package
Thermal pane safety-glass windows
MOR/ryde pin box
6-point automatic electric leveling system
Additional electric patio awning
Party Deck with folding rails and awning
Roll-up carpet in cargo area
Slideout awnings
12 cu. ft. flush-mount, double-door refrigerator with high-gloss black inserts (n/a 3210)
24" convection microwave
High-top table and bar stools
26" exterior LCD HDTV
Dyson vacuum
Satellite kit
Sirius satellite radio package
Fireplace (3902)
Swivel/reclining chair(s)
Dual opposing electric sofas
26" LCD HDTV in cargo area
15,000-BTU 2nd bedroom A/C with black thermostat



THE **Jayco**[®] family STORY

THE JAYCO STORY BEGAN IN 1968 WITH OUR FAMILY—THE BONTRAGERS. Lloyd Bontrager created an innovative, easy-to-use lifter system that led to a better fold-down camper. Loaded with more conveniences, he believed his camper would bring families closer together.

Since then, the Jayco family has grown. From our factory to our front office, from our salespeople to our suppliers, our family bond is four decades strong with the support of more than 300 Jayco dealers.

Together, we're helping make new family stories. **YOUR FAMILY STORY.**

welcome to the Jayco family



Establishing a solid relationship with your local Jayco dealer is a key component in the enjoyment of your new Jayco. By purchasing from a local dealer, you will have a convenient location for sales, parts and service support. We hope you enjoy working with them as much as we do.



Jayco proudly sponsors Tread Lightly!, a nonprofit organization whose mission is to empower generations to enjoy the outdoors responsibly through education and restoration.

Unloaded Vehicle Weight (UVW): Sometimes referred to as "Dry Weight," UVW means the typical weight of this trailer as built at the factory. The UVW, as used in product literature and other promotional materials, does not include cargo, fresh water, propane, options or dealer-installed accessories.

Gross Vehicle Weight Rating (GVWR): GVWR means the maximum permissible weight of the trailer, including the UVW plus passengers, personal items, all cargo, fluids, options, and dealer-installed accessories. The GVWR is equal to or greater than the sum of the UVW and the CCC.



From RV insurance to extended warranties, JayPlus has it covered. Ask your Jayco dealer about our exclusive JayPlus program today.

Cargo Carrying Capacity (CCC): CCC means the maximum weight of all passengers, personal items, food, fresh water, propane, tools, other cargo and dealer-installed accessories that can be carried by the trailer. CCC is equal to or less than GVWR minus UVW. The addition of options will decrease the CCC.

Hitch Weight (HW): The hitch weight, as used in product literature and other promotional materials, does not include cargo, fresh water, propane gas, options or dealer-installed accessories. The addition of these types of items will either add to or subtract from the stated hitch weight.



Travel worry-free with Jayco's Customer First Roadside Assistance program, yours at no cost during your first year of ownership. This program is offered through Coach-Net, the largest RV emergency road service in the country, and gives you immediate access to dependable roadside assistance and support services with a simple phone call.



As a Jayco owner, you can be part of the Jayco Jafari International Travel Club. Ask your dealer about the Jafari "flight" in your area, write Jayco or visit our website.

It is important for your safety and enjoyment that your tow vehicle be adequately sized and equipped to tow and handle the GVWR of the RV you select. Review weights and rating of your tow vehicle and consult a competent advisor for questions or advice. Whether you are new to RVing or a veteran, get a feel for the performance of your tow vehicle before heading out on the roadways. When you tow an RV, you must drive differently than when you drive a single vehicle. Practice hooking up, driving, backing up and braking in a safe environment or seek out professional instruction. Jayco affixes a weight label to each RV which lists weight information for that vehicle. See specifications chart inside.

Jayco, Inc., P.O. Box 460, Middlebury, IN 46540, www.jayco.com

See dealer for further information and prices. All information in this brochure is the latest available at the time of publication approval. Jayco reserves the right to make changes and to discontinue models without notice or obligation. Photos in this brochure may show optional equipment and props for photography purposes. RVs built for sale in Canada may differ to conform to Canadian codes. ©2012 Jayco, Inc. 13-SEIS-PL 0113-20K Printed in U.S.A.