

JAY FLIGHT
Swift

on-the-go fun

FEATURE FILLED. AFFORDABLY PRICED.



THE PERFECT SIZE



SAY HELLO TO THE JAY FLIGHT SWIFT SLX — MADE FOR MINIVANS, CROSSOVERS AND FAMILIES

Weighing in under 2,740 pounds, Swift SLX takes everything America loves about the Jay Flight and packages it in a lightweight design, towable by most minivans and crossovers.*

GOT *what it takes*
**TO TOW A JAY FLIGHT
SWIFT SLX?**

A FEW OF THE MANY VEHICLES UP TO THE
JAY FLIGHT SWIFT SLX CHALLENGE.

* Can tow all Swift SLX models. Consult with your authorized automobile manufacturer or vehicle owner's manual; some models require a tow package.



MINIVANS*

- Honda Odyssey 3.5L V-6
- Toyota Sienna 3.5L V-6
- Nissan Quest 3.5L V-6
- Kia Sedona 3.8L V-6
- Dodge Grand Caravan 3.6L V-6
- Chrysler Town & Country 3.6L V-6



CROSSOVERS*

- Suzuki Grand Vitara 2.4L I-4
- Ford Escape 3.0L V-6
- Chevrolet Equinox 3.0L V-6
- GMC Terrain 3.0L V-6
- Mitsubishi Outlander FWD 3.0L V-6
- Toyota RAV4 3.5L V-6
- Kia Sorento 3.5L V-6
- Hyundai Santa Fe 3.5L V-6
- Jeep Wrangler Unlimited 3.6L V-6



YOU WANT PEACE OF MIND

That's why we offer our exclusive 2-year Co-Pilot Warranty, the industry's best and most comprehensive warranty program.

THE PERFECT PRICE



MEET THE JAY FLIGHT SWIFT — MADE FOR COMFORT AND VALUE AT AN AFFORDABLE PRICE

Big on features your family will love—at a price your family can afford—Jay Flight Swift continues Jayco's long tradition of putting family first.

affordable COMFORT IN THE JAY FLIGHT SWIFT



AMPLE STORAGE

You'll never run out of storage in a Jay Flight Swift, thanks to stunning Amish-crafted hardwood cabinetry.



MULTI-MEDIA SYSTEM

In tune with your family, Swift is equipped with a Multi-Media Premium Sound System with AM/FM/CD stereo.



6.3 CU. FT. REFRIGERATOR

Swift's Convenience Package features a 6.3 cu. ft. fridge with double doors.

WITH YOUR PURCHASE

Every Jayco RV undergoes rigorous quality control testing before it leaves the factory, so you can be confident your new Jayco will continue to provide the ultimate in reliability for years to come.

For a copy of our 2-year limited warranty with full terms and conditions, ask your local Jayco dealer.



TO LEARN MORE ABOUT OUR QUALITY CONTROL TESTING, SCAN HERE WITH YOUR SMARTPHONE.



JAY FLIGHT SWIFT SLX



feature packed

Don't let its light weight fool you. Jay Flight Swift SLX may be nimble in nature, but it's certainly not light on amenities. With a 2-burner range, 3 cu. ft. refrigerator and microwave oven, Swift SLX packs a full-featured kitchen in a towable design.*

* Consult with your authorized automobile manufacturer or vehicle owner's manual.



JAY FLIGHT SWIFT SLX 165RB



JAY FLIGHT SWIFT SLX 165RB



JAY FLIGHT SWIFT SLX 165RB

AMPLE STORAGE

Spacious wardrobes, stunning Amish-crafted hardwood cabinetry and well-designed floorplans maximize storage space.

EXPANDABLE SLEEPING

Sleep the whole family thanks to convertible dinettes, select model bunk beds or Swift SLX's 165RB expandable bunk end. Featuring DuraTek water-repellent tent material, 5" bed mats and reversed cambered support rated for 1,100 pounds, the 165RB is our most spacious SLX floorplan yet.



JAY FLIGHT SWIFT SLX 165RB



JAY FLIGHT SWIFT

affordable amenities

Swift continues Jay Flight's long tradition of putting family first thanks to space-saving floorplans, a long list of standard amenities and a super affordable price. Our stunning Amish-crafted hardwood cabinetry and Jayco-made furniture are proof you won't have to sacrifice quality or comfort when you go camping.





JAY FLIGHT SWIFT 267BHS

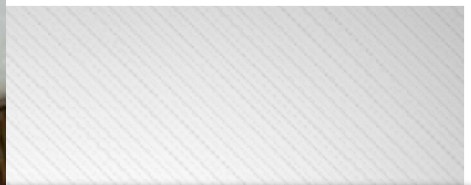

JAY FLIGHT SWIFT 267BHS



JAY FLIGHT SWIFT 267BHS



JAY FLIGHT SWIFT 267BHS

WELL EQUIPPED

Enjoy simple comforts, like the energy-efficient Atwood appliance collection, standard air conditioning and Multi-Media Premium Sound System with AM/FM/CD stereo.

ROOM TO REST

With three floorplans, there's a sleeping arrangement for you, thanks to a private bedroom, bunk beds, convertible table and sleeper J-Steel sofa.

REFRESHING AMENITIES

Wash up in the Swift's bathroom, complete with marine toilet, tub/shower combo and skylight.

JAY FLIGHT SWIFT SLX FLOORPLANS

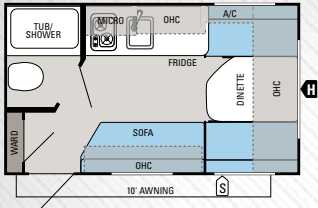

JAY FLIGHT SWIFT SLX | 145RB

Ext. Lgth: 16' 6" Ext. Ht: 99" Unloaded Wt (lbs.): 2,285 Sleeps: 2-3

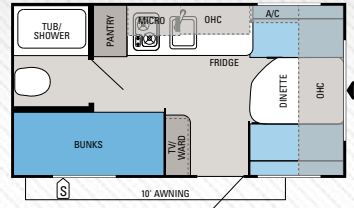

JAY FLIGHT SWIFT SLX | 154BH

Ext. Lgth: 17' 10" Ext. Ht: 99" Unloaded Wt (lbs.): 2,450 Sleeps: 3-4

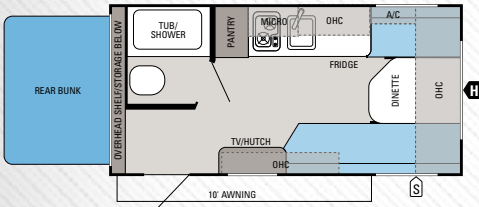

JAY FLIGHT SWIFT SLX | 165RB

Ext. Lgth: 18' 10" Ext. Ht: 101" Unloaded Wt (lbs.): 2,645 Sleeps: 3-4

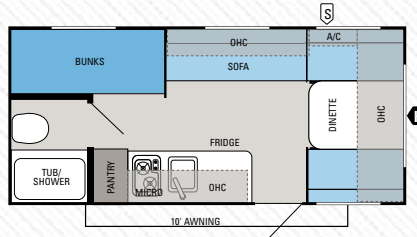

JAY FLIGHT SWIFT SLX | 184BH

Ext. Lgth: 20' Ext. Ht: 101" Unloaded Wt (lbs.): 2,690 Sleeps: 4-5

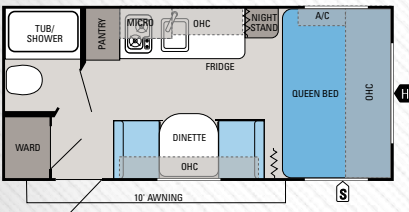

JAY FLIGHT SWIFT SLX | 185RB

Ext. Lgth: 20' Ext. Ht: 101" Unloaded Wt (lbs.): 2,740 Sleeps: 3

FLOORPLAN KEY

	OUTSIDE STORAGE		MICROWAVE
	TRAILER HITCH		OVERHEAD CABINETS
	BATHROOM SINK		REFRIGERATOR
			WARDROBE

STANDARDS AND OPTIONS

STANDARD EXTERIOR EQUIPMENT

8 1/2" exterior height
.024 mesa crimp exterior aluminum
4" cambered steel box tube frame
5/8" seamless floor decking
One-piece, seamless Alpha ply roof material
Patio awning
Amber patio light
Clamp ring, safety-glass windows with automotive gasket seals
Radial tires
Galvanized-steel, impact-resistant wheel wells
Radius-cornered entrance and baggage doors
Double-wide corner mold extrusions
Fully integrated A-frame
Aerodynamic front profile

Front diamond plate
Front window with integrated rock guard
DuraTek water-repellent, scratch-resistant, vinyl tent material with zipper windows (165RB)
Powder coated shepherd's hook tent framing (165RB)
30-amp service
Single 20-lb. propane bottle

STANDARD INTERIOR EQUIPMENT

Screwed-and-glued Glazed Concord
Cherry cabinetry
Wardrobe/pantry storage
Ball bearing drawer guides throughout, 75-lb. capacity with full extension

Laminate countertops with T-mold edging
Acrylic sink
2-burner range with range hood/exhaust fan
3 cu. ft. Norcold refrigerator
Microwave oven
6 gal. gas Atwood water heater
Wall-mount A/C
High-efficiency Atwood furnace
Multi-Media Premium Sound System with MP3/iPod input jacks
Jayco-made dinette cushions and window treatments
Indoor/outdoor dinette table
Plywood bunk, dinette and bunk platforms
Pleated shades throughout

Vinyl flooring
Marine toilet with hand flush
Shower curtain with curved shower rack (select models)
Wood trimmed mirror in bathroom
300-lb. rated bunk beds (select models)
4" bunk mats (select models)
5" high density foam tent mat (165RB)
Under-bed storage on main beds

SPECIFICATIONS

FLOORPLAN	EXTERIOR LENGTH	EXTERIOR WIDTH	EXTERIOR HEIGHT (WITH A/C)	INTERIOR HEIGHT	UNLOADED VEHICLE WEIGHT (LBS.)	DRY HITCH WEIGHT (LBS.)	GROSS VEHICLE WEIGHT RATING (LBS.)	CARGO CARRYING CAPACITY (LBS.)	FRESH WATER CAPACITY (GAL.) (WITH WATER HEATER)	GRAY WASTEWATER CAPACITY (GAL.)	TOILET/BLACK WASTEWATER CAPACITY (GAL.)
145RB	16' 6"	85"	99"	73"	2,285	235	2,950	665	16	15	9
154BH	17' 10"	85"	99"	73"	2,450	260	3,200	750	16	15	9
165RB	18' 10"	85"	101"	73"	2,645	230	3,500	855	16	15	9
184BH	20'	85"	101"	73"	2,690	305	3,500	810	26	15	9
185RB	20'	85"	101"	73"	2,740	310	3,500	760	26	15	9

JAY FLIGHT SWIFT FLOORPLANS

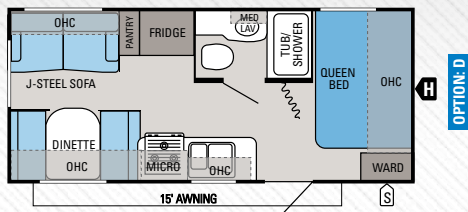

JAY FLIGHT SWIFT | 198RD

Ext. Lgth: 23' 1" Ext. Ht: 128" Unloaded Wt (lbs.): 3,720 Sleeps: 4-7

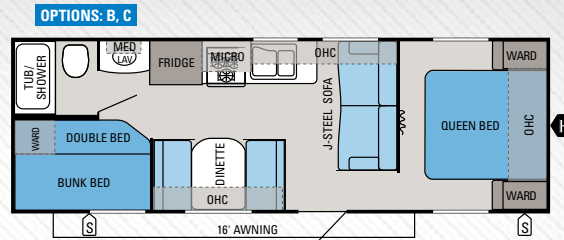

JAY FLIGHT SWIFT | 264BH

Ext. Lgth: 29' 1" Ext. Ht: 128" Unloaded Wt. (lbs.): 4,325 Sleeps: 7-9

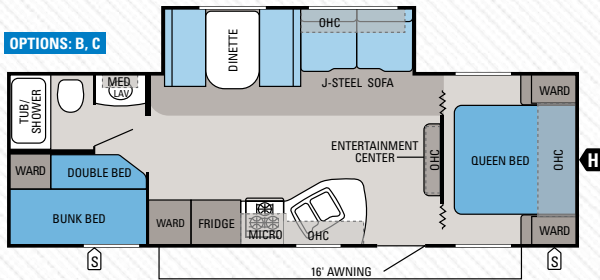

JAY FLIGHT SWIFT | 267BHS

Ext. Lgth: 29' 11" Ext. Ht: 133" Unloaded Wt. (lbs.): 5,315 Sleeps: 7-10

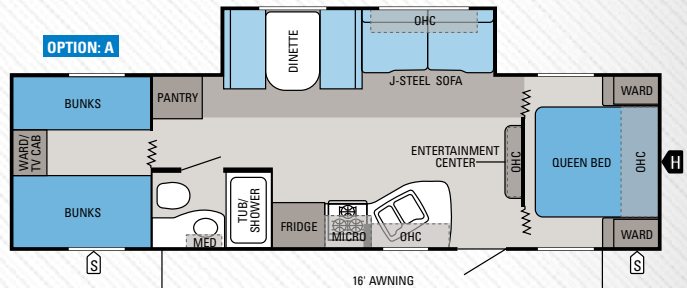

JAY FLIGHT SWIFT | 294BHS

Ext. Lgth: 33' 3" Ext. Ht: 134" Unloaded Wt. (lbs.): 5,805 Sleeps: 7-9

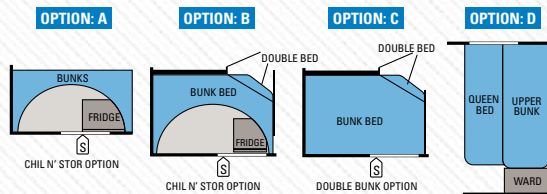

STANDARDS AND OPTIONS

STANDARD EXTERIOR EQUIPMENT

- .024 mesa crimp exterior aluminum
- I-Class cambered structural steel I-beam frame
- 5/8" tongue and groove plywood flooring
- Magnum roof system
- One-piece, seamless Alpha ply roof material
- Patio awning
- Radius-cornered entrance door with window
- Amber patio light
- Clamp ring, safety-glass windows with automotive gasket seals
- Radial tires
- Galvanized-steel, impact-resistant wheel wells
- E-Z Lube axles
- Radius-cornered baggage doors
- Double-wide corner mold extrusions
- Fully integrated A-frame
- Aerodynamic front profile
- Electric powered slideouts (267BHS, 294BHS)
- 30-amp service
- Dual 20-lb. propane bottles
- Stabilizer jacks with sand pads (267BHS, 294BHS)

STANDARD INTERIOR EQUIPMENT

- Screwed-and-glued Glazed Concord Cherry cabinetry
- Large overhead cabinetry
- Removable shelves in pantry/wardrobe (select models)
- Ball bearing drawer guides throughout, 75-lb. capacity with full extension
- Laminate countertops with T-mold edging
- Deep-bowl, 60/40 acrylic kitchen sink with high-rise faucet
- Metal alloy faucet fittings
- 3-burner range with 9,000-BTU SuperBurner with range hood and exhaust fan
- 5 cu. ft. Norcold refrigerator with external temperature controls
- 6 gal. gas Atwood water heater
- High-efficiency Atwood furnace
- Multi-Media Premium Sound System with MP3/iPod input jacks
- Jayco-made dinette cushions and window treatments
- Plywood bunk, dinette and bunk platforms
- Pleated shades throughout
- Vinyl flooring

- J-Steel jack-knife sofa (select models)
- Marine toilet with hand flush
- Power bath fan
- Shower curtain with curved shower rack (select models)
- Wood trimmed mirror in bathrooms
- 300-lb. rated bunk beds (select models)
- 4" quilted bunk mats (select models)
- Shirt wardrobes in bedrooms
- Under-bed storage on main beds

CUSTOMER VALUE PACKAGE

- 13,500-BTU A/C
- Cable/satellite TV hookup
- Digital TV antenna
- Water heater bypass
- Microwave
- Bedspread

CONVENIENCE PACKAGE

- Outside shower
- 4 stabilizer jacks (standard 267BHS, 294BHS)
- 6.3 cu. ft. Norcold double-door refrigerator
- Oven
- 6 gal. gas/electric DSI Atwood water heater
- ABS tub surround

OPTIONS

- Power Package: Adjustable power awning and power tongue jacks
- Spare tire with carrier
- Chil N' Stor outside baggage compartment with 1.7 cu. ft. refrigerator (select models)
- Convenience Package (select models)
- Customer Value Package with 15,000-BTU A/C
- Entertainment Package: DVD with iPod and exterior speakers
- Double bunk over double bed (264BH, 267BHS)
- Queen bed with bunk (198RD)



FOR A COMPLETE LIST OF STANDARDS AND OPTIONS, SCAN HERE WITH YOUR SMARTPHONE OR VISIT JAYCO.COM.

SPECIFICATIONS

FLOORPLAN	EXTERIOR LENGTH	EXTERIOR WIDTH	EXTERIOR HEIGHT (WITH A/C)	INTERIOR HEIGHT	UNLOADED VEHICLE WEIGHT (LBS.)	DRY HITCH WEIGHT (LBS.)	GROSS VEHICLE WEIGHT RATING (LBS.)	CARGO CARRYING CAPACITY (LBS.)	FRESH WATER CAPACITY (GAL.) (WITH WATER HEATER)	GRAY WASTEWATER CAPACITY (GAL.)	TOILET/BLACK WASTEWATER CAPACITY (GAL.)
198RD	23' 1"	96"	128"	81"	3,720	480	5,900	2,180	48.2	32.5	32.5
264BH	29' 1"	96"	128"	81"	4,325	500	6,500	2,175	48.2	32.5	32.5
267BHS	29' 11"	96"	133"	81"	5,315	675	7,500	2,185	44	39	39
294BHS	33' 3"	96"	134"	81"	5,805	710	8,000	2,195	44	39	39

The weights of certain options and/or option packages are not included in the UUV listed in the specification charts.



CONSTRUCTION

and craftsmanship

At Jayco, we've built a reputation for superior construction and quality craftsmanship. We pride ourselves on always using top-quality materials and innovative manufacturing techniques. That commitment has led to our latest construction advancement, the all-new exclusive Magnum Roof System, 50 percent stronger than other roofs in the industry, built to outlast everything but your memories.

ROOF CONSTRUCTION

- 1 4 1/2" crowned wood trusses:** Uses 2"x 2" vertical studs to maximize load capacity, while oversized nail plates provide a tighter design (2" x 3" solid, tapered trusses on SLX)
- 2 3/8" roof decking, screwed down at every seam:** More durable than typical stapled construction, provides fully walkable roof
- 3 Residential attic-style insulation:** Maintains interior temperatures while allowing for room to run wiring, reducing risky electrical shorts
- 4 One-piece, sidewall-wrapped Alpha Ply material:** Provides leak protection



WALL CONSTRUCTION

- 5 2" x 2" wooden studs:** Creates Jay Flight Swift's long-lasting framework
- 6 Hand-tucked and glued fiberglass insulation (R-7):** Prevents insulation from sagging over time (vs. blanket-insulation technique), while helping increase insulation value near studs
- 7 Extra-wide corner seals:** Prevents leaks on the corner molds, baggage and entrance doors and window seals

FLOOR CONSTRUCTION

- 8 Wall-to-wall vinyl flooring:** Wipes up easily, a perfect fit for families
- 9 5/8" decking on 2" x 3" wooden joists:** Creates a solid foundation
- 10 Fiberglass insulation (R-7):** Maintains interior temperatures
- 11 Full-width outriggers:** Supports wall weight with 4-foot spacing (vs. 8-foot spacing) and wall-to-wall, full-width design

OTHER FEATURES

- 12 Galvanized-steel wheel wells (select models):** Reduces heat loss through floor; prevents floor damage in case of a blown tire
- 13 Integrated A-frame:** Runs through frame, preventing hitch from buckling because it isn't tack welded
- 14 Innovative, aerodynamic front profile:** Eliminates angled profile, increasing towability



eco advantage™ www.jayco.com/ecoadvantage

THE JAYCO ECOADVANTAGE IS OUR COMPANY'S COMMITMENT TO PROTECTING THE ENVIRONMENT. Scan this QR code with your smartphone to watch a video about our efforts and the impact we're having on our world.

SWIFT SLX *towability*

Jay Flight Swift SLX is built for the ultimate towing experience thanks to innovative design.

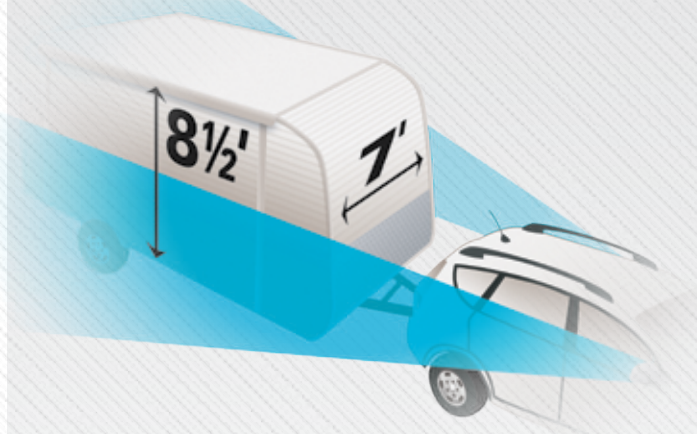

7-FEET WIDE The view from behind is just as nice. Built at 7-feet wide the Swift SLX is easy to see around when towing.

8 1/2-FEET TALL Quit paying to store your RV. Less than 8 1/2-feet tall, SLX can fit into most residential garages.

2,285-2,740 POUNDS Super towable, Jay Flight Swift SLX is easy on gas mileage.



SIDE-MOUNTED AIR CONDITIONER

Eliminate drag while increasing towability thanks to a standard wall-mounted air conditioner.

JAY FLIGHT SWIFT *features*

Jay Flight Swift comes with a host of standard features not typically found at this price.



PLEATED SHADES Pleated night shades, more durable than metal blinds, are designed to hold up to years of use.

EASY SETUP Four stabilizer jacks create a more balanced RV (standard on 267BHS, part of the Convenience Package on 198RD and 264BH).

METAL ALLOY FITTINGS Say goodbye to leaky faucets, the most warrantied item in a typical RV, thanks to Swift's metal alloy fittings.



THE **Jayco**[®] family STORY

THE JAYCO STORY BEGAN IN 1968 WITH OUR FAMILY—THE BONTRAGERS. Lloyd Bontrager created an innovative, easy-to-use lifter system that led to a better fold-down camper. Loaded with more conveniences, he believed his camper would bring families closer together.

Since then, the Jayco family has grown. From our factory to our front office, from our salespeople to our suppliers, our family bond is four decades strong with the support of more than 300 Jayco dealers.

Together, we're helping make new family stories. **YOUR FAMILY STORY.**

welcome to the Jayco family



Establishing a solid relationship with your local Jayco dealer is a key component in the enjoyment of your new Jayco. By purchasing from a local dealer, you will have a convenient location for sales, parts and service support. We hope you enjoy working with them as much as we do.



Jayco proudly sponsors Tread Lightly!, a nonprofit organization whose mission is to empower generations to enjoy the outdoors responsibly through education and restoration.

Unloaded Vehicle Weight (UWV): Sometimes referred to as "Dry Weight," UWV means the typical weight of this trailer as built at the factory. The UWV, as used in product literature and other promotional materials, does not include cargo, fresh water, propane, options or dealer-installed accessories.

Gross Vehicle Weight Rating (GVWR): GVWR means the maximum permissible weight of the trailer, including the UWV plus passengers, personal items, all cargo, fluids, options, and dealer-installed accessories. The GVWR is equal to or greater than the sum of the UWV and the CCC.



From RV insurance to extended warranties, JayPlus has it covered. Ask your Jayco dealer about our exclusive JayPlus program today.

Cargo Carrying Capacity (CCC): CCC means the maximum weight of all passengers, personal items, food, fresh water, propane, tools, other cargo and dealer-installed accessories that can be carried by the trailer. CCC is equal to or less than GVWR minus UWV. The addition of options will decrease the CCC.

Hitch Weight (HW): The hitch weight, as used in product literature and other promotional materials, does not include cargo, fresh water, propane gas, options or dealer-installed accessories. The addition of these types of items will either add to or subtract from the stated hitch weight.



Travel worry-free with Jayco's Customer First Roadside Assistance program, yours at no cost during your first year of ownership. This program is offered through Coach-Net, the largest RV emergency road service in the country, and gives you immediate access to dependable roadside assistance and support services with a simple phone call.



As a Jayco owner, you can be part of the Jayco Jafari International Travel Club. Ask your dealer about the Jafari "flight" in your area, write Jayco or visit our website.

It is important for your safety and enjoyment that your tow vehicle be adequately sized and equipped to tow and handle the GVWR of the RV you select. Review weights and rating of your tow vehicle and consult a competent advisor for questions or advice. Whether you are new to RVing or a veteran, get a feel for the performance of your tow vehicle before heading out on the roadways. When you tow an RV, you must drive differently than when you drive a single vehicle. Practice hooking up, driving, backing up and braking in a safe environment or seek out professional instruction. Jayco affixes a weight label to each RV which lists weight information for that vehicle. See specifications chart inside.

Jayco, Inc., P.O. Box 460, Middlebury, IN 46540, www.jayco.com 

See dealer for further information and prices. All information in this brochure is the latest available at the time of publication approval. Jayco reserves the right to make changes and to discontinue models without notice or obligation. Photos in this brochure may show optional equipment and props for photography purposes. RVs built for sale in Canada may differ to conform to Canadian codes. ©2012 Jayco, Inc. 13-JFSW-PL 1212-30K Printed in U.S.A.