

PINNACLE

LUXURY FIFTH WHEELS BY JAYCO

PINNACLE



built for
LUXURY LIVING



Jayco

PINNACLE® LUXURY FIFTH WHEELS BY JAYCO®



the pinnacle of
AFFORDABLE
luxury



PINNACLE 36KPTS | PRALINE



PINNACLE 36KPTS | PRALINE



YOU WANT PEACE OF MIND

That's why we offer our exclusive 2-year Co-Pilot Warranty, the industry's best and most comprehensive warranty program.

A *revolution* IN THE RV INDUSTRY,

the Jayco Pinnacle is the ultimate luxury package.

Changing the way the world looks at fifth wheels—
and luxury—Pinnacle is the culmination of exclusive
comfort and stunning design.

STUNNING GRAPHICS MEET *exterior convenience*

THE *culinary dream* KITCHEN

Blending form and function, Pinnacle's kitchen is a dream come true.

- 8 cu. ft. raised-panel Norcold refrigerator
 - Base cabinet toe kicks with rope accent lighting
 - Built-in hardwood wine rack*
 - Decorative kitchen backsplash
 - Flush-mounted oven with range top and cover
 - Mullion-style cabinet door with accent glass
 - 30" over-the-range microwave
 - Over-the-island pendant lighting, ceiling feature
 - Pull-out kitchen faucet
 - Pull-out style pantry with cutting board*
 - Full-height pantry with adjustable shelves
 - Residential-grade, high-gloss LG counters
 - Residential multi-tiered cabinet design
 - Sliding trash receptacle storage cabinet*
 - Stonecast kitchen sink with covers
 - Whole coach water filtration system
 - ExpansiView dinette windows
- * Available on select models

THE *tranquility* BEDROOM SUITE

Leave your cares at the private door of your new Tranquility Bedroom Suite.

- 72" x 80" Cloud Ten king-sized mattress
- Aromatic cedar-lined front wardrobe closet
- Bedroom dresser cabinet toe kicks
- Bedroom satellite receiver prep
- Decorative dresser lamp
- Decorative pillows and bedding package
- Full-trunk, under-bed storage
- Full-width dresser drawers
- Hardwood headboard
- Hardwood media center cabinet
- His and her nightstands and reading lights
- Private bathroom entrance (select models)
- Privacy glass in bedroom door (select models)
- Washer/dryer prep cabinet with shelving unit



WITH YOUR PURCHASE

Every Jayco RV undergoes rigorous quality control testing before it leaves the factory, so you can be confident your new Jayco will continue to provide the ultimate in reliability for years to come.

For a copy of our 2-year Co-Pilot limited warranty with full terms and conditions, ask your local Jayco dealer.



TO LEARN MORE ABOUT
OUR QUALITY CONTROL
TESTING, SCAN HERE WITH
YOUR SMARTPHONE.



STANDARD GRAPHICS



OPTIONAL PREMIUM PAINT

THE LUXURY PACKAGE

Jayco Pinnacle seizes every opportunity to combine form and function. Take a peek. You'll discover Jayco anticipates your every need—in every corner, every cabinet and every room. Packed with a host of convenient surprises, Pinnacle delivers luxury.





PINNACLE 36REQS | PECAN



PINNACLE 36REQS | PECAN



PINNACLE 36REQS | PECAN



PINNACLE 36REQS | PECAN



EXTERIOR CONVENIENCE

Pinnacle delivers convenient details, like a fully accessible sliding propane tray with double propane bottles, the Stor-Galore basement storage with heated and enclosed Uni-Dock utility center, and a hand-held remote for easy operation of the RV's electric rear jacks, enclosed slideout system and much more.

jayco CONSTRUCTION



CLIMATE SHIELD

ULTIMATE WEATHER PROTECTION

Extend your camping season. Offering weather protection against extreme temperatures (as low as 0° F or as high as 100° F), the Climate Shield combines the industry's most-protected underbelly with the class's highest-BTU output furnace. The enclosed underbelly, tucked and foamed inside the I-beam rails, features blown heat for the ultimate four-season camping experience.

The Climate Shield features the following R-values.

VALUE	UNIT AREA	TYPE OF INSULATION
R-8	All vertical walls	R-8 block foam
R-11	Behind front and rear caps	R-11 insulation
R-21	Roof	R-21 block foam
R-22	Main floor	R-7 insulation + R-14 foil
R-14	Slide floor	R-14 foil
R-22	Bedroom floor	R-7 insulation + R-14 foil
R-14	Inside open pinbox	R-14 foil
R-14	Enclosed drop-frame overhang	R-14 foil

* Pinnacle was tested in 0° F (-17° C) weather over an extended period of time in a controlled environment and all functions of the coach were fully operational. Testing cannot account for natural elements, such as wind or moisture. In actual use, unit may not perform as well. In addition, outside components are subject to freezing and require steps to properly insulate. Jayco's warranty does not cover damage caused by freezing.

WALL CONSTRUCTION

- 1 Vacuum-bonded layers
- 2 Gel-360 fiberglass exterior
- 3 Welded aluminum frames with metal backers
- 4 Eurostyle front and rear caps

FLOOR CONSTRUCTION

- 5 5/8" tongue-and-groove plywood deck on 2"x 3" wooden floor joists
- 6 Reflective foil insulation
- 7 Poly Flex covering and an enclosed, heated underbelly

ROOF CONSTRUCTION

- 8 Vacuum-bonded layers
- 9 1/4" plywood decking on 5" arched aluminum trusses
- 10 Block-foam insulation (R-21)
- 11 Seamless rubber roof

STANDARDS AND OPTIONS

STANDARD EXTERIOR EQUIPMENT

TuffShell vacuum-bonded laminated sidewalls, slideout walls and roof
One-piece seamless roof covering
Chocolate, aluminum, radius roof transition
10" I-Class cambered structural steel
I-beam frame
16" radial tires
Nev-R-Adjust brakes
E-Z Lube axles
MOR/ryde LRE4000 suspension system
Completely enclosed and protected slideout mechanisms
30" x 72" entry door with oversized window
Exterior entertainment center with 32" LCD TV (38FLFS)
Exterior marine-grade speakers (2)
Front awning arm convenience outlet
G20 dark-tinted, safety-glass windows
ExpansioView opera-style, floor-to-ceiling dining area windows
Enclosed, protected basement drop frame
Cable TV and outlet in basement
Dual battery compartment with disconnect
Wide-stance front landing gear
Stor-Galore pass-through basement storage with slam latches and strut assist
Sliding propane tray with 30-lb. propane bottles
Heated, enclosed Uni-Dock utility center
50-amp power service with detachable cord
35,000-BTU furnace (minimum)
75-gal. fresh water tank
85-gal. gray tank capacity (minimum)
50-gal. black tank capacity (minimum)
Cable/satellite prep
Digital TV antenna
Outside grill prep
Electric rear stabilizer jacks
LED rear taillights
Undermounted spare tire
Frame prepped for bike rack/cargo tray
Roof ladder

STANDARD INTERIOR EQUIPMENT

Oversized window and shade at entry door
Concord Cherry hardwood cabinet construction with hidden door hinges
Pull-out lower pantry and trash receptacle storage (most models)
Half-barrel hidden storage cabinet (36REQS, 35LKTS, 36RSQS)
Steel ball bearing drawer guides, 75-lb. capacity with full extension
Large, split, undermounted Stonecast kitchen sink with covers
Residential-grade, pull-out kitchen faucet
Water heater bypass
8 cu. ft. refrigerator with raised-panel hardwood front
Flushmount, oversized 21" oven with 3-burner cooktop and range cover
30" residential-grade microwave
Diamondflor deluxe linoleum flooring
Central vacuum with floor inlet
Toe-kick kitchen lighting
90-amp power center with Charge Wizard
Command center for switches with 12V cell phone charger
Key fob remote for slideouts, patio awning, power jacks (n/a with levelers), patio light
Closeable and directional A/C vents
Prep for 2nd ducted A/C
Ceiling fan and light
Hardwood kitchen ceiling feature (most models)
Halogen ceiling lights throughout
6' 9" tall living area slideouts
Pleated day/night shades (main living area)

32" LCD TV in bedroom (38FLFS)

Air mattress hide-a-bed sofa
Glass shower enclosure
Vessel bathroom sink with high-rise faucet
Porcelain bath stool with foot flush
Robe hooks in bath
His/hers individual bedroom reading lights
Hardwood headboard
Deluxe bedding package with pillows
Full-trunk, under-bed storage
Walk-in style front closet with dual hanging rods and cedar lining
Mullion-style front wardrobe doors
Washer/dryer prep
Oversized dresser drawers
Hardwood bedroom media center cabinet

CUSTOMER VALUE PACKAGE (MANDATORY)

Extendable main entrance grab handle
Large patio scare lights (2)
Electric patio awning with LED lighting
Bath power vent
15,000-BTU A/C with Chillgrille
Multi-Media Premium Sound System
AM/FM/CD/DVD/MP3 player with toggle switch for outside speakers
72" x 80" Cloud Ten deluxe pillowtop mattress
Under-bed floor safe
Bath skylight
12-gal. quick-recovery gas/electric
DSI water heater
Canister-style, in-line water purifier

SUMMIT PACKAGE (MANDATORY)

Aluminum rims
Ultra high-gloss, gel-coat exterior shell, baggage and entry doors
Concord Cherry, Craftsman-style, raised-panel cabinetry with mullion-accent windows
Concord Cherry hardwood slide fascias
LG brand, high-gloss, solid-surface kitchen countertops
Craftsman-style, free-standing table and 4 chairs
40" LCD HDTV (60" in 38FLFS)
Rocker/glider recliner chairs (n/a 38FLFS)

OPTIONS

Customer Value Package with 15,000-BTU A/C and heat pump
Premium Paint Package
Tinted thermal-pane, safety-glass windows
Slideout awning
2nd patio awning (n/a 31RLTS, 36RETS, 38FLFS)
4-point auto level system
MOR/ryde pin box
Reese Revolution pin box, allows for 90-degree turn on 6' bed
Generator prep
5,500-watt gasoline generator (includes prep)
Bike rack/cargo tray system
Outside grill
Satellite Kit: Dish, tripod, 20' cable and hand-held satellite locator
12 cu. ft. refrigerator (n/a 31RLTS)
30" residential-grade convection microwave with oven
Kitchen power vent (n/a 36KPTS)
Ledgestone fireplace (36RETS, 36REQS) (standard in 38FLFS)
Electric fireplace (n/a 38FLFS)
Step ladder desk chair
Select Comfort Sleep Number mattress
In/out 22" LCD HDTV with integrated DVD player in bedroom (n/a 38FLFS)
2nd A/C in bedroom (13,500-BTU ducted)

eco advantage™



THE JAYCO ECOADVANTAGE IS OUR COMPANY'S COMMITMENT TO PROTECTING THE ENVIRONMENT. Scan this QR code with your smartphone to watch a video about our efforts and the impact we're having on our world.
www.jayco.com/ecoadvantage

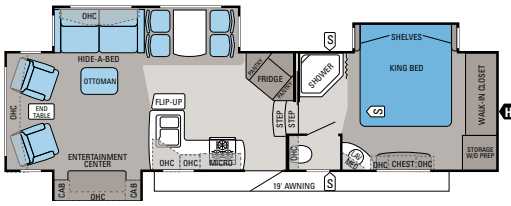

Pinnacle | 31RLTS

Ext. Length: 34' 9" Ext. Height: 155" Unloaded Wt. (lbs.): 10,035 Sleeps: 4

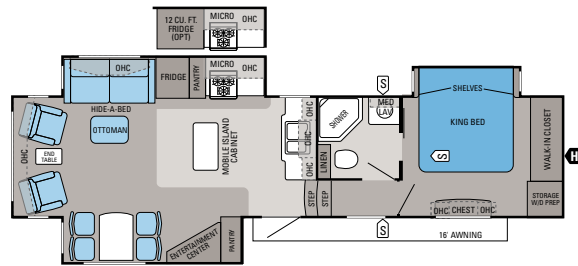

Pinnacle | 34RLTS

Ext. Length: 38' 3" Ext. Height: 155" Unloaded Wt. (lbs.): 10,935 Sleeps: 4

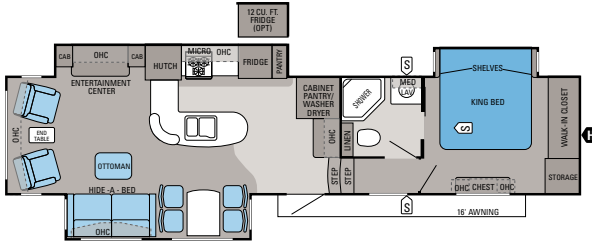

Pinnacle | 35LKTS

Ext. Length: 40' 4" Ext. Height: 155" Unloaded Wt. (lbs.): 11,565 Sleeps: 4

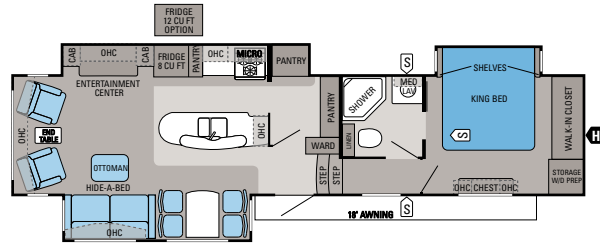

Pinnacle | 36KPTS

Ext. Length: 39' 9" Ext. Height: 158" Unloaded Wt. (lbs.): 11,560 Sleeps: 4

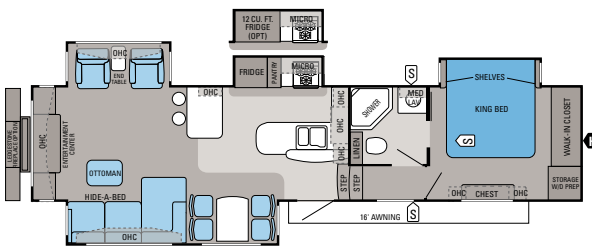

Pinnacle | 36REQS

Ext. Length: 40' 1" Ext. Height: 158" Unloaded Wt. (lbs.): 11,700 Sleeps: 4

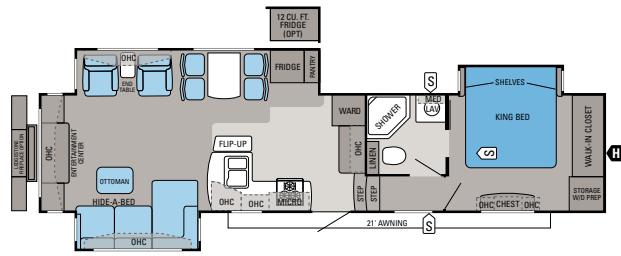

Pinnacle | 36RETS

Ext. Length: 39' 11" Ext. Height: 155" Unloaded Wt. (lbs.): 11,420 Sleeps: 4

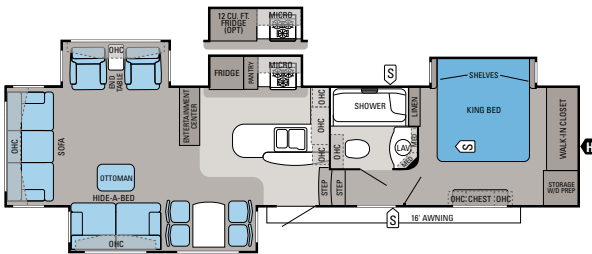

Pinnacle | 36RSQS

Ext. Length: 39' 9" Ext. Height: 155" Unloaded Wt. (lbs.): 11,705 Sleeps: 4

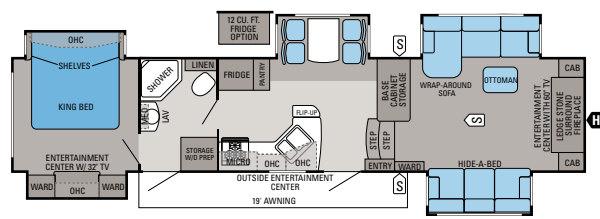

Pinnacle | 38FLFS

Ext. Length: 41' 11" Ext. Height: 155" Unloaded Wt. (lbs.): 12,015 Sleeps: 4

SPECIFICATIONS

FLOORPLAN	EXT. LENGTH	EXT. WIDTH	EXTERIOR HEIGHT (WITH A/C)	EXT. HEIGHT (WITH OPT. BEDROOM A/C)	INT. HEIGHT	UNLOADED VEHICLE WEIGHT (LBS.)	DRY HITCH WEIGHT (LBS.)	GROSS VEHICLE WEIGHT RATING (LBS.)	CARGO CARRYING CAPACITY (LBS.)	FRESH WATER CAPACITY (WITH WATER HEATER) (GAL.)	GRAY WASTEWATER CAPACITY (GAL.)	TOILET/BLACK WASTEWATER CAPACITY (GAL.)
31RLTS	34' 9"	96"	155"	160"	81"	10,035	2,200	14,950	4,915	87	87	50
34RLTS	38' 3"	96"	155"	162"	81"	10,935	2,530	14,950	4,015	87	85	50
35LKTS	40' 4"	96"	155"	162"	81"	11,565	2,600	15,950	4,385	87	87	50
36KPTS	39' 9"	96"	158"	161"	81"	11,560	2,485	15,950	4,390	87	87	50
36REQS	40' 1"	96"	158"	161"	81"	11,700	2,670	15,950	4,250	87	85	50
36RETS	39' 11"	96"	155"	162"	81"	11,420	2,490	15,950	4,530	87	85	50
36RSQS	39' 9"	96"	155"	160"	81"	11,705	2,750	15,950	4,245	87	87	50
38FLFS	41' 11"	96"	155"	159"	81"	12,015	2,466	15,950	3,935	87	85	50

The weights of certain options and/or option packages are not included in the UWW listed in the specification charts.

INTERIOR DÉCOR CHOICES

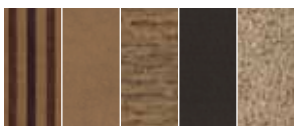

CARAMEL



PECAN

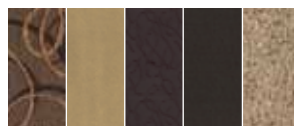

PRALINE

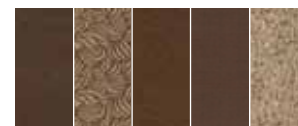

TOFFEE



WOOD



THE *Jayco*[®] family STORY

THE JAYCO STORY BEGAN IN 1968 WITH OUR FAMILY—THE BONTRAGERS. Lloyd Bontrager created an innovative, easy-to-use lifter system that led to a better fold-down camper. Loaded with more conveniences, he believed his camper would bring families closer together.

Since then, the Jayco family has grown. From our factory to our front office, from our salespeople to our suppliers, our family bond is four decades strong with the support of more than 300 Jayco dealers.

Together, we're helping make new family stories. **YOUR FAMILY STORY.**

welcome to the Jayco family



Establishing a solid relationship with your local Jayco dealer is a key component in the enjoyment of your new Jayco. By purchasing from a local dealer, you will have a convenient location for sales, parts and service support. We hope you enjoy working with them as much as we do.



Jayco proudly sponsors Tread Lightly!, a nonprofit organization whose mission is to empower generations to enjoy the outdoors responsibly through education and restoration.

Unloaded Vehicle Weight (UWW): Sometimes referred to as "Dry Weight," UWW means the typical weight of this trailer as built at the factory. The UWW, as used in product literature and other promotional materials, does not include cargo, fresh water, propane, options or dealer-installed accessories.

Gross Vehicle Weight Rating (GVWR): GVWR means the maximum permissible weight of the trailer, including the UWW plus passengers, personal items, all cargo, fluids, options, and dealer-installed accessories. The GVWR is equal to or greater than the sum of the UWW and the CCC.



From RV insurance to extended warranties, JayPlus has it covered. Ask your Jayco dealer about our exclusive JayPlus program today.

Cargo Carrying Capacity (CCC): CCC means the maximum weight of all passengers, personal items, food, fresh water, propane, tools, other cargo and dealer-installed accessories that can be carried by the trailer. CCC is equal to or less than GVWR minus UWW. The addition of options will decrease the CCC.

Hitch Weight (HW): The hitch weight, as used in product literature and other promotional materials, does not include cargo, fresh water, propane gas, options or dealer-installed accessories. The addition of these types of items will either add to or subtract from the stated hitch weight.



Travel worry-free with Jayco's Customer First Roadside Assistance program, yours at no cost during your first year of ownership. This program is offered through Coach-Net, the largest RV emergency road service in the country, and gives you immediate access to dependable roadside assistance and support services with a simple phone call.



As a Jayco owner, you can be part of the Jayco Jafari International Travel Club. Ask your dealer about the Jafari "flight" in your area, write Jayco or visit our website.

It is important for your safety and enjoyment that your tow vehicle be adequately sized and equipped to tow and handle the GVWR of the RV you select. Review weights and rating of your tow vehicle and consult a competent advisor for questions or advice. Whether you are new to RVing or a veteran, get a feel for the performance of your tow vehicle before heading out on the roadways. When you tow an RV, you must drive differently than when you drive a single vehicle. Practice hooking up, driving, backing up and braking in a safe environment or seek out professional instruction. Jayco affixes a weight label to each RV which lists weight information for that vehicle. See specifications chart inside.

Jayco, Inc., P.O. Box 460, Middlebury, IN 46540, www.jayco.com 

See dealer for further information and prices. All information in this brochure is the latest available at the time of publication approval. Jayco reserves the right to make changes and to discontinue models without notice or obligation. Photos in this brochure may show optional equipment and props for photography purposes. RVs built for sale in Canada may differ to conform to Canadian codes. ©2013 Jayco, Inc. 13-PNCL-PL 0113-20K. Printed in U.S.A.