



2015 MELBOURNE

CLASS C MOTORHOMES BY JAYCO



MELBOURNE

NIMBLE COMFORT FOR EVERY ADVENTURE

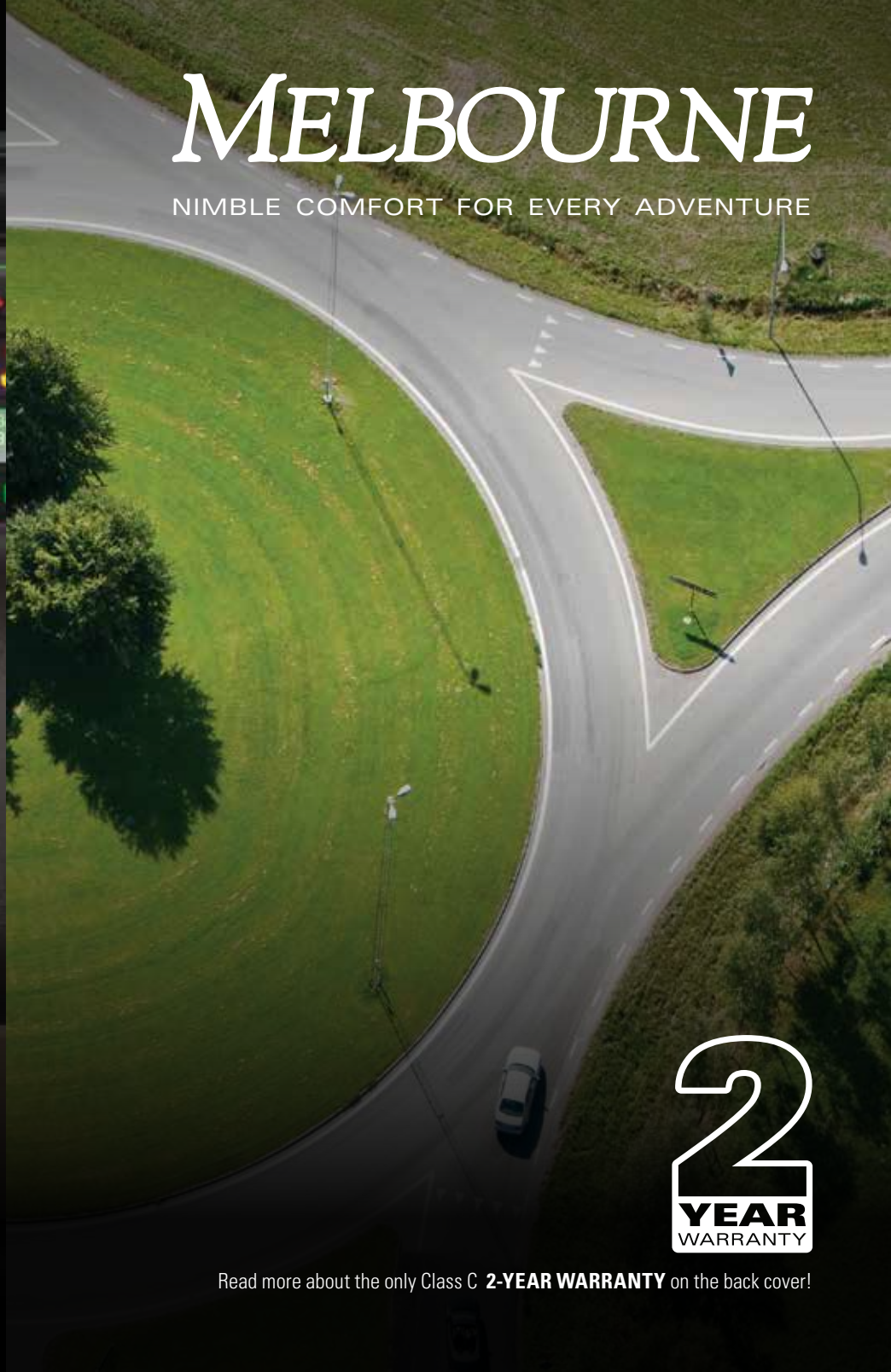

2
YEAR
WARRANTY

Read more about the only Class C **2-YEAR WARRANTY** on the back cover!

MELBOURNE® CLASS C MOTORHOMES BY JAYCO®

SEEK OUT THE FUN

Introducing the 2015 Jayco Melbourne, a Class C motorhome that delivers a nimble ride with aerodynamic curved sidewalls.

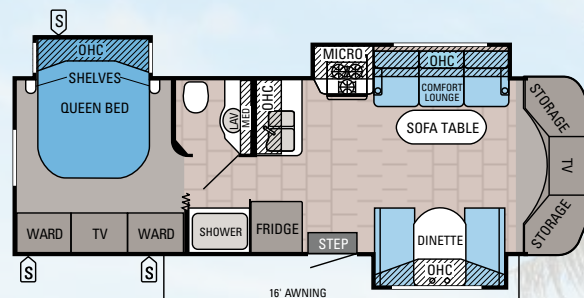

Melbourne 29D



JRIDE

HANDS DOWN, THE BEST RIDE.

Read more about our exclusive Ride and Handling package at jride.jayco.com.



SILVER SPARKLE PREMIUM PAINT



SUNDANCE GOLD PREMIUM PAINT



STANDARDS AND OPTIONS

CUSTOMER VALUE PACKAGE

JRide Package: Bilstein shocks, stabilizer bar, Hellwig helper springs and rubber isolation body mounts
Hydraulic leveling jacks
Touch-screen premium in-dash sound system with CD/DVD, back-up camera monitor and built-in GPS
Back-up and side-view cameras/monitor
Deluxe, remote-controlled, heated, side-view mirrors
Frameless windows
12V electric awning with LED lights
Portable, outside gas grill
Tankless water heater
400-watt inverter
15,000-BTU air conditioner with heat pump
Pillowtop Denver Mattress

STANDARD EXTERIOR EQUIPMENT

TuffShell vacuum-bonded laminated floor and sidewalls
Bead-foam insulation (R-23 roof, R-9 floor, R-6 walls)
One-piece fiberglass roof
Front and rear fiberglass caps
Fiberglass running boards
High-gloss, gel-coated sidewalls
3M paint protection film
Electric-powered entrance step
Radius-cornered entrance door with screen
Keyless entry, touch-pad locking system
Slideout topper awnings
Exterior speakers, high-output, marine-grade (2)
Lockable exterior storage compartments
Onan 4,000-watt MicroQuiet generator with auto-changeover
Dual-sliding battery tray
House battery
Illuminated battery disconnect switch
12V electrical system with 110V, 60-amp power converter
30-amp power cord
120V G.F.C.I.-protected exterior receptacle
41-lb. propane tank
Black holding tank sprayer
Sewer hose compartment with door

Hookup for city water
12V demand water pump
Water purification system
Heated holding tanks (12V pads)
Outside shower
Roof ladder

STANDARD INTERIOR EQUIPMENT

78" ceiling height with padded vinyl ceiling
Washington Glazed raised-panel cabinetry with deluxe hidden hinges
Ball bearing drawer guides, 75-lb. capacity
One-piece, solid-surface, high-gloss countertop with integrated deep bowls with (2) sink covers
8 cu. ft. flush-mount refrigerator
Microwave drawer with 3-burner cooktop and range hood
Dream Dinette mechanism, raises and lowers dinette tabletop
31,000-BTU auto-ignition furnace with wall thermostat
Interior command center
Cable TV hookup with RG-6 coax
Digital antenna with signal booster
Prep for satellite dish
Electric leatherette comfort sofa
Entertainment center with 32" digital LED HDTV
Laminate-tile vinyl flooring
ABS shower with one-piece surround
Porcelain stool with foot flush
Residential medicine cabinet with mirror
Skylight in shower with light
Powered attic fan
Queen-sized bed and bedspread
22" LED HDTV in bedroom

STANDARD DRIVING EQUIPMENT

Ford E-450 chassis
Triton 6.8L EFI V-10 305 HP engine with 420 lbs./ft. torque
5-speed automatic TorqShift series transmission with overdrive
120-amp alternator
55-gal. fuel tank
5,000-lb. rated hitch with 7-way plug

Auxiliary start switch
Power anti-lock brakes with power steering
Air conditioner and cruise control
Tilt steering wheel
Optima leather driver seat with 6-way power
Optima leather passenger seat
Power windows and door locks
Third brake light
Wheel liners

OPTIONS

Customer Value Package
Aluminum rims
Premium Paint Package: Silver Sparkle
Premium Paint Package: Sundance Gold

PEARL INTERIOR DÉCOR CHOICE

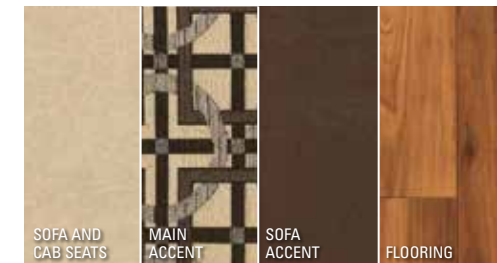

ADOBE INTERIOR DÉCOR CHOICE

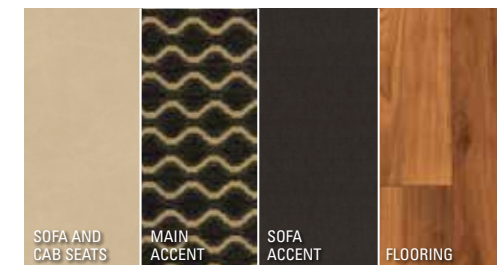

SPECIFICATIONS

MODELS		DIMENSIONS				WEIGHTS (LBS.)		DRIVING FEATURES		FURNACE	TANKS (GALS.)		
MODEL		EXT. LENGTH	EXT. WIDTH	EXT. HEIGHT (WITH A/C)	INTERIOR HEIGHT	GROSS VEHICLE WEIGHT RATING	GROSS COMBINED WEIGHT RATING	ENGINE/SIZE	WHEEL BASE	AUTO-IGNITION (BTUS)	FRESH	GRAY	BLACK
29D		31' 7"	96"	127"	78"	14,500	22,000	6.8L TRITON EFI V-10	212"	31M	31	34	32

Gross Vehicle Weight Rating (GVWR): The maximum permissible weight of the motorhome, including the Unloaded Vehicle Weight (UVW) plus passengers, personal items, all cargo, fluids, options and dealer-installed accessories. The GVWR is equal to or greater than the sum of the UVW and the Cargo Carrying Capacity.

Gross Combined Weight Rating (GCWR): The maximum allowable combined weight of the motorhome used as a tow vehicle and the attached towed vehicle.

It is important for your safety and enjoyment that you are aware of the weights and tow ratings of the RV you select. Consult a competent advisor for questions or advice. Whether you are new to RVing or a veteran, get a feel for the performance of your RV before heading out on the roadways. When you tow a vehicle with your RV, you must drive differently than when you drive a single vehicle. Practice hooking up, driving, backing up and braking in a safe environment or seek out professional instruction. Jayco affixes a weight label to each RV which lists weight information for that vehicle. Refer to that label to verify the vehicle will meet your requirements. See chart above.

EXTERIOR CHOICES

2
YEAR
WARRANTY



Your quality time starts with peace of mind.

For 45 years, Jayco has helped generation after generation create family memories—good, old-fashioned family fun built around a campfire with a Jayco RV nearby. In all of that time, we learned something important—quality time starts with peace of mind, which is why Jayco offers the only 2-year limited warranty in Class C motorhomes.*

Nobody offers a better warranty than Jayco.

*For a copy of our limited warranty with full terms and conditions, please contact your Jayco dealer.



Generations of family fun.

YOUR LOCAL DEALER

300 JAYCO DEALERS

The fun starts with your local dealer

From the sales experience to service after the sale, we consider our dealers to be an important part of the Jayco family. Establishing a solid relationship with your local Jayco dealer is a key component in the enjoyment of your new Jayco. By purchasing from a local dealer, you will have a convenient location for sales, parts and service support. We hope you consider them a part of your camping family.

5-YEARS FREE Roadside Assistance

Travel worry-free with Ford's Roadside Assistance program, yours at no cost during the first five years of ownership. This program is offered through Coach-Net, the country's largest RV emergency road service, and gives you immediate access to assistance.

Jayco, Inc., P.O. Box 460, Middlebury, IN 46540

See dealer for further information and prices. All information in this brochure is the latest available at the time of publication approval. Jayco reserves the right to make changes and to discontinue models without notice or obligation. Photos in this brochure may show optional equipment and props for photography purposes. RVs built for sale in Canada may differ to conform to Canadian codes. ©2015 Jayco, Inc. 15-MELB-PL 0115-10K Printed in U.S.A.



www.jayco.com