



MELBOURNE™

2016

2016 MELBOURNE CLASS C MOTORHOMES



EXPLORE THE WORLD
#LETSJAYCO



HANDS DOWN,
THE BEST RIDE.

2
YEAR
WARRANTY



Full cab-over bunk with 750-pound capacity

MELBOURNE

Built on a Mercedes 3500 chassis with a V-6 turbo 188 HP diesel engine, the compact Melbourne makes it easy to hit the road—without sacrificing comfort. A smart, space-saving layout offers a roomy feel.



Grand Tan interior décor



Grand Tan interior décor

INTERIOR DÉCOR

1. GRAND TAN
2. GLORIOUS GREY

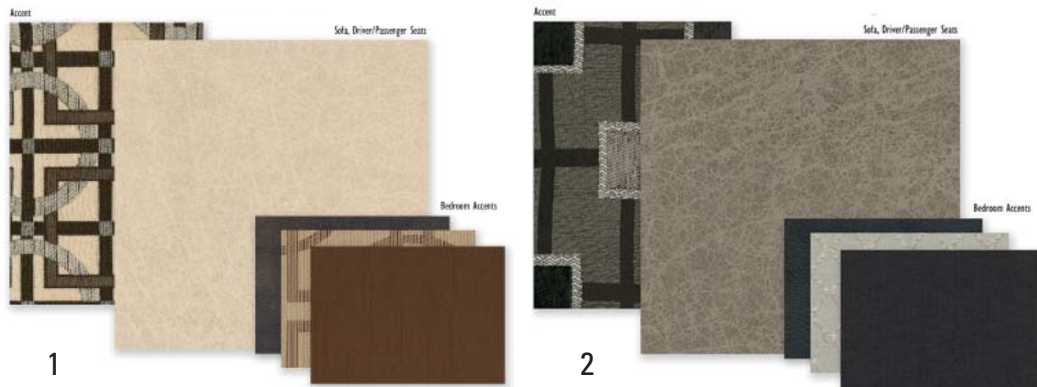

FLOORPLANS

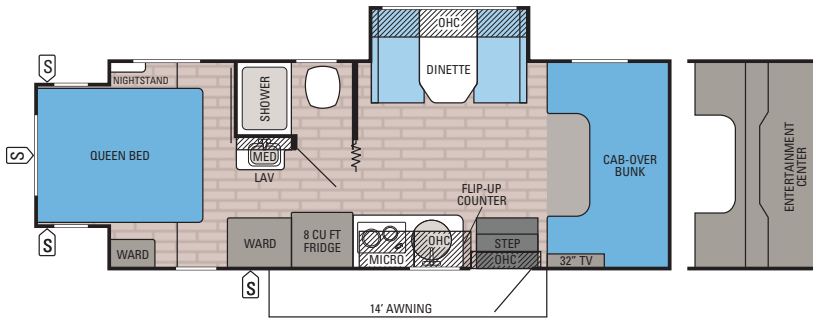

24K — Sleeps: 4-6

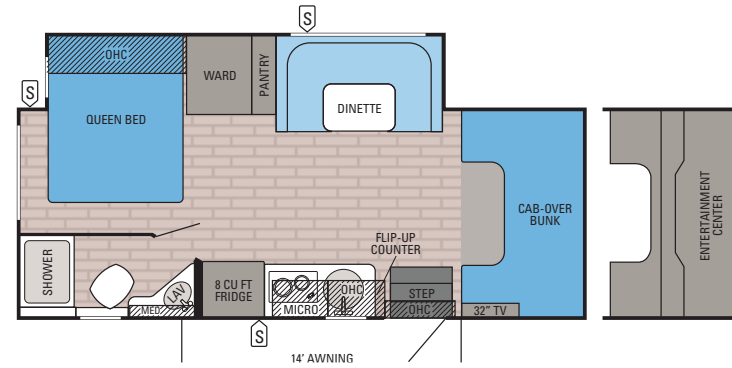

24L — Sleeps: 4-6

STANDARDS AND OPTIONS

CUSTOMER VALUE PACKAGE

- Back-up camera with monitor
- Black tank flush
- Electric patio awning w/LED light strip
- Frameless windows
- Keyless entry
- Remote control and heated mirrors
- Stabilizer jacks
- Swivel driver and passenger seats
- Touch-screen, in-dash stereo with built-in CD/DVD, MP3 and input jack

STANDARD EXTERIOR EQUIPMENT

- Soft Sand graphics package
- White fiberglass walls
- White baggage doors with slam latch
- One-piece fiberglass front cap

- Fiberglass running boards
- TPO laminated roof
- Electric-powered, single-entrance step
- Pass-through storage compartments (24K)
- Slideout battery tray with house battery
- 12V demand water pump
- 30-amp detachable electrical service cord
- 60-amp 12V converter
- Heated holding tanks (12V pads)
- 4" tube bumper with sewer hose storage
- Roof ladder (based on floorplan)
- 3.6 KW Onan LP generator
- 13,500-BTU air conditioner
- Exterior grill quick connect
- Black tank Sprayer
- Chrome simulators
- 110V GFI exterior recepacles

STANDARD DRIVING EQUIPMENT

- Mercedes 3500 170" wheelbase 11,030-lb. GVWR chassis
- V-6 Turbo 188 HP diesel engine with electronic fuel injection and 325-lb. torque
- 5-speed automatic transmission

- 220-amp alternator
- 12V chassis battery
- Front and rear disc, 4-wheel anti-lock brakes
- 7-pin trailer hitch plug
- 9.8-gal. propane tank
- 5,000-lb. rear hitch receiver with dual connector
- Third brake light

STANDARD INTERIOR EQUIPMENT

- 81" interior ceiling height
- High-intensity recessed LED ceiling lights
- Honey cherry cabinetry and doors with oil-rubbed bronze hardware
- Ball bearing drawer guides
- Water filtration system
- Auto-ignition 30,000-BTU ducted furnace
- 6-gallon gas/electric water heater
- Water heater bypass
- Satellite dish prep
- Cable TV hookup with RG6 coax
- Digital antenna with signal booster
- Battery disconnect
- Full Linoleum

- Slideout fascia
- Window valance
- Pleated blackout shades
- Cab area privacy curtain
- Wood grain applique around radio
- Removable cab mat
- Laminate kitchen countertops with round sink
- Wood Sink cover/cutting board
- Flip-up countertop extension
- Kitchen faucet with pull out sprayer
- Suburban black 2-burner drop-in cooktop with flush cover
- Convention Microwave
- 8-cubic foot, flush mount, double-door refrigerator
- 32" LED living room HDTV
- Fantastic fan in kitchen
- Dream dinette with booth dinettes (select models)
- U-shaped dinette with stow away pedestal legs (select models)
- 12V USB charging station in dinette area only
- Lap safety belts on living area seats
- Laminate lavatory countertop with rect sink
- Shower pan with surround
- Glass shower door
- Shower skylight
- Toilet with hand sprayer
- Bathroom electric roof vent
- Bedroom TV Prep
- Full cab-over bunk with 750-pound capacity
- Queen sized bed with bedspread

OPTIONS

- Canyon Red Graphics (no cost)
- Front entertainment center with 32" LED TV
- 3.2 KW Onan diesel generator
- Tattoo Blue paint package with Diamond Shield and aluminum rims
- White Lightning paint package with Diamond Shield and aluminum rims

MELBOURNE SPECIFICATIONS

| MODELS | DIMENSIONS | | | DRIVING FEAT. | TANKS (GALS.) | | | |
|--------|------------|-----------------|----------------|---------------|----------------------------|-----------------|------------|--|
| | FLOORPLAN | EXTERIOR LENGTH | EXTERIOR WIDTH | | EXTERIOR HEIGHT (WITH A/C) | INTERIOR HEIGHT | WHEEL BASE | FRESH WATER CAPACITY (INCLUDES WATER HEATER) |
| 24K | 24' 10" | 94" | 11' 5" | 81" | 170" | 43 | 32 | 32 |
| 24L | 24' 10" | 94" | 11' 5" | 81" | 170" | 43 | 32 | 32 |

It is important for your safety and enjoyment that you are aware of the weights and tow ratings of the RV you select. Consult a competent advisor for questions or advice. Whether you are new to RVing or a veteran, get a feel for the performance of your RV before heading out on the roadways. When you tow a vehicle with your RV, you must drive differently than when you drive a single vehicle. Practice hooking up, driving, backing up, and braking in a safe environment or seek out professional instruction. Jayco affixes a weight label to each RV which lists weight information for that vehicle. Refer to that label to verify the vehicle will meet your requirements. See specifications chart above.

Gross Vehicle Weight Rating (GVWR): The maximum permissible weight of the motorhome, including the Unloaded Vehicle Weight (UUVW) plus passengers, personal items, all cargo, fluids, options and dealer-installed accessories. The GVWR is equal to or greater than the sum of the UUVW and the Cargo Carrying Capacity.

Gross Combined Weight Rating (GCWR): The maximum allowable combined weight of the motorhome used as a tow vehicle and the attached towed vehicle.

STANDARD GRAPHICS SELECTIONS



SOFT SAND



CANYON RED

FULL-BODY PAINT OPTIONS

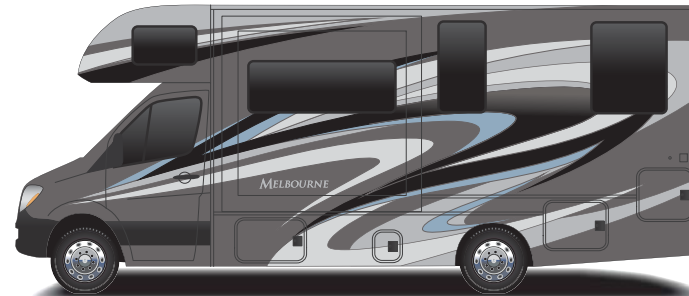

BLUE TATTOO

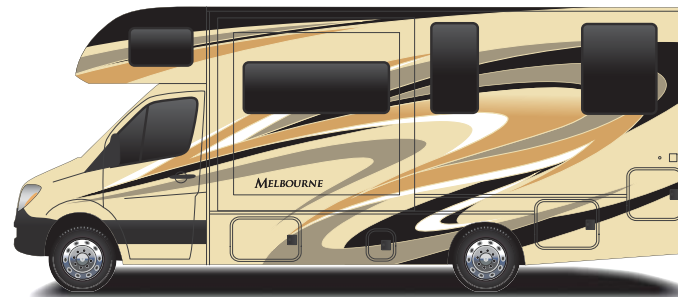

WHITE LIGHTNING

2
YEAR
WARRANTY

Our industry-leading bumper-to-bumper limited warranty lets you travel with confidence.

For a copy of our 2-year limited warranty with full terms and conditions, please contact your local Jayco dealer.

eco advantage™

Jayco's long-term commitment to generations of family fun

After four years of increased efforts to eliminate waste, conserve energy and increase recycling, we've come a long way in building RVs that are not only better for your family—but also better for the planet. **Learn more at Jayco.com/EcoAdvantage**

Follow Jayco



Jayco, Inc., P.O. Box 460, Middlebury, IN 46540, www.jayco.com See dealer for further information and prices. All information in this brochure is the latest available at the time of publication approval. Jayco reserves the right to make changes and to discontinue models without notice or obligation. Photos in this brochure may show optional equipment and props for photography purposes. RVs built for sale in Canada may differ to conform to Canadian codes. ©2015 Jayco, Inc. 2016 Jayco Literature - Melbourne.indd JM 10-15 Printed in U.S.A.

FREE

ROADSIDE
ASSISTANCE

Travel worry-free with Jayco's Customer First Roadside Assistance program, yours at no cost during the first year of ownership. This program is offered through Coach-Net™, the country's largest RV emergency road service, and gives you immediate access to assistance.

Meet your Jayco Dealer

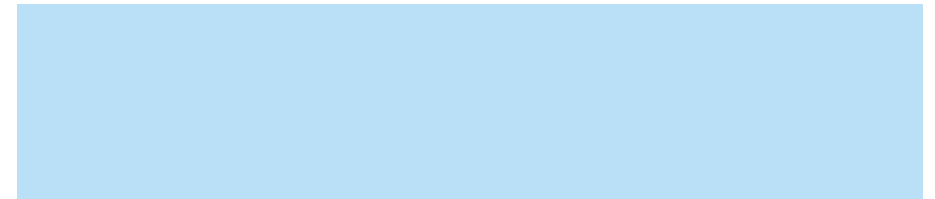

We work hard—so you can play hard. From finding the perfect Jayco for your family to providing flexible financing options and full-service support, we're here to help.